

South Carolina - Pursuant to a

Warrant from John Thomas Esq. Com. of Loc. dated the 30th Jan^y 1796 - I have admeas^d & laid out unto Solomon West a tract of One Hundred & Seventy Acres of land, Situate in Washington District & Pickensville County, on both sides a small branch of Sanders creek, & on a small branch of Langston's creek, & on waters of Reddy creek. Bounded to the N. by Isachonia Langston's Land, to the S. by Joseph Bridges's & John Langston's Land, to the W. by M^r. Young's Land - & hath such shape form & marks as the above Plat represents.

Surveyed the 4th day of Feb^y 1796 -
Recorded the 8th Feb^y 1796 -
John Young Jun^r - Deput^y



State of S^c Carolina Pursuant to a warrant from John Thomas Esq. Com. of Loc. dated 10th day of Jan^y 1796 I have admeasured and laid out unto Drury Maurice a tract of two hundred & fifty one acres of land, in Greenville County including Saluda River. Bounding N. E. on Jeffrey Hill's Land, S. W. & N. W. on Jonathan Stone's Land, S. E. on James Hope's Land, all other sides on vacant land, and hath such form and marks as the above Plat represents. Surveyed 13th Jan^y 1796. Recorded 7th Feb^y 1796. D. B. Arnold D.



South Carolina

Pursuant to a warrant

from John Thomas, Commissioner of Locations N. Carolina, dated the 6th day of February 1790. I have admeasured & laid out unto Henry Norman a tract of fifty four acres of land situate in Greenville County, on the south side of Branch creek. Waters of Branch river on branches of said creek, bounded by lines running S. E. by George Buffells, N. E. & S. E. by Lunsford Hutsons Land, N. E. by vacant land, & N. E. by Isaac Normans Land, and hath such shape, form & marks as the above Plat represents. Surveyed the 6th day of February 1790. Recorded the 16th Feb^y 1790. D. C. Isaac Norman

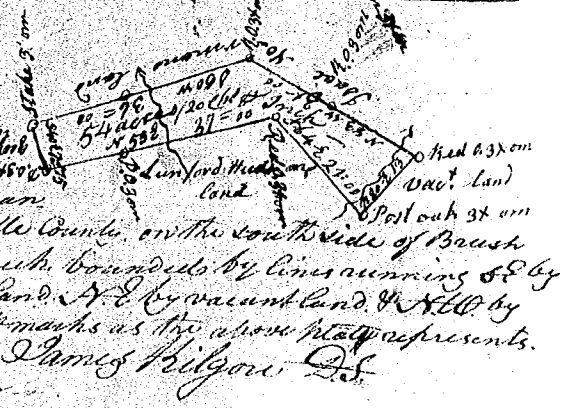

State of S^c Carolina Pursuant to a warrant from John Thomas - Com. of Loc. dated 31st Dec^r 1795, I have admeasured & laid out unto John Strange a tract of 150 acres of land in Pickens District on the waters of Saluda River. Bounded by lines running W. & S. on lands of Joshua Sifton, W. on lands surveyed for John Steen, all other sides of lands of John Strange and vacant land, and hath such form and marks as the above Plat represents.

Surveyed 31st Dec^r 1795. M^r. Gaston D.
Recorded 24th Feb^y 1796. Dea. Conner

