

State of St. Charles Pursuant to a warrant from
 John Thomas Esq. Comr. of the St. Charles
 dated 29th Jan'y 1795 have ascertained and laid
 out unto John Thomas Esq. a tract of 83 acres of land
 in Franklin County St. side & some higher in
 a much water of some river bounding by
 running N.W. by land laid out for
 John Thomas Esq. by St. Charles and S. by
 land, and both such shape form and
 as the above Plot represents
 Surveyed 31st Jan'y 1795. J. C. Wilson Esq. J. C. Comp.
 Recorded 21st Jan'y 1795.

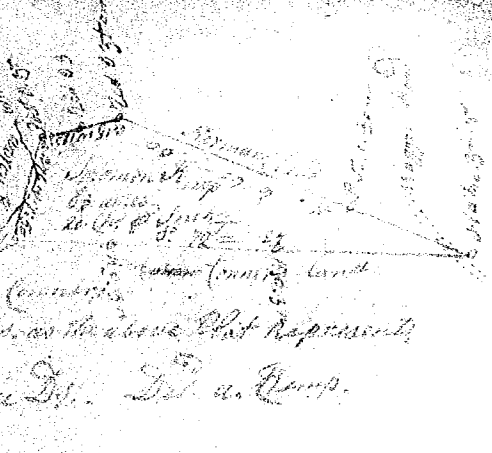

St. Charles Pursuant to a warrant from
 John Thomas Esq. Comr. of the St. Charles
 dated 15th Decr. 1794 have
 ascertained and laid out unto John Thomas Esq.
 a tract of three hundred & thirty seven
 seven acres of land, on the above
 waters which County, bounded
 by John Patrick's land, S. by Charles
 Patrick's land, all other sides by
 vacant lands, and both such
 shape form and marks as the above
 Plot represents Surveyed 18th Decr. 1794
 by Charles Decker Esq. Comr.
 Recorded 22nd Jan'y 1795. Decker

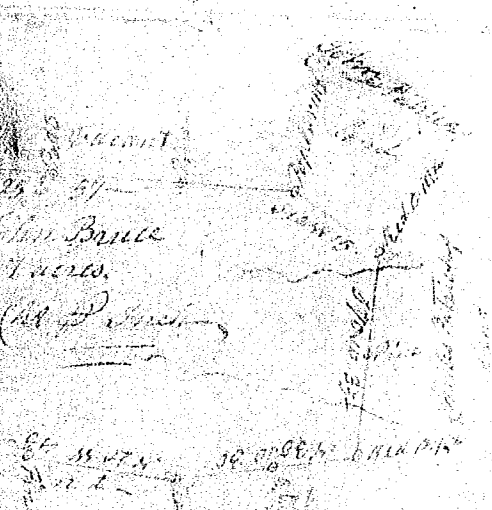

State of St. Charles Pursuant to a warrant from
 John Thomas Esq. Comr. of the St. Charles
 dated 10th Decr. 1794 have ascertained and laid
 out unto John Thomas Esq. a tract of five
 hundred acres of land in
 Frederick County in
 the District of
 near branches of
 which, bounded by
 vacant lands, S. by
 man's own land and
 and both such shape form
 and marks as the above Plot represents
 Surveyed 17th Decr. 1794
 Recorded 22nd Jan'y 1795

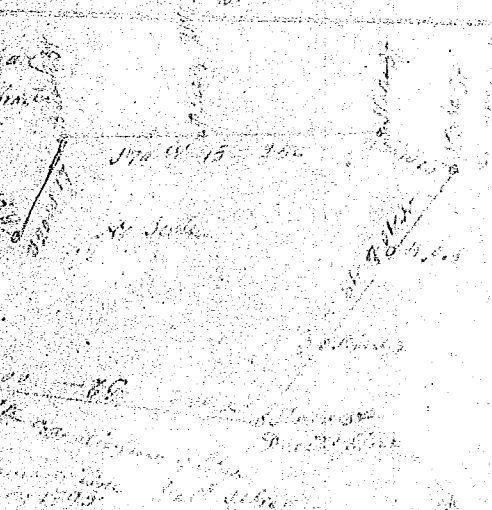

St. Charles Pursuant to a warrant from
 John Thomas Esq. Comr. of the St. Charles
 dated 16th Decr. 1794 have ascertained and laid
 out unto John Thomas Esq. a tract of four
 hundred & thirty one
 acres of land in
 Frederick County in the
 of Green & New Creek of
 both such shape form
 and marks as the above Plot represents
 Surveyed 17th Decr. 1794
 Recorded 2nd Feb'y 1795

