

State of South Carolina Pursuant to a warrant from John Thomas Esq. Comdr. of the District of South Carolina (296)

I have admeasured and laid out unto Jonathan Low a tract of one hundred and twenty seven acres adjoining on the N.E. side of Carolol River bounded on the S.W. by the canal and so by land the corner known to be on the East by vacant land 10.7 by the river; by both such shape and marks as are above plat represents Surveyed the 10th June 1794 W. Smith's

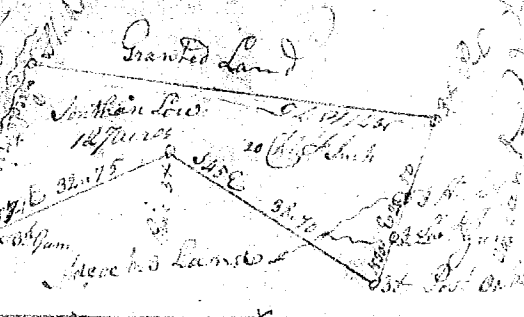

South Carolina - Pursuant to a warrant from John Thomas Esq. Comdr. dated the 25th Dec 1793 I have admeasured and laid out unto Thomas Gore a tract of 435 Acres of land Situate in Pinckney District - Shortburg County on both sides Pinckney River; bounded all round by vacant land by both such form & marks as the above plat represents Surveyed the 27th Dec 1793 Jesse Council Esq. Recorded the 4th Dec 1794

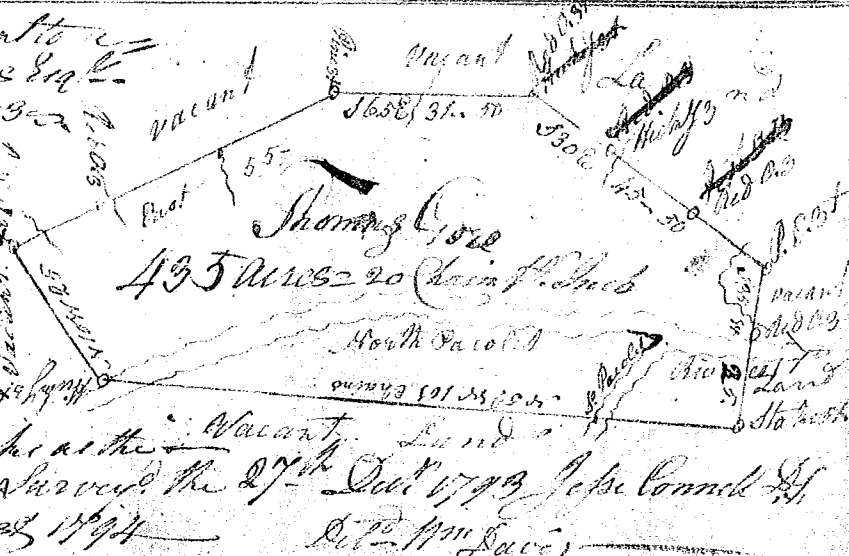

South Carolina Pursuant to a warrant from John Thomas Esq. Comdr. of loc 9 in Washington dated 19th Aug 1793. I have admeasured & laid out unto Young Griffin a tract of five hundred acres of land Situate in Sals District on the head branches of Needy river bounded by lines running N.E. & S.W. by land laid out for the said Griffin & land unknown S.E. by land unknown all other sides vacant and hath such form & marks as the above Plat represents Surveyed 20th Aug 1793

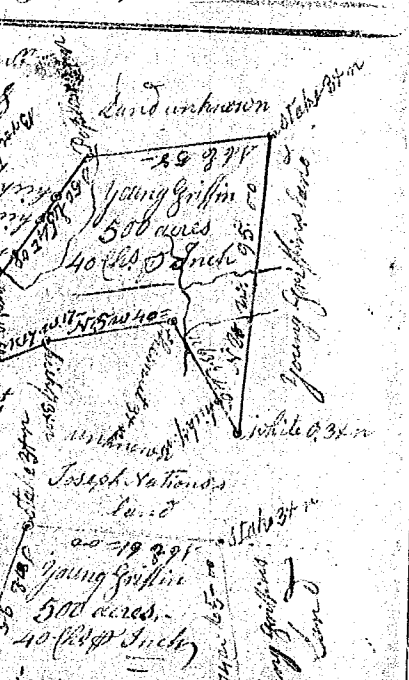

Recorded 17th Aug 1794 - Jesse Carter Esq.
 South Carolina Pursuant to a warrant from John Thomas Esq. Comdr. of loc 9 in Washington District dated 19th Aug 1793, I have admeasured and laid out unto Young Griffin a tract of five hundred acres of land Situate in Sals District on the head branches of Needy river bounded by lines running S.E. & S.W. by said Griffins land & Joseph Nations & John Anderson S.E. & S.W. by John Anderson all other sides vacant and hath such form & marks as the above Plat represents, Surveyed 20th Aug 1793, - Recorded 11th Aug 1794



State of South Carolina Pursuant to a warrant from John Thomas Esq. Comdr. dated the 9th Feb 1794 I have admeasured and laid out unto James Patterson a tract of 218 acres of land Situate in Greenville County on both sides Needy river the S.E. part bounded S.W. by the river & S.W. by land laid out for the said Griffins all other sides vacant and hath such form & marks as the above Plat represents Surveyed the 23rd Feb 1794