

S. Carolina Pursuant to a (236)

Warrant from John Thomas Esq. Com. Locations  
 Dated the 10<sup>th</sup> Dec. 1792. I have  
 Admeasured & laid out unto John Gray a tract of  
 One Hundred & Sixty four acres of land, Situate  
 in Pinkney District Spartanburg County on the  
 N<sup>o</sup> Side of Snyfons lead creek & bounded on the  
 So by William Thompsons land. N. by Lecharnie  
 Wilsons land & all other sides by Landowners  
 & hath such Corn marks, Distings & Boundings  
 as the above Plat Represents.

Survey - 1<sup>st</sup> Jan 1793

Recorded the 5<sup>th</sup> April 1793 Det. self

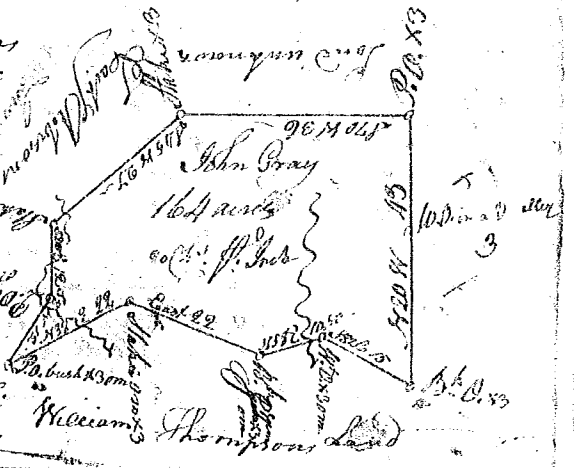

State of S. Carolina Pursuant to a warrant from John  
 Thomas Esq. Com. no. 1000 Dated the 5<sup>th</sup> day of  
 Feb. 1793. I have admeasured & laid out unto Sunford  
 Hudson a tract of Fifty three acres of land  
 Situate in Washington District Greenville County  
 on the So Side Broad River, on Rocky creek waters of  
 River. Bounding by lines Namely, S. 84<sup>o</sup> by land granted to  
 John Hudson Sr. by Unknown land N. W. & N. E. by  
 land granted to Francis Tubler & hath such shape  
 form Distings & bounding as the above Plat Represents.

Survey the 10<sup>th</sup> Feb. 1793

Recorded the 3<sup>rd</sup> April 1793 Det. self

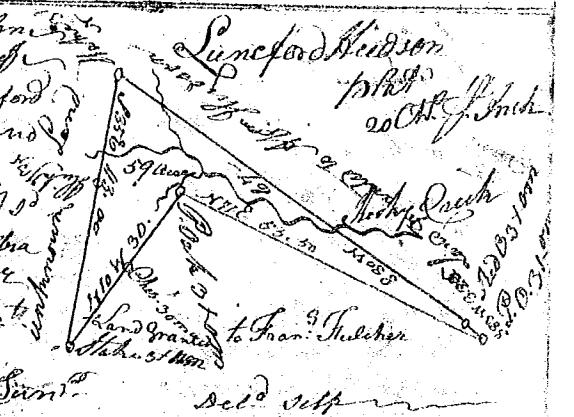

S. Carolina Pursuant to a warrant from

John Thomas Esq. Com. Locations Dated the  
 13 Feb. 1793. I have admeasured and laid  
 out unto Jesse Laxon a tract of 168 acres of  
 land Situate in Pinkney District, Spartanburg  
 County, on both sides of Pacolet river, bounded  
 N. by James Turners land, S. E. by John Cobbs  
 land, all other sides by Vacant Land, and hath  
 such shape, Marks, Distings & bounding  
 as the above Plat represents, Survey the

Recorded the 6<sup>th</sup> April 1793, Det. self

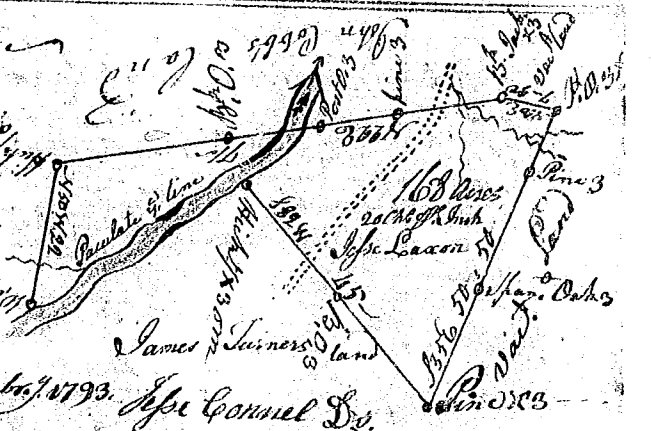

State of South Carolina Pursuant to a warrant from John  
 Thomas Esq. Com. of locs. dated 11<sup>th</sup> Feb. 1793 I have ad-  
 measured and laid out unto Nathaniel Abbott a tract of  
 258 acres of land in Pinkney District Spartanburg  
 County near the head of Island Creek, bounded N.  
 by James Stedmans land, So by Wades land  
 all other sides by Vacant Land, and hath  
 such shape, Marks, Distings and bounding  
 as the annexed Plat Represents.

Survey, 15<sup>th</sup> Feb. 1793,

Jesse Connell, Esq.

Recorded the 6<sup>th</sup> April 1793, Det. self,

