

Carolina Pursuant to a Warrant from John Thomas Esq. Comm. of Locations, &c.

I have laid out unto John Pops a tract of Five Hundred & Ninety One acres, being on Broad River about on the N. Side, about three quarters of a mile above the mouth of Buffed Creek including part of said also plantation & hath full shape & marks as the above plat represents.

Certified the 24<sup>th</sup> Nov<sup>r</sup> 1791  
James Smith Esq.  
Recorded the 28<sup>th</sup> Nov<sup>r</sup> 1791

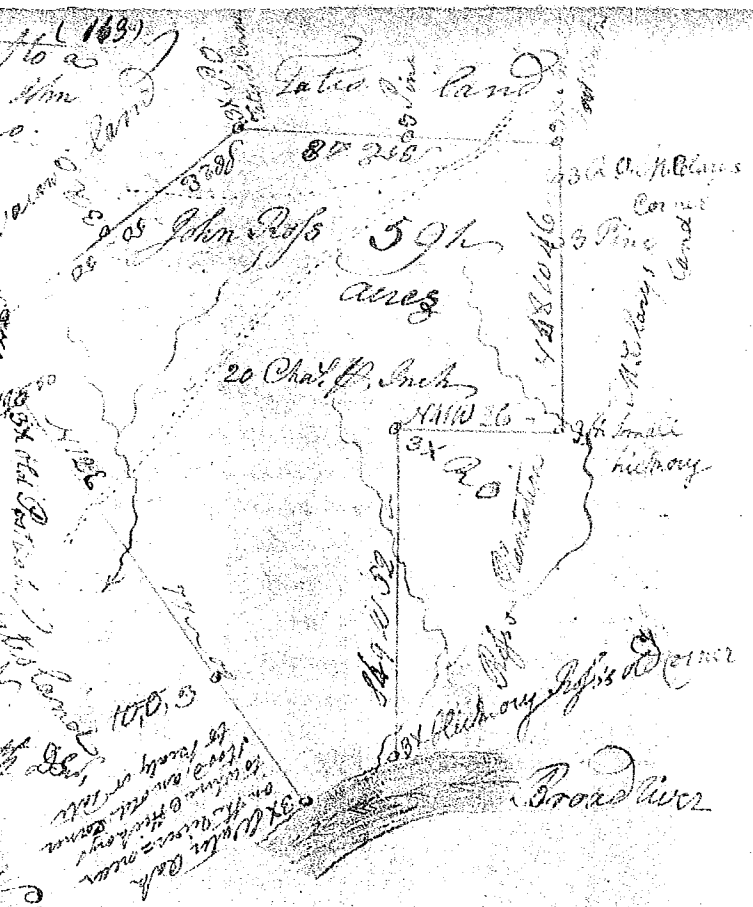

Carolina Pursuant to a Warrant from John Thomas Esquire Comm. of Locations in the District of Saluda, &c. On the 12<sup>th</sup> day of Dec<sup>r</sup> 1789 I had measured & laid out unto James Crook a tract of one thousand five acres of land situated on the N. side of the Broad River & bounded by John Pops's by Englishes Land &c. & other land & hath full shape and marks as the above plat represents. I was the 19<sup>th</sup> of Dec<sup>r</sup> 1789  
Recorded the 29<sup>th</sup> Nov<sup>r</sup> 1791 Del. son

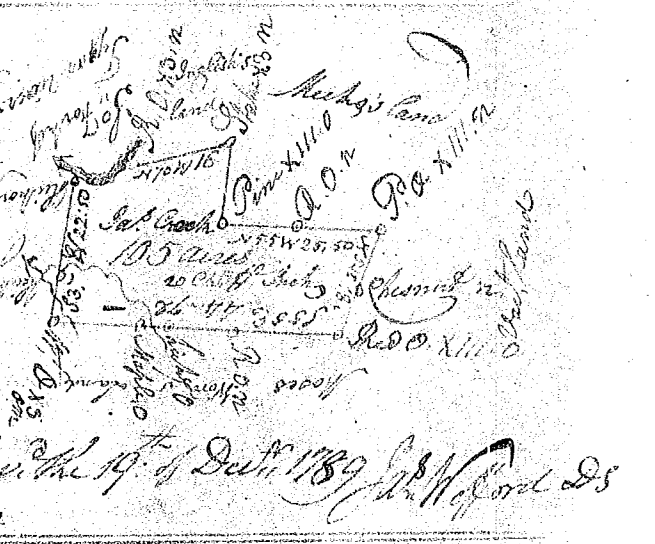

South Carolina Pursuant to a warrant from John Thomas Esq. Commissioner of Locations, I have laid out unto Eld Fowler a tract of 177 acres of land situate in the District South side of Broad River on the branches of Sandys River, and hath full shape & marks as the above plat represents, including the plantation &c.  
Witnessed the 1<sup>st</sup> November 1791. Charles Sims Esq.  
Recorded 2<sup>nd</sup> Nov<sup>r</sup> 1791 Del. self.

