

State of S<sup>c</sup> Carolina Pursuant to a warrant from John Thomas Esq. Com<sup>r</sup> of loc<sup>s</sup> 4<sup>th</sup> Saluda I have measured and laid out unto John Henry a tract of five Hundred and Sixteen acres of land in Ninety Six District among

in Spartanburg & Edgecombe Counties of both sides of Sacolet river, bounded N. by Hugh Peirce land E. by John Stobbs land and N. Pool's land and the Iron Works land, W. by Boisen's land & vacant land and hath such shape, form and Marks as the above Plat represents,

Recorded 23<sup>rd</sup> Aug<sup>t</sup> 1791, Del. Self, W. Wiley, by me this 22<sup>nd</sup> day of Aug<sup>t</sup> 1791. Nardoy 11:1:22

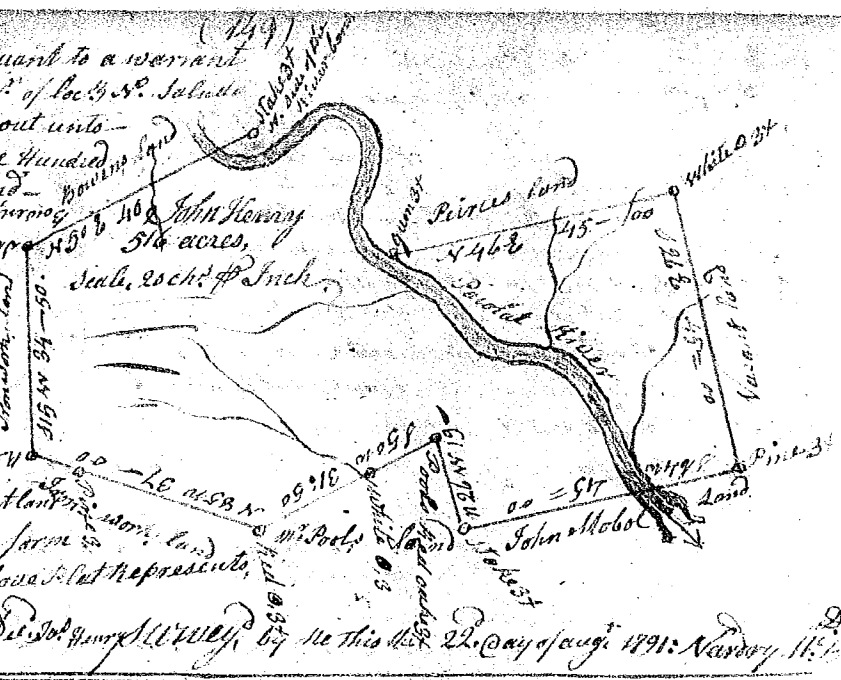

S<sup>c</sup> Carolina Pursuant to a warrant from John Thomas Esq. Com<sup>r</sup> of loc<sup>s</sup> 1<sup>st</sup> District N<sup>o</sup> Saluda dated 11<sup>th</sup> August 1791 I have measured and laid out unto James Garrett a tract of Three hundred and Thirteen acres of land in said District on various Creek, waters of Middle River, bounding E. on Edward Garrett, W. on William Cochran & William

Saughn the other sides on land not known, and hath such shape, form & Marks as the above Plat represents, Surveyed 21<sup>st</sup> Aug<sup>t</sup> 1791, John Rodgers, Del. Recorded 27<sup>th</sup> Aug<sup>t</sup> 1791, Del. Self,

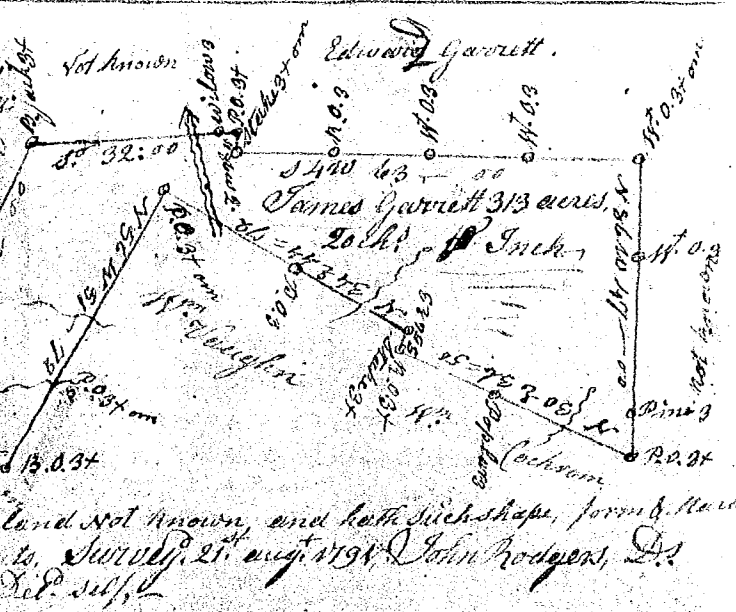

State of S<sup>c</sup> Carolina Pursuant to a warrant from John Thomas Esq. Com<sup>r</sup> of loc<sup>s</sup> 7<sup>th</sup> dated 14<sup>th</sup> Aug<sup>t</sup> 1791 I have measured & laid out unto Thomas Rowland a tract of one hundred and Ninety Two acres of land in Greenville County on the S<sup>th</sup> side of Saluda river, bounded N.W. by a line running N 40 E by land laid out unto the said Thomas Rowland, S.W. by a line running N 50 W by land laid out unto the said Rowland all other sides on vacant land, and hath such shape marks buttinings & encodings as the above Plat represents, Surveyed 14<sup>th</sup> August 1791,

Recorded 31<sup>st</sup> Aug<sup>t</sup> 1791,

