

South Carolina Pursuant to a warrant from John Thomas Esq.  
 Comr. of locat<sup>n</sup> dated 20<sup>th</sup> July 1791, I have admeasured and  
 laid out unto Eleanor Johnston a tract of 176 acres  
 of land, in Ninety Six District Union County on  
 a small branch of Headleys Creek waters of Enoree  
 river bounded by a line running S 48 W by land  
 survey for Saml. Swinford, N 20 W by Eleanor John-  
 =son, by a line N 42 W by Nathl. Figue, all other  
 sides on land surveyed for John Liddlely, and Nathl. Such, and  
 marks as the above Plat represents, July 21<sup>st</sup> 1791.  
 Recorded 30<sup>th</sup> July 1791. D. P. Jaffer, D. Pearson D.

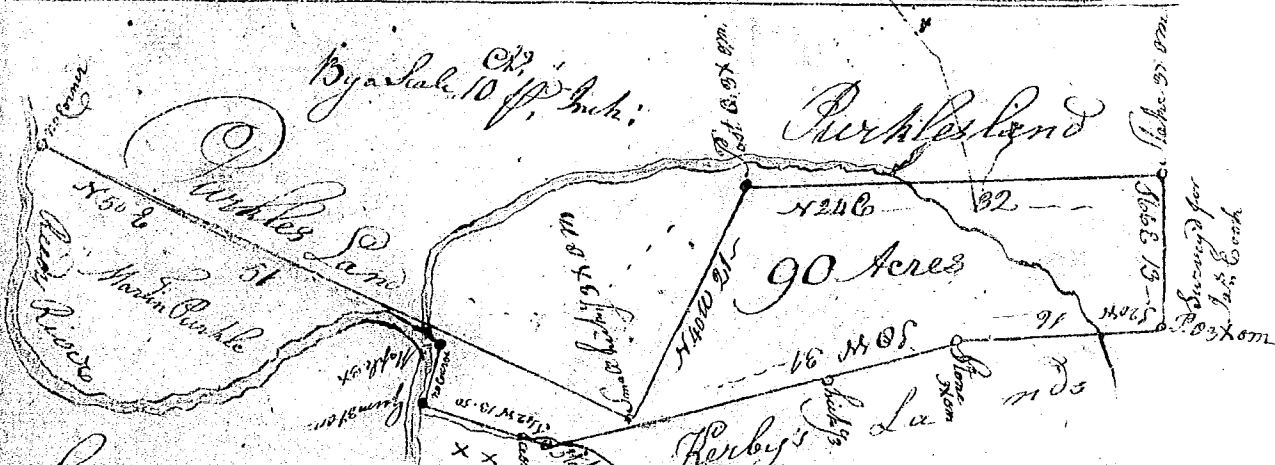

State of South Carolina Pursuant to a  
 Warrant from John Thomas Esq.  
 Comr. of Locations N<sup>o</sup> Saluda river.  
 I have admeasured and laid out unto  
 Amos Speer a tract of 398 acres of  
 land, in Spartanburg County on both  
 sides of South Pacolet river including  
 the forks of S<sup>th</sup> & N<sup>th</sup> Pacolet rivers and  
 hath such shape marks, bullings &  
 boundings as the above Plat represents  
 Certified 16<sup>th</sup> June 1791.  
 George Simon, D.  
 Recorded 17<sup>th</sup> Aug, 1791. D. P. Jaffer

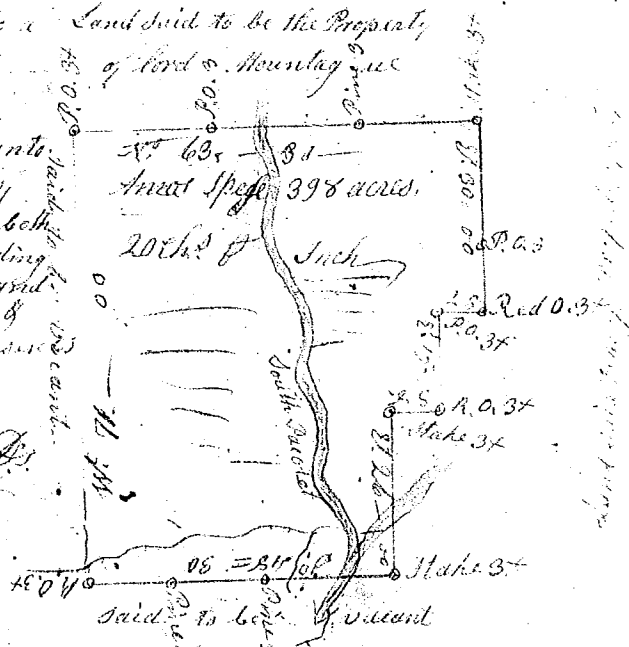

South Carolina Pursuant to a warrant from John Thomas Esq.  
 Comr. of Locations, Dated the 11<sup>th</sup> June 1791, I have admeasured & laid out unto  
 Martin Purkle, a tract of land containing Ninety acres, lying in Greenville  
 County, on the North side of Ruddy River, Bounded Southward by Ruddy River & Edward  
 by Rerby's Land & Edward by land Surveyed for James Cook Westward by Martin and  
 Jacob Purkles lands and hath such shape form & marks as the above Plat represents  
 Certified of me this 8<sup>th</sup> August 1791.  
 James Harrison D.

Recorded the 20<sup>th</sup> Aug, 1791.  
 Del. Michl Purkel