

South Carolina Pursuant to a warrant
 from John Thomas Esq. Comr. of loc. in 36th District N. Saluda river
 Dated 14th Janry 1798, I have admeasured and laid out unto
 Alexander Mc Kenney a tract of fourteen acres of land in said
 District on both sides of Checharon or the N. fork of Saluda river
 in Greenville County, bounded by a line running N.W. by Jonathan
 Muddick's land S.E. by land granted to Bayley Anderson, the other sides by Vacant
 Mountain, and hath such form and Marks as the above Plat represents,
 Surveyed 15th Janry 1798, Wm. D. Thomas, Esq.
 Recorded 26th Feby. 1798, Det. M. Robinson

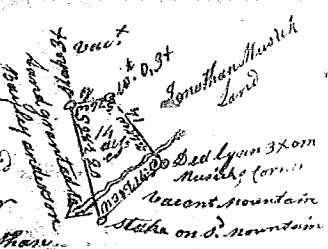

State of South Carolina Pursuant to a warrant from
 John Thomas Esq. Commissioner of Locations in 36th District
 N. Saluda dated 1st day of March 1798, I have
 admeasured and laid out unto High Nelson
 a tract of one hundred & Twenty seven acres
 of land in said District, on branches of 54th
 Tygar river in Greenville County bounding
 by a line running N.E. by land surveyed for
 Major Parsons, S.W. by land granted to Uriah
 Smith, S.E. by Robert Nelson's land, the other sides vacant
 and hath such form and Marks as the above Plat
 represents, Surveyed 2nd March 1798, Wm. D. Thomas, Esq.
 Recorded 3rd March 1798

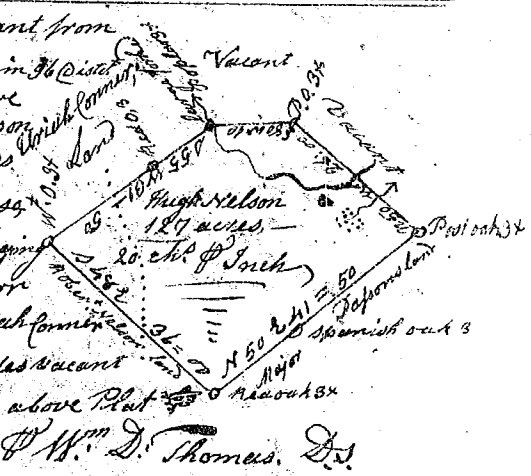

South Carolina Pursuant to a warrant
 from John Thomas Esq.
 Dated 1st March 1798 I have admeasured
 and laid out unto John Blackwell
 a tract of four hundred & seventy five
 acres of land, above the old Indian
 boundary on a branch of
 Mountain Creek (Call
 Beaver dam waters of Saluda
 river, bounded N. on Isaac James
 N.W. on Rich. Brown N.E. on Uthy
 Necks, S. on Joel Chandler,
 and hath such shape form &
 Marks as the above Plat represents,
 Surveyed 9th Janry 1798,
 John Rodgers Esq.
 Recorded 16th March 1798, Det. M. Moore

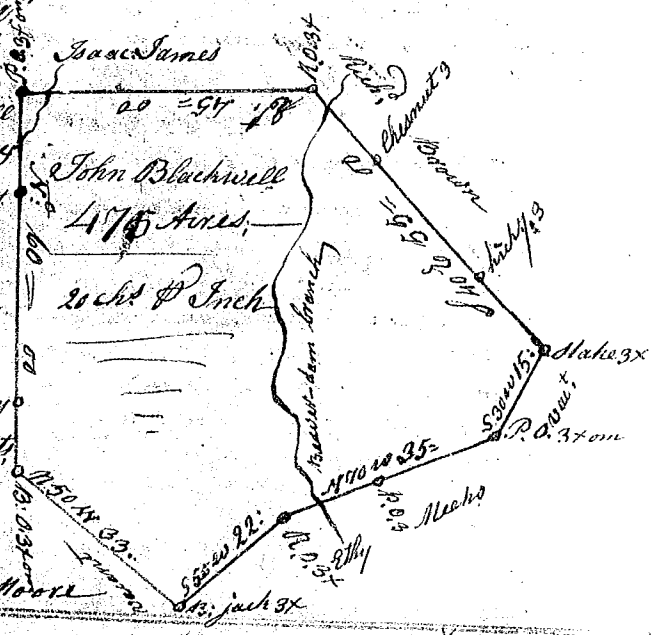

Pursuant to a warrant from John Thomas
 Esq. Commissioner of Locations, I have admeasured & laid
 out unto Henry Miller a tract of 135 acres
 on branches of Cannon Creek, to John Broad
 and hath such shape form marks
 as the above Plat represents, Surveyed 15th June 1792,
 Chas. Sims Esq.
 Recorded the 17th July 1792

