

State of S<sup>c</sup> Carolina Pursuant to a warrant (125)  
 from John Thomas Esq<sup>r</sup> Com<sup>r</sup> of Loc<sup>s</sup> dated 2<sup>d</sup> febr<sup>y</sup> 1791.  
 I have admeasured and laid out unto John  
 Pridmore a tract of Two hundred and fourteen  
 acres of land in 96<sup>th</sup> district, waters of Saluda  
 river, bounding by a line running  
 N.E. & S.E. on land survey<sup>d</sup> for John  
 Kirkonell, by a line N.E. on land  
 survey<sup>d</sup> for John Portman, by a line  
 running N.W. N.W. & N.E. on land survey<sup>d</sup>  
 for John W<sup>h</sup>orter, all other sides  
 on vacant, or unknown lands, and  
 hath such form and Marks as the  
 above Plat Represents,

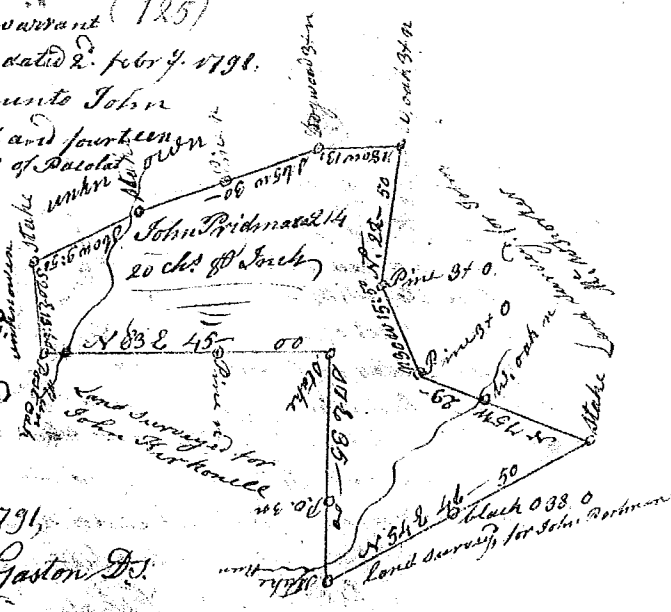

Survey<sup>d</sup> 14<sup>th</sup> febr<sup>y</sup> 1791  
 Recorded 17<sup>th</sup> febr<sup>y</sup> 1791 Del. W<sup>m</sup> Gaston Esq<sup>r</sup>  
 Del. self

State of S<sup>c</sup> Carolina Pursuant to a  
 warrant from John Thomas Com<sup>r</sup> of Loc<sup>s</sup>  
 dated 19<sup>th</sup> Dec<sup>r</sup> 1790, I have admeasured  
 and laid out unto William Duncan  
 two hundred & ninety acres of land  
 situat in said district on the little  
 beaver dam waters, waters of Saluda  
 river, bounding by a line running  
 S.W. on William Wood's land, and by  
 running N.W. on Saffarty's lands &  
 S.E. on lands laid out Fauverer  
 Beels all other sides on vacant land  
 and hath such shape Marks as the above  
 Plat Represents.

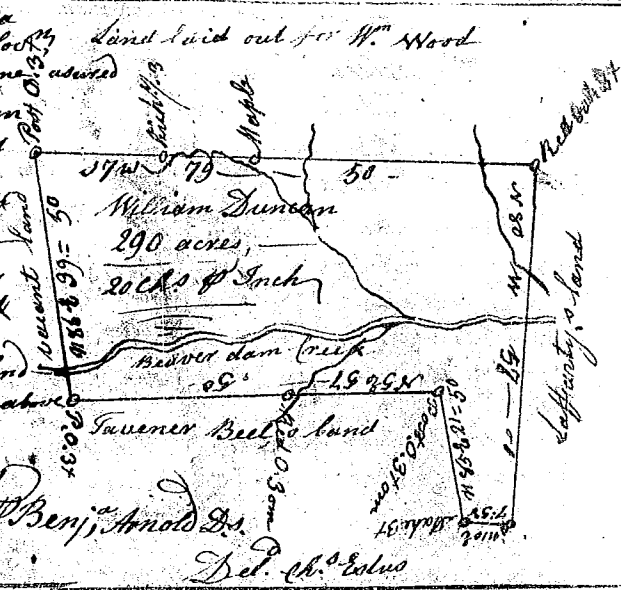

Survey<sup>d</sup> 6<sup>th</sup> Jan<sup>y</sup> 1791  
 Recorded 21<sup>st</sup> febr<sup>y</sup> 1791 Del. Benj<sup>n</sup> Arnold Esq<sup>r</sup>  
 Del. Ch<sup>s</sup> Edus

State of S<sup>c</sup> Carolina Pursuant to a warrant from John Thomas Esq<sup>r</sup>  
 Commissioner of Locations Dated 4<sup>th</sup> May 1787, I have  
 and laid out unto William Watt a tract of one  
 hundred acres of land in 96<sup>th</sup> district on both sides  
 of the Middle fork of Fall Creek of the N<sup>o</sup> fork of  
 Saluda River, and hath such shape form and  
 buttings & boundings as the above Plat Represents.

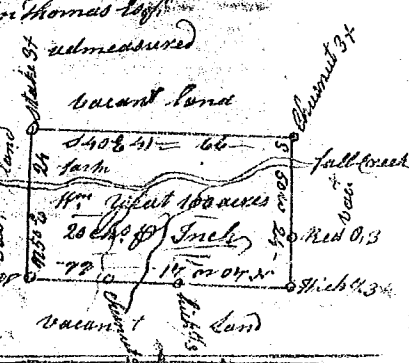

Survey<sup>d</sup> 26<sup>th</sup> May 1787  
 Recorded and Elapsed by Joseph Vaughan Esq<sup>r</sup> Whitner Esq<sup>r</sup>  
 the 25<sup>th</sup> febr<sup>y</sup> 1791 Del. Jas<sup>s</sup> Robison

State of S<sup>c</sup> Carolina Pursuant to a warrant from  
 John Thomas Esq<sup>r</sup> Com<sup>r</sup> of Loc<sup>s</sup> S<sup>c</sup> Saluda, I have  
 admeasured and laid out unto Jesse Higgins  
 a tract of Eighty three acres of land on  
 the ridge between beaver-dam and Buckhead  
 creeks in Laurens County Having such  
 shape, Marks buttings & boundings as the  
 above Plat Represents.

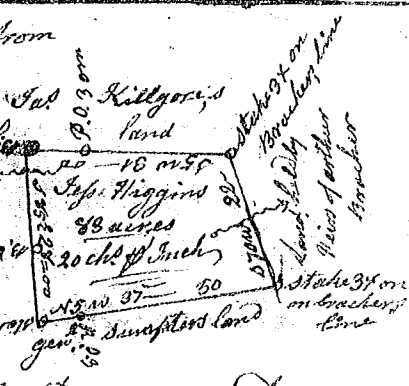

Survey<sup>d</sup> 1<sup>st</sup> febr<sup>y</sup> 1791  
 Recorded 24<sup>th</sup> febr<sup>y</sup> 1791 Del. self  
 Del. Robt Hanna Esq<sup>r</sup>