

State of S. Carolina, Pursuant to a warrant from John Thomas Esq. Comr. of locations Dated 13<sup>th</sup> June 1789, I have admeasured and laid out unto John Goodwin a tract of one hundred & forty acres of land in 9<sup>th</sup> district on Gilders Creek waters of Indian Creek, bounded N.E. on Jacob Bezard's land, S.E. on John Goodwin's land, S. on Peethatts land, S.W. on Kincaid's land & David Boyds land, and hath such shape & marks as the above Plat represents,

Recorded 21<sup>st</sup> Oct<sup>r</sup> 1789. Del. self

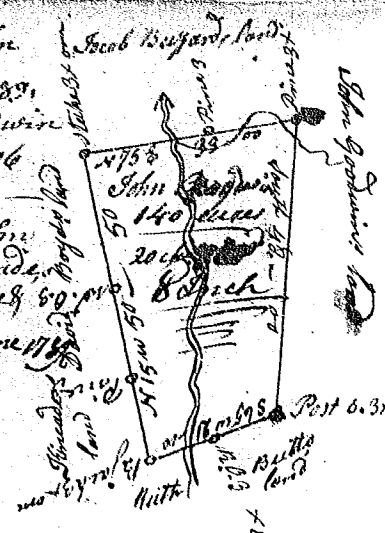

S. Carolina Pursuant to a warrant from John Thomas Comr. of loc<sup>ns</sup> dated 13<sup>th</sup> June 1789, I have admeasured and laid out unto John Goodwin a tract of 100 acres of land in 9<sup>th</sup> district on waters of Indian Creek N. of Saluda, bounded N.E. on Alex<sup>r</sup> M<sup>r</sup> Leads land, N.W. on Turners land, S.W. on Woodalls land, S.E. on Hermon Daviss land, and hath such shape & marks as the above Plat represents, Survey 19<sup>th</sup> June 1789,

Recorded 21<sup>st</sup> Oct<sup>r</sup> 1789. Del. self



S. Carolina Pursuant to a warrant from John Thomas Comr. of loc<sup>ns</sup> dated 13<sup>th</sup> June 1789, I have admeasured and laid out unto John Goodwin a tract of 63 acres of land in 9<sup>th</sup> district N. of Saluda on waters of Indian Creek bounded N.E. on Hermon Daviss land, S.E. on Jacob Bezards land, S.W. on David Boyds land, W. on Husmas land, and hath such shape and marks as the above Plat represents, Survey 19<sup>th</sup> June 1789, Del. self, Recorded 21<sup>st</sup> Oct<sup>r</sup> 1789, Del. self,

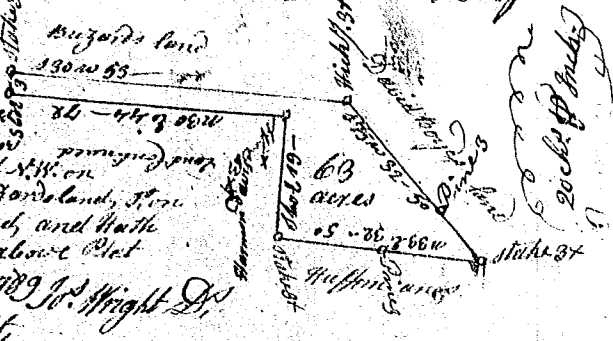

State of S. Carolina, Pursuant to a warrant from John Thomas Esq. of loc<sup>ns</sup> for the N. side of Saluda River Dated 23<sup>rd</sup> Oct<sup>r</sup> 1789, I have admeasured and laid out unto Charkin Pollard a tract of one hundred & thirty acres of land, above the Indian Boundary line in Greenville County on the waters of the Golden-grove Creek, bounded N.E. on George Tankslays land, S.E. on Judge Pendelton's land, S.W. on John Higgins's land N.W. on a survey unknown, and has such shape and marks as the above Plat represents, Survey 24<sup>th</sup> Oct<sup>r</sup> 1789,

Recorded 21<sup>st</sup> Oct<sup>r</sup> 1789. James Seaborn Esq. Del. self

