

Pursuant to a Precept to me issued by John Thomas Esq<sup>r</sup> Commissioner of locations of Saluda river Dated 31<sup>st</sup> March 1789, I have well admeasured and laid out unto James Puckett a tract of two hundred and forty four acres of land, on the N.E. side of Saluda and on Cain Creek in Laurence county, Bounding S.E. on lands of said Puckett, N.E. on land of one Purvis, Edwards & McPrigal, W. on lands of Mrs Turkey, & Patrick Cunningham, S.W. on said river & Goudys Land, and hath such shape and Marks as the above Plat Represents,

Certified 6<sup>th</sup> April 1789,  
 W<sup>m</sup> Caldwell Esq<sup>r</sup>  
 Recorded 12<sup>th</sup> May 1789, Del. self

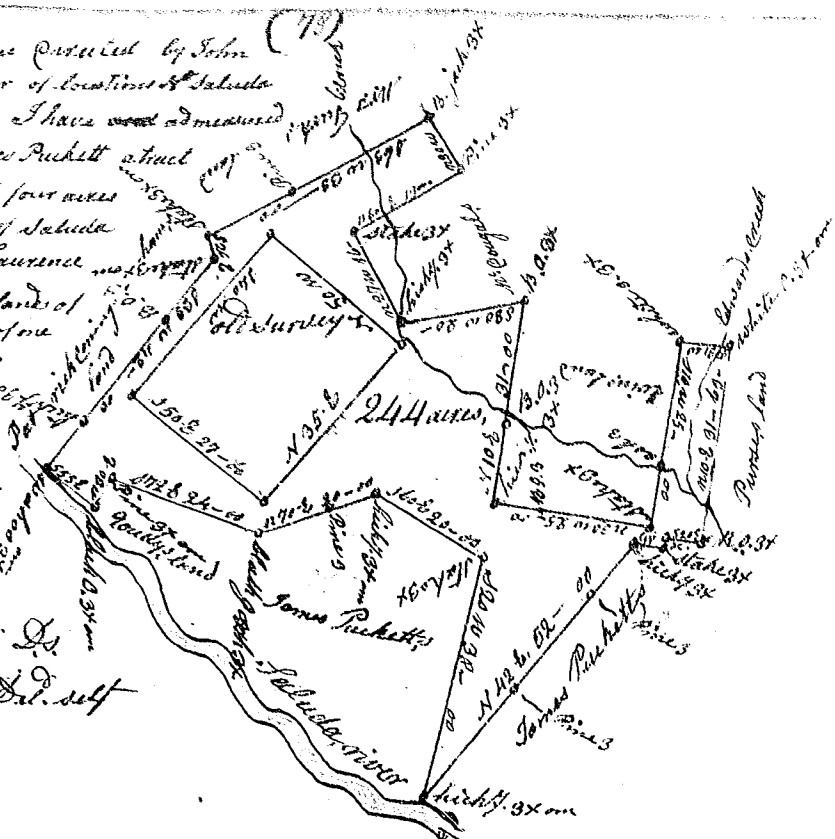

South Carolina 96 District of Saluda

Pursuant to a warrant from John Thomas Esq<sup>r</sup> Com<sup>r</sup> of loc<sup>s</sup>, Dated 20<sup>th</sup> Jan<sup>y</sup> 1789, I have admeasured & laid out unto Richard Fowler a tract of four hundred & fifty acres of land, on the S<sup>th</sup> side of Enoree river, Bounded N<sup>th</sup> said river, N<sup>th</sup> by Thomas Moores land, W<sup>th</sup> by Robert Alersons land & W<sup>th</sup> Thomson land, S<sup>th</sup> by John Moores and Chamberss land, all other sides Vacant land, and hath form shape & Marks as the above Plat Represents,

Recorded 16<sup>th</sup> May 1789, Del. self Survey 28<sup>th</sup> Feb<sup>y</sup> 1789. Del. Willford Esq<sup>r</sup>



Pursuant to a warrant from John Thomas Esq<sup>r</sup> of locations 96 District of Saluda, I have admeasured & laid out unto Charles Harrington a tract of two hundred & ninety one acres of land, on the S<sup>th</sup> side of Broad river, Bounded N.E. on Vacant land, N.W. on Nathaniel Guitons land, S.W. on Ledbetters land & on Ledbetters land, S.E. on Moses Guitons, and hath such shape and Marks as the above Plat Represents,

Survey 1<sup>st</sup> Dec<sup>r</sup> 1788, Lach<sup>r</sup> Bullock Esq<sup>r</sup>.  
 Recorded 26<sup>th</sup> May 1789, Del. self

