

State of Carolina Pursuant to a warrant from John Thomas Esq. Commissioner of locations & Saluda, I have admeasured and laid out unto William Morris a tract of six hundred & seventy nine acres of land in said District on back branch of Gatchers Creek, bounded N^o by Joseph W. Morris's lines, S.E. by W^m Morris's line, S. by Swallows line, W. by Joseph Morris's line, and hath such shape form & marks as the above Plat represents
 Survey 10. May 1788,
 Vardry M. Bee Esq.

Recorded 12th June 1788.

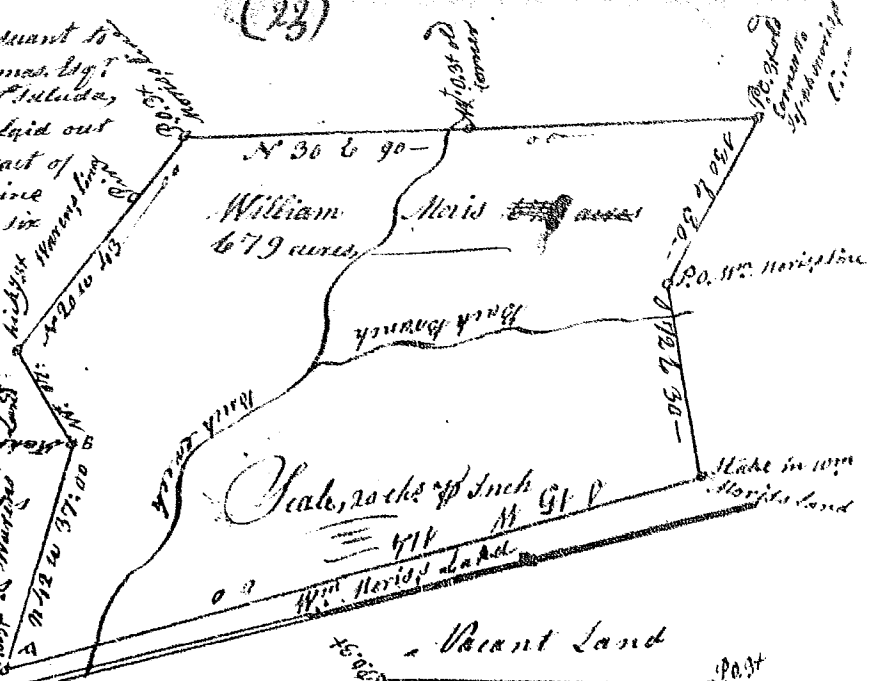

State of South Carolina Pursuant to a warrant from John Thomas Esq. Commissioner of locations & Saluda, I have admeasured and laid out unto John Adkinson a tract of 274 acres of land in the District on the headwaters of Gilkeys Creek Waters of broad River, bounded N.W. by Andrews Jones's land, S.W. by Chapman's all other sides by Vacant Land. Having such shape form & marks as the above Plat represents, -
 Survey 25th May 1788,
 Vardry M. Bee Esq.

Recorded 13th June 1788.

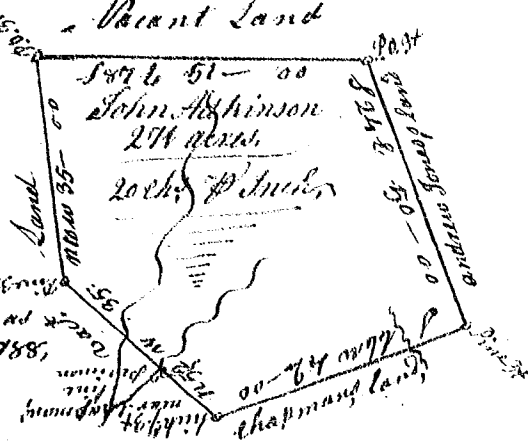

State S. Carolina Pursuant to a warrant from John Thomas Esq. Commissioner of locations & Saluda, I have admeasured and laid out unto Matthew Guttry a tract of one hundred & twenty two acres of land, on the S^o Side of Broad River bounded N^o and E^o by Markley's land, S^o by M^r Night's W^o by vacant land, and hath such shape form and marks as the above Plat represents,
 Survey 29th May 1788, Vardry M. Bee Esq.

Recorded 13th June 1788.

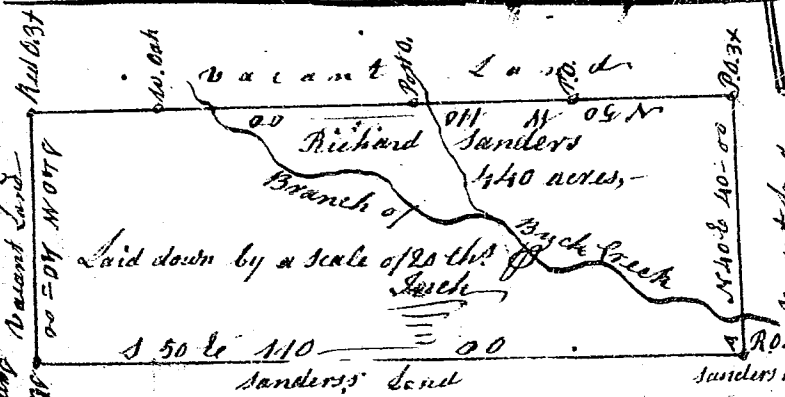
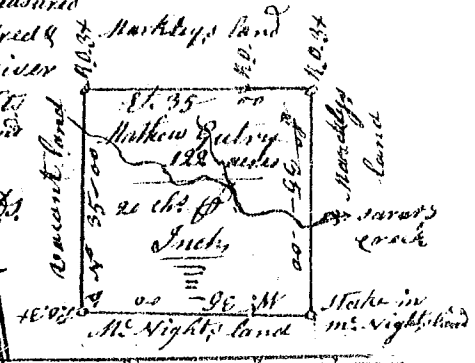

tract of four hundred and forty four acres of land, on a branch of Back creek waters of Parolat River, bounded W^o by said Sanders's land, all other sides by vacant land, and hath such form and marks, as the above Plat represents, -
 Survey 22nd May 1788, Vardry M. Bee Esq.

Recorded 16th June 1788.

State of Carolina, Pursuant to a warrant from John Thomas Esq. Com^r of loc^s & Saluda, I have admeasured & laid out unto Richard Sanders