

State of S^c Carolina Pursuant to a warrant from John Thomas Esq. Com^r of locations 96 District N^o Saluda, I have admeasured and laid out unto Edward Denny a tract of thirty-five acres of land in Union County on the north side of fairforest creek, on the small branches thereof, bounded by James Meadors land, all other sides by Thomas Armstrongs land, and hath such shape & marks as the above Plat Represents.
 Surveyed 25th April 1787 by Andrew Thomson D^r
 Recorded 26th July 1787

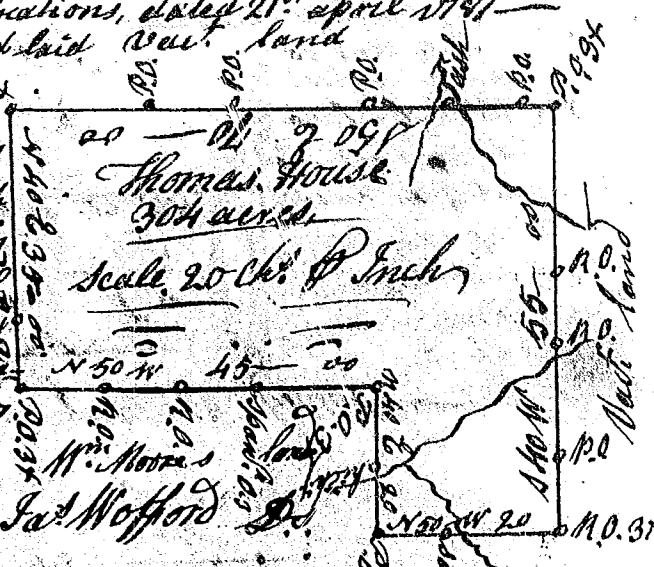

State of S^c Carolina Pursuant to a warrant from John Thomas Esq. Com^r of locations, dated 21st April 1787 I have admeasured and laid out unto Thomas House a tract of 304 acres of land in 96 District N^o of Saluda river on a branch of Forgisons creek within of Sugar river, and hath such shape and marks as the above Plat Represents.
 Surveyed 1st June 1787
 Recorded 26th July 1787
 by Jas^s Wofford D^r



Recorded 26th July 1787
 by Jas^s Wofford D^r

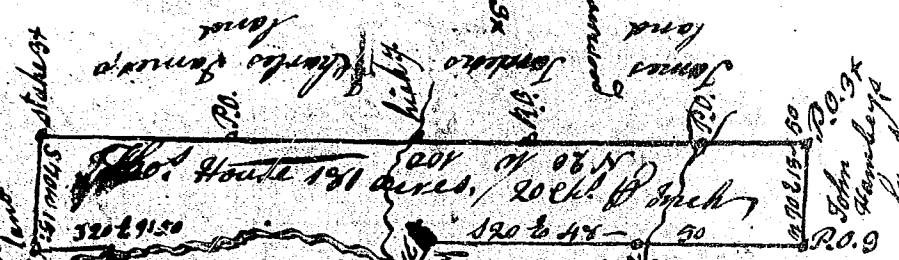

State S^c Carolina Pursuant to a warrant from John Thomas Esq. Com^r of locations 96 District N^o Saluda, I have admeasured & laid out unto Thomas House a tract of One Hundred & Eighty one Acre of land, Situal on a W. of Spruagen Creek of Enore River and hath such form, marks, cuttings & boundaries as the above plat Represents.
 Surveyed the 27th April 1787. Jas^s Wofford D^r
 Recorded 26th July 1787 D^r Self

