

State of South Carolina, —
 Pursuant to a warrant from
 John Thomas Esq. Com^r. of locations
 Dated 22 Dec^r. 1786, I have adme-
 = asured and laid out unto Charles
 Browning a tract of 113 acres of land in
 Union County & Spartanburg County
 situate on both sides Mitchell's Creek, waters
 of fairforest, bounded S.E. by John
 Bloensgame's Isaac Bogard's lands, N.W.
 & S. by J^r. L^r. Lancaster, N.E. & S.E. by
 Daniel Jackson's & Mark Jackson's land
 S.W. by Sam^l. Lancaster, land N.E. & S.E. by
 John Lancaster's land, all other sides
 and hath such shape & Marks as the above
 Plat Represents, Survey^d. 23 Dec^r. 1786,
 Sam^l. Lancaster S^r.
 Recorded 28th Feby^r. 1787.

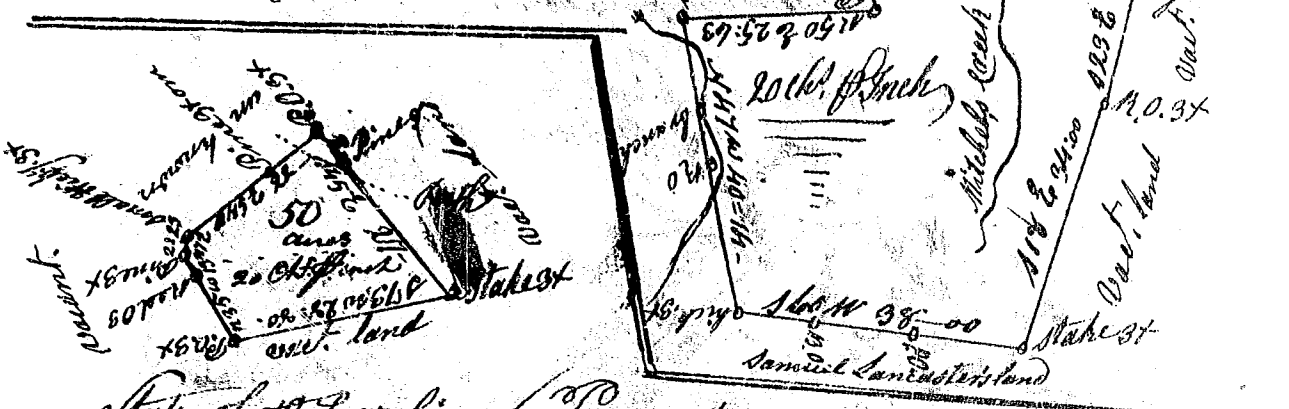

State of South Carolina Pursuant to a warrant from John Thomas
 Com^r. of locations Dated the 30th Jan^y. 1787, I have admeasured and
 laid out unto Madaworth & Turpin a tract of fifty acres of land
 in Ninety six District, Spartanburg County, including Little David's
 Mountain, and hath such shape and Marks as the above Plat Represents,
 Survey^d. 31 Jan^y. 1787, W^m. Benson S^r.
 Recorded 3rd March 1787.