

South Carolina,

Pursuant to a warrant from John Thomas Esq. Commissioner of locations dated 1st Sept^r 1786, I have admeasured and laid out unto George Long a tract of three hundred & fifty four acres of land on the waters of $\times \times \times$ and hath such shape, Marks, buttings & Boundings as the above Plat Represents, Survey 1st Dec^r 1786

Phil. Walters D^r

Recorded 19th Dec^r 1786,

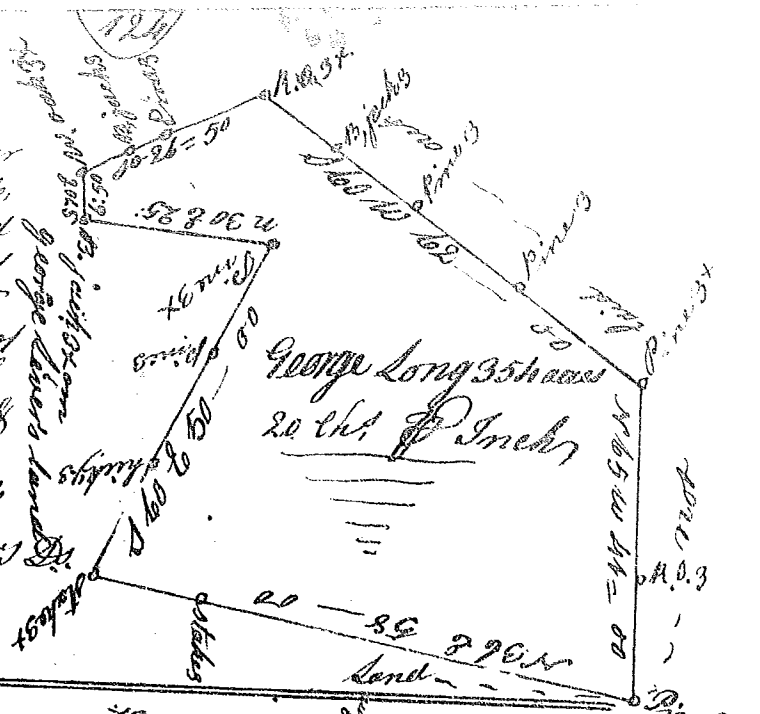

State of S^c Carolina,

Pursuant to a warrant from John Thomas Com^r of locations dated 14th April 1786, I have admeasured and laid out unto John Mahaffey a tract of 245 acres of land, in 9th district N^o side saluda on the branches of Rocky Creek of lower river, and hath form and Marks as the above Plat Represents, Survey 15th April 1786.

W^m. D. Thomas, D^r

Recorded 26th Dec^r 1786,

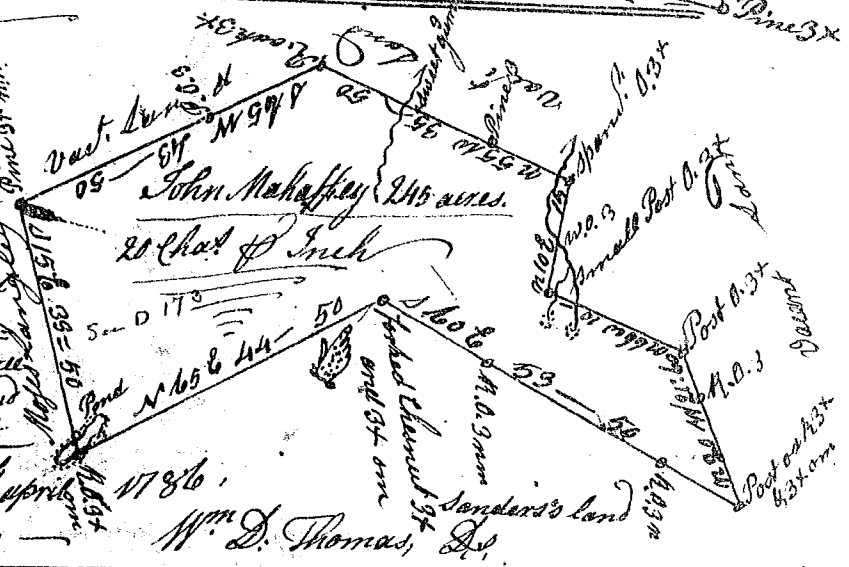

State of South Carolina,

Pursuant to a warrant from John Thomas Com^r of locations N^o saluda, dated 12th Dec^r 1786, I have admeasured and laid out unto William Calmes a tract of one hundred & seventy four acres of land in Newberry County in 9th District below the dam on a small Draught of lower river and hath such shape, marks, buttings and boundings as the above Plat Represents, Survey 19th Dec^r 1786.

Abel Pearson D^r

Recorded 21st Dec^r 1786,

Del. self

