

State of South Carolina,
 Pursuant to a warrant
 from John Thomas Esq. Comr.
 of locations, dated 25th Oct. 1786
 I have admeasured and
 laid out unto Patrick Carmichael
 a tract of 230 acres of land, in
 6th district, on the waters
 of Buffalo Creek, and
 hath such shape, Marks, buttings
 and Boundings as the above
 Plat represents, Survey 18th Oct. 1786
 Recorded 27th Nov. 1786. Det. John M. Helen,

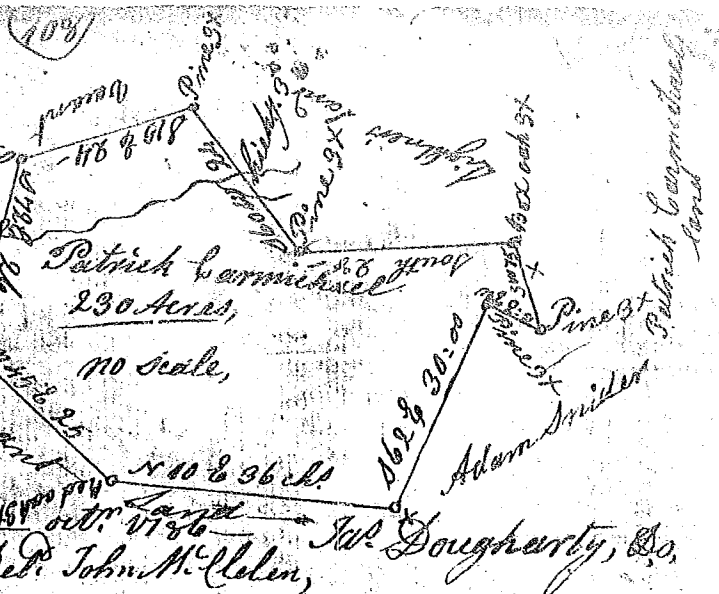

State of South Carolina
 Pursuant to a warrant from John Thomas Esq. Comr. of locations
 Dated 6th Aug. 1786. I have admeasured and laid out unto Joseph McLaughlen
 a tract of three hundred and forty acres of land, in Greenville County
 on both sides of Pines Creek of Snowe river near Wile's old Place, and
 hath such shape, form, marks, buttings and boundings as the above
 Plat represents, Survey 30th Aug. 1786, Wm J. Thomas Esq.
 Recorded 18th Nov. 1786. Det. M. Sanders

State of S. Carolina Pursuant to a warrant from John Thomas Esq.
 Commissioner of locations for 6th district N. of Saluda river dated
 3rd Nov. 1785, I have admeasured and laid out unto George
 Cox a tract of fifty acres of land, in 6th district, below the
 ancient boundary on said river, bounded S.E. & Part on the
 N.E. by Cornelius Cox's land, Remainder Part on N.E. by land
 unknown, N.W. by Henry Metcher's land, S.W. by Saluda river
 and hath such shape and Marks as the above plat represents
 Survey 10th Nov. 1785, by Philemon Waters Esq. and
 Elapsed by Wadsworth & Turpin 11th Nov. 1786.
 Recorded 11th Nov. 1786 for said Wadsworth and Turpin.

