

South Carolina
 Pursuant to a warrant from
 John Thomas Esq. Comr. of
 Locations, Dated
 17 July 1786
 I have admeas
 and laid out unto
 John Champe
 a tract of
 658 acres
 of land situate
 in Spartanburg
 County on Duck
 Creek on
 the N. side of
 the River
 bounded N. by
 James Purvins
 Land E. by
 the above plat
 Represented. Surveyed the 20th July 1786
 Recorded 14th Nov. 1786. Del. John Thomas Esq.

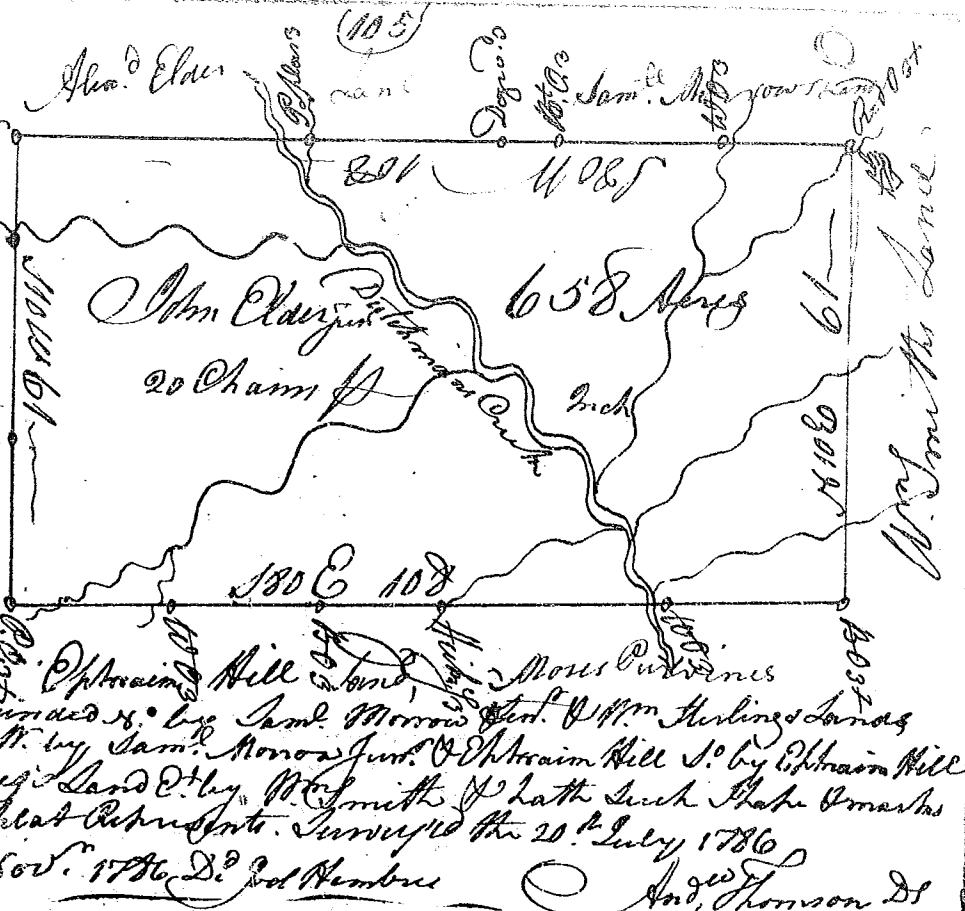

State of South Carolina

Pursuant to a warrant from
 John Thomas Esq. Comr. of
 Locations, I have admeasur
 and laid out unto Greenham
 Crowder a tract of 280 acres of
 land, in 96 district, on both
 sides of the branches of Thom
 -sons Creek of Pacolat river
 hath such shape, Marks, buttings
 and boundings as the above
 Plat Represents. Surveyed the 12th Oct. 1786
 Recorded 14th Nov. 1786. Del. John Thomas Esq.

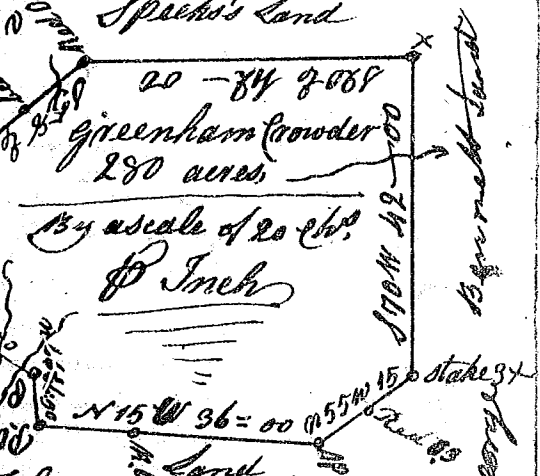

State of South Carolina, Pursuant to a warrant
 from John Thomas Esq. Comr. of Locations
 I have admeasured and laid out unto
 Greenham Crowder a tract of 115 acres of
 land in 96 District, on the branches of
 Thomsons Creek of Pacolat river, and
 hath such shape, Marks, buttings and
 boundings as the above Plat Represents
 -to Subvey, 12th Oct. 1786,
 Recorded 14th Nov. 1786. John Young Esq. Del.
 Del. Mr. Kimball

