

State of South Carolina 9th District

Pursuant to a Warrant from John Thomas Esq. Commissioner of Locations dated 2nd July 1786

I have admeasured and laid out unto Michael Miller a tract of Two hundred acres of land, in Spartanburg County, on the N^o.

side of Tiger River, bounded SW by Wm. M. Mahon's land, NW by Samuel Brien's land, N^o by John Brown's land, Part of the East by Henry Hays's land, S^o by John Nicol's land, and hath such shape & marks as the above Plat Represents, Surveyed 1st July 1786, And. W. Thomson Esq.

Recorded 14th Oct. 1786,

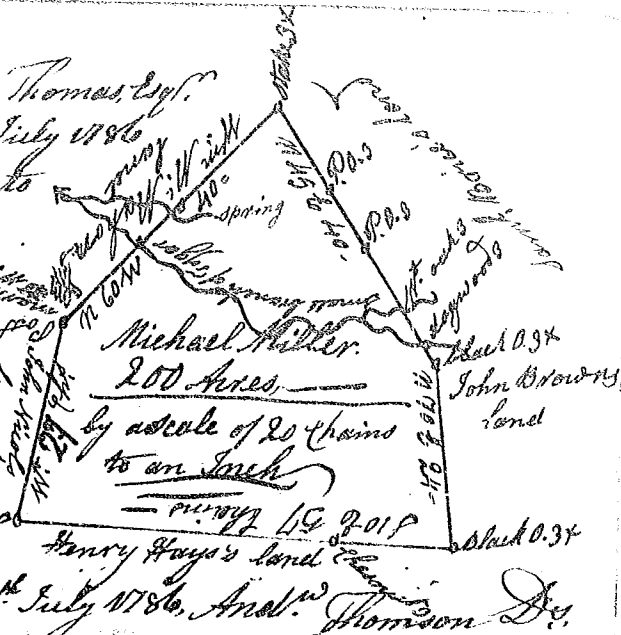

State of S^o Carolina

Pursuant to a warrant from John Thomas Esq. Commissioner of Locations N^o. Saluda. I have admeasured & laid out unto James Miller a tract of four hundred acres of land, on Millers branch of Duncan's Creek in Spartanburg County, having such shape & marks butting & boundaries as the above great Represents. Surveyed the 11th Oct. 1786. Recorded 15th Oct. 1786.

Did the owner

Robert Hanna Esq.



State of S^o Carolina Pursuant to a warrant from John Thomas Esq. Commissioner of Locations N^o. Saluda

I have admeasured & laid out unto Samuel Sara a tract of 90 Acres of land on a small branch of Duncan's Creek in Laurens County, having such form & marks & buttings & boundaries as the above great Represents. Surveyed the 7th Oct. 1786. Recorded the 16th day of Oct. 1786. And. W. Thomson Esq.

Did the owner

Robert Hanna Esq.

