

State Carolina (1777)
 Pursuant to a warrant from John Thomas Esq. Comm. for 96 District 8. S. Carolina River: I have admeasured and laid out unto Owen Jenkins a tract of land containing two hundred & fifty acres situate in District aforesaid 8. of Saluda: on the right bank of that such shape, marks, boundaries & Boun-dings as the annex'd plat represents
 Certified the 4. Oct. 1786 Lewis D.S.
 Recorded this 7. Oct. 1786. Del. Thos. Jenkins Esq.

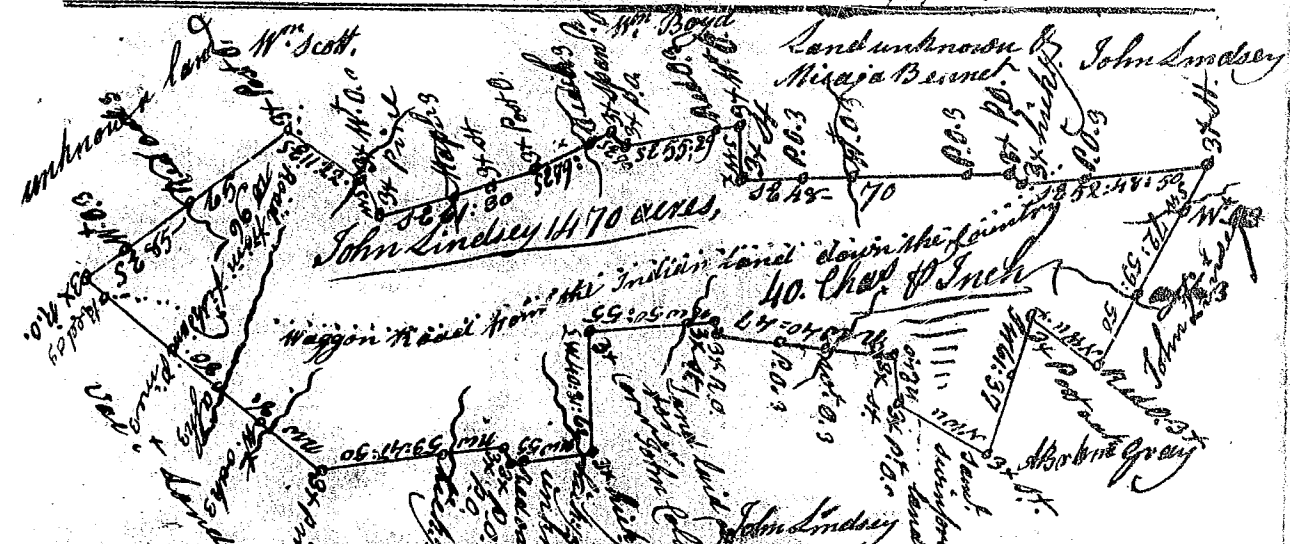
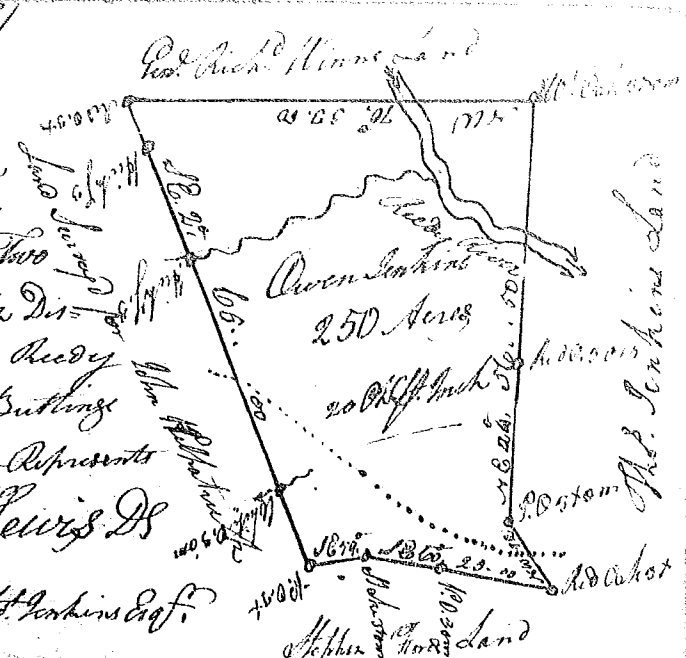

South Carolina
 Pursuant to a warrant from John Thomas Esq. Comm. of locations Dated the 10. day of May 1786, I have admeasured and laid out unto John Lindsey a tract of one Thousand four hundred and seventy acres of land, in Ninety Six District, on the branches of Hedley's and Peterson's Creeks, and that such shape, marks, boundaries and boun-dings as the above Plat represents,
 Surveyed 16. May 1786. Ber. Glenn D.S.
 Recorded 4. Oct. 1786. Del. J. S. Lindsey