

State of S. Carolina

Pursuant to a warrant from John Thomas Esq. Commissioner of locations, dated August 1786, I have all measured and laid out unto William Sharp a tract or parcel of land, of 450 acres on Broad's Creek S. side of broad river Ninety six District, which the above Plot will more fully make appear, surveyed this 5th Aug^r 1786
 Charles Sims Esq.
 Recorded 10th Aug^r 1786
 Del. W. Gilles

(41)

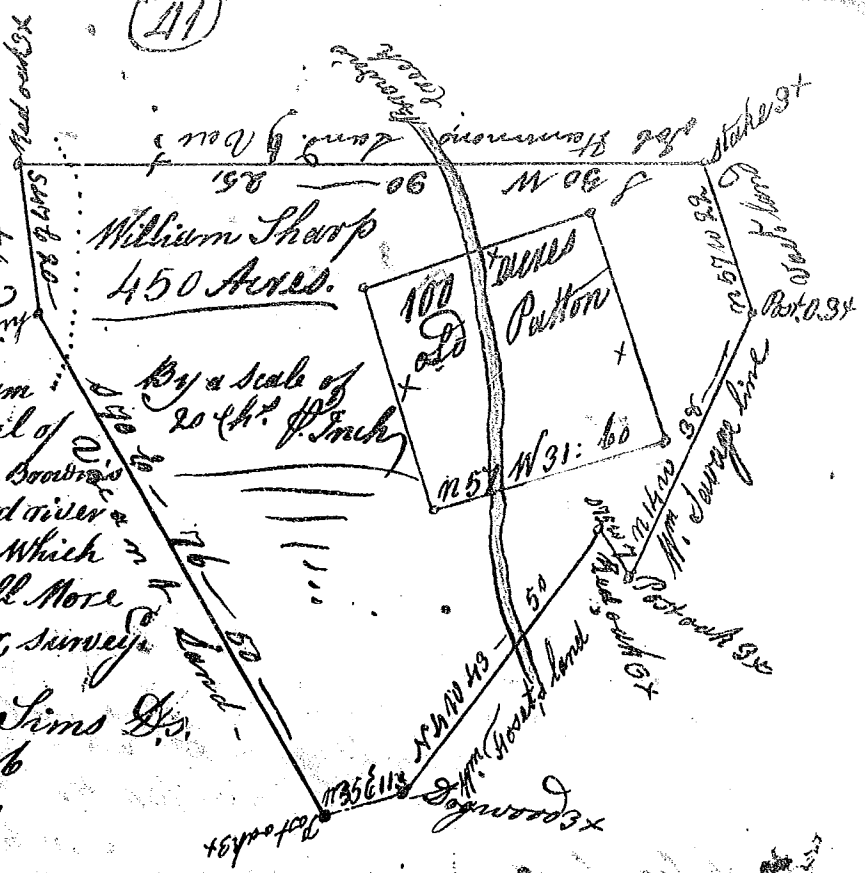

South Carolina

Pursuant to a warrant from John Thomas, the 28 July 1786, I have all measured and laid out unto John Kelly a tract of five hundred acres of land in 96 district on Dry Creek a branch of Enoree river, and hath such shape, marks, buttings & boundaries as the above Plot represents surveyed 10th Aug^r 1786
 Per. Glenn Esq.
 Recorded 12th Aug^r 1786
 Del. self

