

South Carolina

579

Pursuant to a warrant from John Thomas Esq. Commissioner of Locations bearing Date April the 2^d 1786 I have admeasured & Laid out unto Timothy Goodman a Plantation or Part of Land Containing Three Hundred Acres by seven acres situate at Saluda River below the old Indian Line on the Little River bounding SE on Lands of the Whites NE on Lands of Wm Barton & Lands of George SW on Lands of William Manattus & that such State Form Marks as the above Plat Represent to Certified this 12th Day of April 1786

Recorded the 24th of May 1786

Del^d to Joshua Gillam

W. Caldwell D^r



South Carolina

Pursuant to a warrant from John Thomas Esq. Commissioner of Locations bearing Date April the 2^d 1786 I have admeasured & Laid out unto Timothy Goodman a Plantation or Part of Land

Containing one Hundred & Twenty four Acres situate at Saluda River below the Indian Line on the waters of Ray's Creek bounding SE on James Cromwell SW on John Williams NW on old Survey NE on Lands of James Manattus such State Form Marks as the above Plat Doth Represent to Certified this 15th Day of April 1786

Recorded the 24th of May 1786 Del^d to Joshua Gillam

W. Caldwell D^r

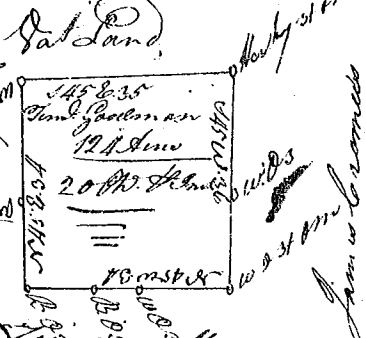

South Carolina Pursuant to a warrant from John Thomas Commissioner of Locations bearing Date March 29th Day of 1786 I have admeasured & Laid out unto Hamilton Muddack a Plantation or Part of Land

Containing Two hundred & fourteen Acres situate at Saluda River below the old Indian Line on the waters of Weaver Dam Creek bounding SE on Lands of William Johnson NW on Lands of Wm Caldwell NE on Lands of James Jones & that such State Form Marks as the above Plat Represent to Certified this 25th of March 1786

Recorded the 24th of May 1786 Del^d to Joshua Gillam

W. Caldwell D^r

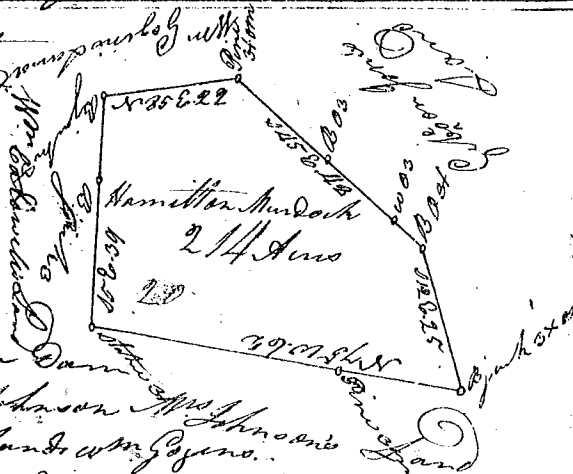

South Carolina Pursuant to a warrant from John Thomas Esq. Commissioner of Locations Dated 2^d Dec^r 1785 I have admeasured and laid out unto Henry Wilson as a Cont^d Soldier a tract of fifty three acres of Land in Laurens County on branches of Saluda River bounding NW on J. H. Mayson, SW on Philip Day NE on William Salmon, having seen boundaries and bounding as are represented in the above Plat, Survey 30th Dec^r 1785 James H. Mayson D^r

Recorded 24th May 1786 Del^d Joshua Gillam

J. H. Mayson D^r

