

State of S^c Carolina
 Pursuant to a warrant from John Thomas Esq^r Commissioner of locations dated 24th March 1786, I have admeasured and laid out unto Amos Speece a tract of Three hundred and sixty seven acres of land, in 96th District on Cuck Creek of Caledon River, and hath such shape, Marks, buttings and Boundings as the above Plat Represents, Survey, 27th March 1786
 W^m Benson D^r

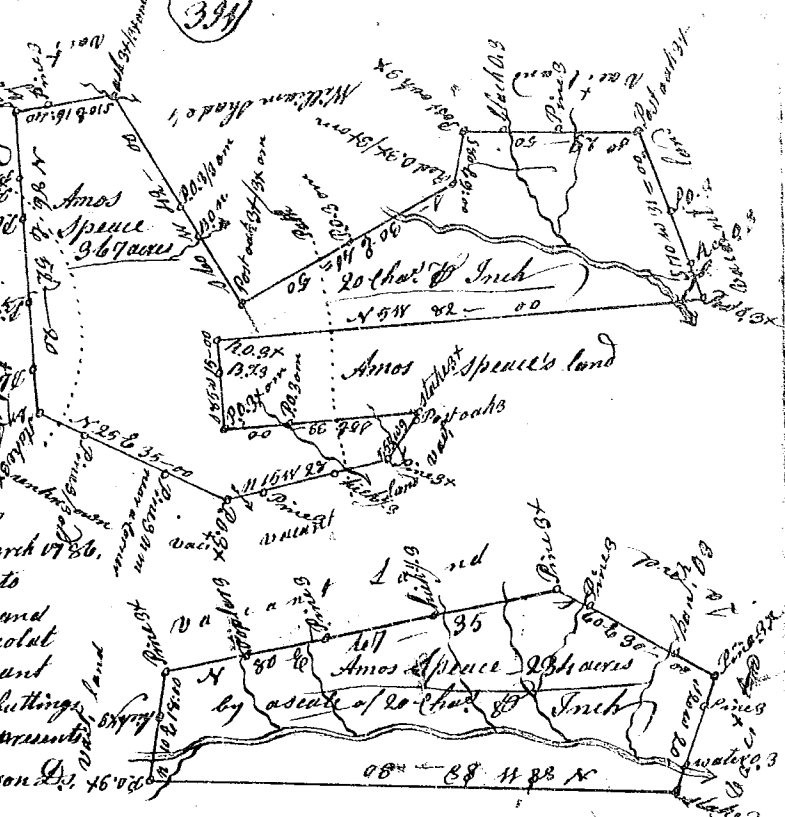

Recorded 17th May 1786,
 State of S^c Carolina Pursuant to a warrant from John Thomas Esq^r Commissioner of locations dated 24th March 1786, I have admeasured and laid out unto Amos Speece a tract of Two hundred and thirty four acres in 96th District, on Caledon River, bounding on all sides on vacant land, and hath such shape, Marks, buttings and boundings as the above Plat Represents, Survey, 25th March 1786
 W^m Benson D^r

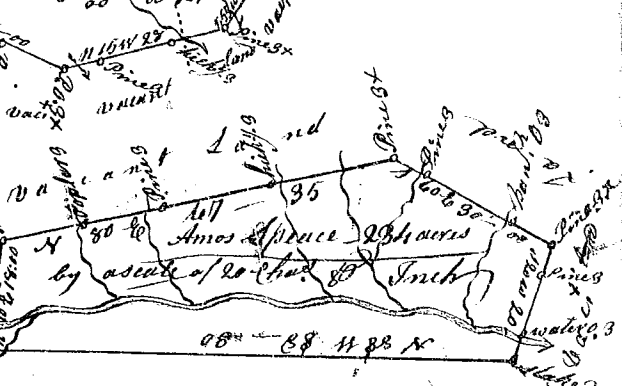

State of South Carolina, Pursuant to a warrant from John Thomas Commissioner of locations, I have admeasured and laid out unto Henry Hughley a tract of sixty five acres of land, in 96th District, on Upper River bounding N^W by on Upper River, N^E by on John Hughley's land, and hath such shape and Marks as the above Plat Represents, Survey, 20th May 1786
 Ferdinand Hopkins D^r

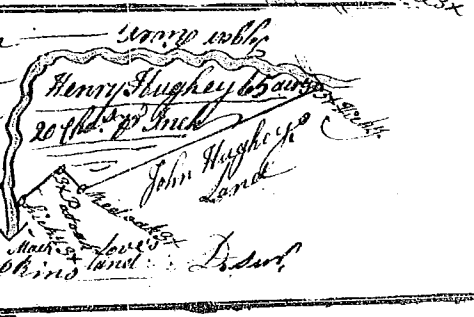

State of S^c Carolina Pursuant to a warrant from John Thomas Esq^r Commissioner of locations, N^c Saluda river I have admeasured and laid out unto William Cooper a tract of Two hundred acres of land for the County, as a soldier, in Laurens County, on the branches of Cane River, having such shape, Marks, buttings and boundings as the above Plat Represents, Survey, 16th Feb^r 1786
 Recorded 22nd May 1786, Robert Hanna D^r



South Carolina, Pursuant to a warrant from John Thomas Commissioner of locations dated 26th April 1786, I have admeasured and laid out unto Robt. Gillum a tract of Three hundred and forty eight acres of land, side Saluda River, betwⁿ the old boundary line on the waters of Saluda, bounding S^W on lands of James Nayson's & Robt. Gillum's N^c on lands of George Skelly & Joseph Goodman's N^c on Robt. Procter, or Frederick Wards lands, and hath such shape and Marks as the above Plat Represents, Survey, 23rd May 1786
 Will. Caldwell D^r

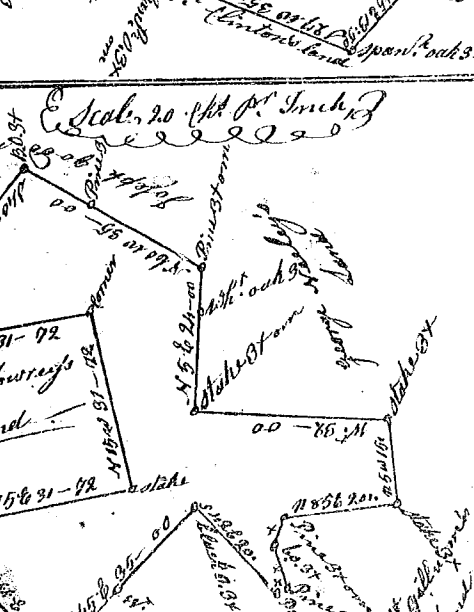

Recorded 23rd May 1786,
 179 Det. Joshua Gillum

