

State of Carolina

(384)

Pursuant to a warrant from the Governor
I have measured & laid out unto Isaac Gregory a tract
of 200 acres of Land situate in Run by the outlet
on Little Brown Creek a branch of Broad River
& hath such shape form & marks buttings &
boundings as the above Plat represents
Recorded the 29th of April 1786

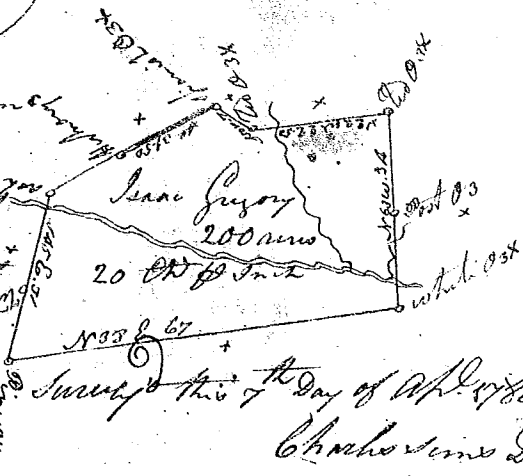

Survey this 7th Day of April 1786
Charles Jones D^y

South Carolina

Pursuant to a warrant from John Thomas Esq^r
Commissioner of Locations dated the 1st day of March 1786
I have admeasured and laid out unto John Means a
Tract of Two hundred and fifty Three acres of land
situate in Ninety six District, on the branches of
second creek, and hath such shape, Marks, buttings
and boundings as the annexed Plat represents,
Survey, 3rd April 1786. Betⁿ Glenn D^y
Recorded 3rd May 1786. Det^y Mr. Symmes

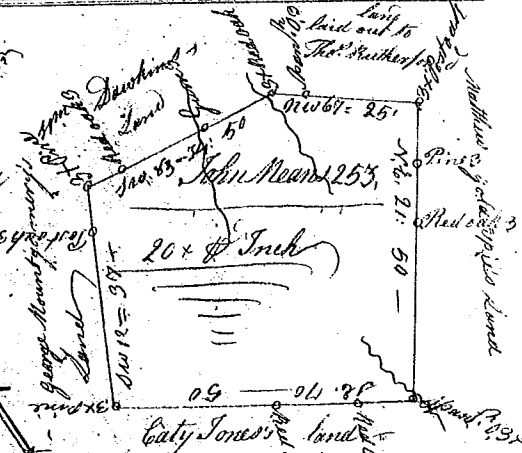

Survey this 7th Day of April 1786
Charles Jones D^y

State of South Carolina

Pursuant to a warrant
from John Thomas Esq^r Commissioner of Locations Dated
the 2nd March 1786, I have admeasured and laid out unto
Simeon Cannon a tract of one hundred and five acres
of land situate in Ninety six District, on both sides
of a branch of the Middle fork of Saluda River, and hath
such shape, form, Marks, buttings and boundings as the
annexed Plat represents, Survey, 16th March 1786,
Recorded 3rd May 1786. Det^y Angel Cannon George Salmon D^y

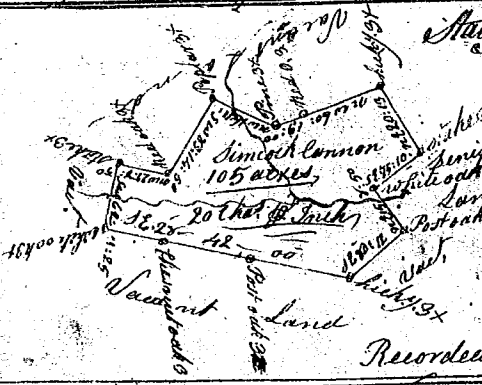

Survey this 16th Day of March 1786
George Salmon D^y

State of South Carolina Pursuant to a warrant from
John Thomas Esq^r Commissioner of Locations dated
the 2nd day of March 1786, I have admeasured and laid
out unto Hupell Cannon a tract of Ninety five acres
of land, in Ninety six District, on the branches of
the Middle fork of Saluda River, and hath such
shape, Marks, buttings & boundings as the above Plat
represents, Survey, 16th March 1786, George Salmon D^y
Recorded 3rd May 1786, Det^y Self

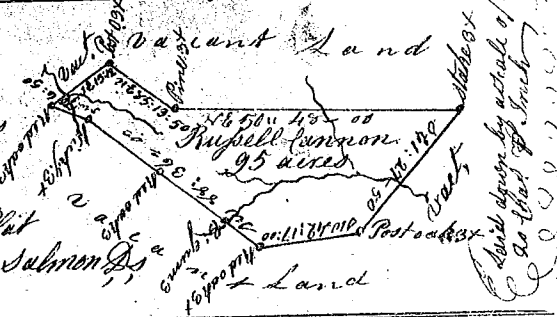

Survey this 16th Day of March 1786
George Salmon D^y

State of South Carolina Pursuant to a warrant from John Thomas
Commissioner of Locations Dated 21st Jan^y 1786, I have admeasured and laid
out unto John Rivers a tract of fifty eight acres of Land, situate
in Ninety six District, on George Woods Creek waters of the
fork of Saluda River, and hath such shape, Marks, buttings and
boundings as the above Plat represents, Survey, 15th Feb^ry 1786,
Recorded 3rd May 1786,
John Young D^y

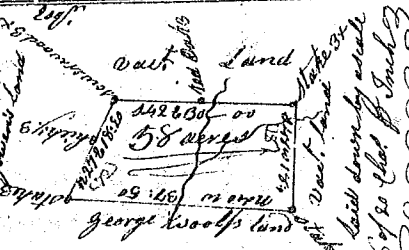

Survey this 15th Day of Feb^ry 1786
John Young D^y

State of South Carolina Pursuant to a warrant from John Thomas
Commissioner of Locations dated 21st Jan^y 1786, I have admeasured
and laid out unto James Groombridge a tract of fifty acres
of land, situate in 96 District on Barnes Branch of the
fork of Saluda River, and hath such shape, Marks, buttings and
boundings as the above Plat represents, Survey, 15th Feb^ry 1786,
Recorded 4th May 1786,
John Young D^y

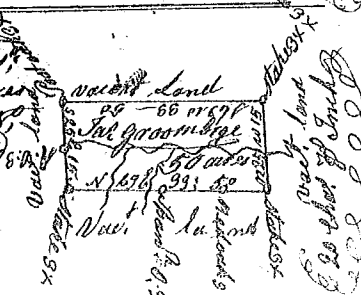

Survey this 15th Day of Feb^ry 1786
John Young D^y