

380
 State of South Carolina 96 District, E. of the old boundary
 Pursuant to a warrant from John Thomas Esq. Commissioner
 of Locations dated the 10th Jan'y 1786, I have admeasured
 and laid out unto John Campbell a tract of Two hundred
 and Eighty four acres of land, on the Sth Side of Sugar
 River, Bounded E^t. by Joel Hembry's land, ~~Wth by~~
~~Wth by Campbell's land~~ Wth by said John
 Campbell's land, S^e by Sugar River, and hath such
 shape and Marks as the above Plat Represents,
 Surveyed 13th Jan'y 1786 Andrew Thomson
 Esq.
 Recorded 10th April 1786,

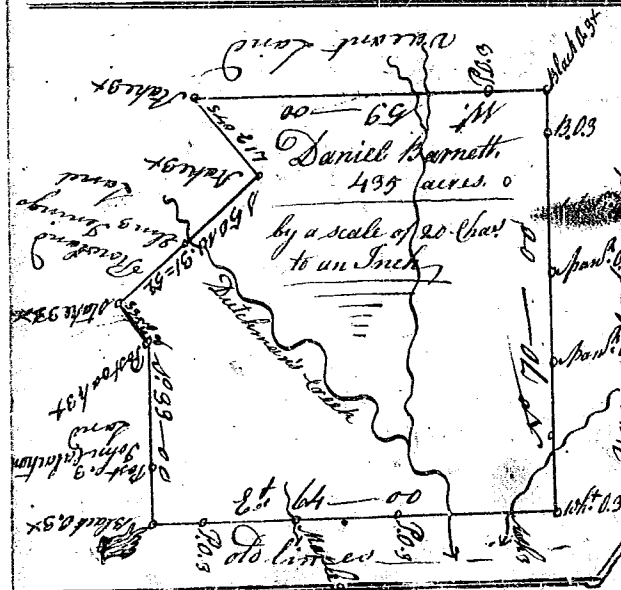

State of S^c. Carolina
 96 district E^t of the old line,
 Pursuant to a warrant from John
 Thomas Esq. Commissioner of Locations Dated 14th March 1786
 I have admeasured and laid out unto Daniel Barnett
 a tract of four hundred and thirty five acres of land
 in Spartanburg County, on both sides of Dutchman's Creek
 on the North side of Sugar River, Bounded S^e by an old
 line, Wth by, by Howland Jennings & John Calachan's lands
 all other sides vacant lands, and hath such form
 and Marks as the above Plat Represents,
 Surveyed 20th March 1786, Andrew Thomson Esq.
 Recorded 10th April 1786,

State of South Carolina Pursuant to a warrant
 from John Thomas Esq. Commissioner of Locations
 of Saluda to me Directed, I have admeasured
 and laid out unto William Morris Esq. a
 tract of of four hundred and fifteen
 acres of land, in ninety six dishes
 on the waters of Thickety Creek a branch of
 Broad River, Bounded S^e by land of Joseph
 Morris N. by land Surveyed by David Hopkins
 Esq. E. by Jones's land S. by Cart Land, and
 hath such shape, form and Marks as the above
 Plat Represents, Surveyed 14th Jan'y 1786,
 Recorded 10th April 1786, Vardry McBee Esq.



State of South Carolina Pursuant to a warrant from
 John Thomas Esq. Commissioner of Locations
 North of Saluda to me Directed I have admeasured
 & Laid out unto Boston Best a Tract of
 hundred & four Acres of Land situated in
 Nine by six Dishes a branch of Rich Creek
 Branch of Charlotte Bounded south by Joseph
 Land and all other Parties by Vacant Land &
 hath such shape form & Marks as the above
 Plat Represents Surveyed this 14th Day of January 1786
 Vardry McBee Esq.

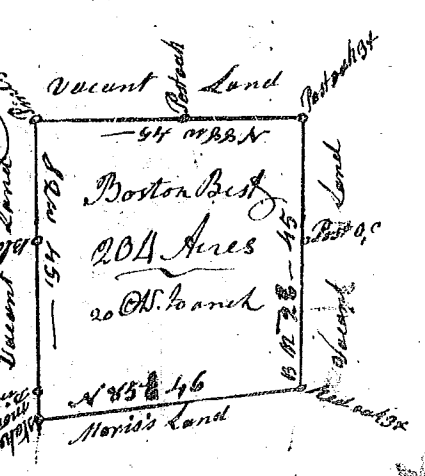

Recorded the 10th of April 1786
 Vardry McBee Esq.