

State of South Carolina, Ninety six District, E. of old boundary
 Pursuant to a warrant from John Thomas Esq. Commissioner of Locations dated 28th Nov. 1785, I have admeasured and laid out unto William Bramlet a tract of Three hundred and eighty seven acres of land, on the south side of Enoree River, on the small branch of ^{various creek} ~~is~~ of Beaverdam Creek, bounded N. E. by the W. M. Bramlet's land, all other sides by vacant land and hath such shape and Marks as the above Plat Represents, Survey: 24th Jan^y 1786. And: Thomson D.
 Recorded 5th April 1786.

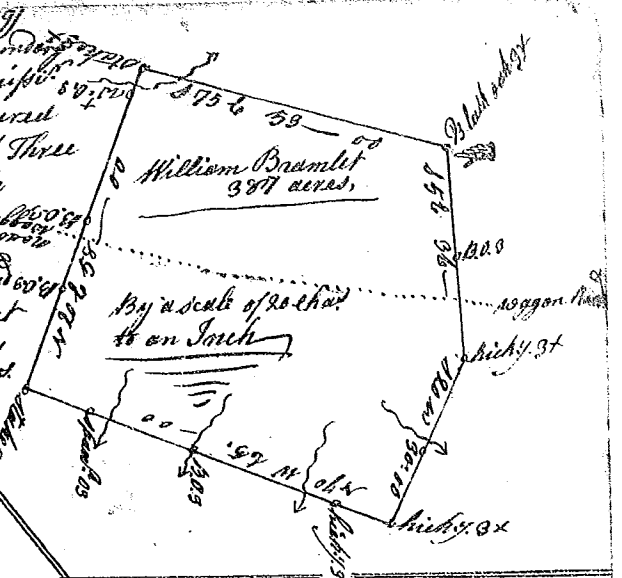

State of S. Carolina 96 District E. of old boundary
 Pursuant to a warrant from John Thomas Commissioner of Locations dated 1st Jan^y 1786 I have admeasured and laid out unto John Bennett a tract of Two hundred & Ninety acres of Land, on both sides of Dutchmans Creek — bounded E. & S. by land laid out for Absolom Langston, all other sides vacant Land, and hath such shape and Marks as the above Plat Represents, Survey: 24th Jan^y 1786. by Andrew Thomson D.
 Recorded 5th April 1786.

State of South Carolina 96 District E. of the old line
 Pursuant to a warrant from John Thomas Esq. Commissioner of Locations Dated 6th Feb^ry 1786, I have admeasured and laid out unto Joseph Barnett a tract of four hundred and forty five acres of land in Spartanburg County, on the north side of Enoree River, on both sides of Two mile creek a branch of said Enoree river, bounded E. & S. by Wm. Phillips land & Isaac Hendricks land, S. by an old line the owners unknown to us, W. by, by Andrew Hendricks land, N. by, by William Barnett's land, And: hath such shape and Marks as the annexed Plat Represents, Survey: 10th Feb^ry 1786, Recorded 16th April 1786. Andrew Thomson D.

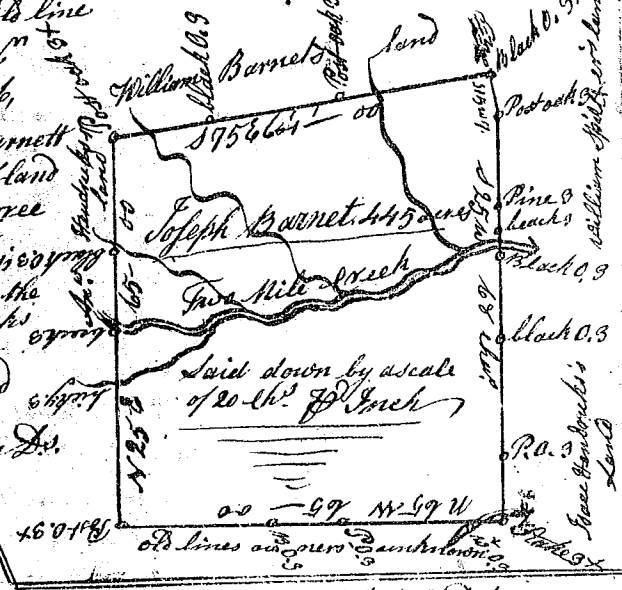

State of South Carolina, 96 District, E. of 1st S. D. boundary
 Pursuant to a warrant from John Thomas Esq. Commissioner of Locations dated 14th Jan^y 1786, I have admeasured and laid out unto Jacob Earnest a tract of one hundred and sixty acres of land, in Spartanburg County, on the south side of Sugar River, bounded N. E. by James Crow's land westwards by Robert Rogers's land, S. by John Crow's & James Sloan's lands, E. by Thomas White and Tigger Kinder, and hath such shape form & Marks as the above Plat Represents, Survey: 11th March 1786, by Andrew Thomson D.
 Recorded 16th April 1786.

South Carolina. Pursuant to a warrant from John Thomas Esq. I have admeasured and laid out unto J. M. Master a tract of 78 acres of land situate in 96 District below the Old Boundary, on the waters of Cannon's Creek, hath such shape marks & Buttins & Boundings as the annexed Plat Represents Survey: this 24th Jan^y 1786.
 Recorded this 22nd March 1786 by the owner J. Dougherty D.

