

State of South Carolina Pursuant to a warrant from  
 John Thomas Esq. Commissioner of Locations, dated the  
 17<sup>th</sup> Jan'y. 1786 I have admeasured and laid out unto  
 David Brown a tract of Two hundred and eight acres  
 of land in Ninety six district, on the branches of  
 Needy River & branches of Roundings Creek, and  
 hath such shaps, form & Marks, cuttings and  
 boundings as the above Plat Represents,

Survey'd 23<sup>rd</sup> Jan'y. 1786  
 Recorded 14<sup>th</sup> March 1786, Wm. Brown Esq.  
 S. M. Maston,

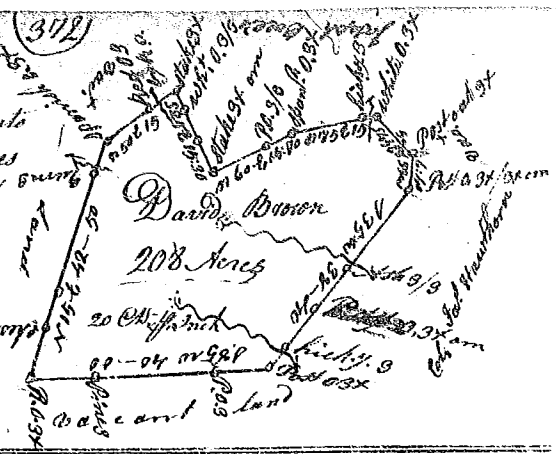

State of South Carolina 96 District

Pursuant to a warrant from John  
 Thomas Esq. Commissioner of Locations Dated the 22<sup>nd</sup>  
 Dec<sup>r</sup> 1785, I have admeasured and laid out unto  
 Samuel Rice a tract of one hundred and sixty acres  
 of land, in Spartanburg County, on both sides of the  
 north fork of Tyger River, Bounded S<sup>e</sup>. by now McMahons  
 land Michael Miller's lands, W<sup>d</sup>. by the Middle fork of  
 Tyger River & John Cadwells land, all other sides  
 by vacant land, and hath such shaps, Marks and form as the  
 above Plat Represents, Recorded 15<sup>th</sup> March 1786,

Survey'd 9<sup>th</sup> Jan'y. 1786 Andrew Thomson Esq.

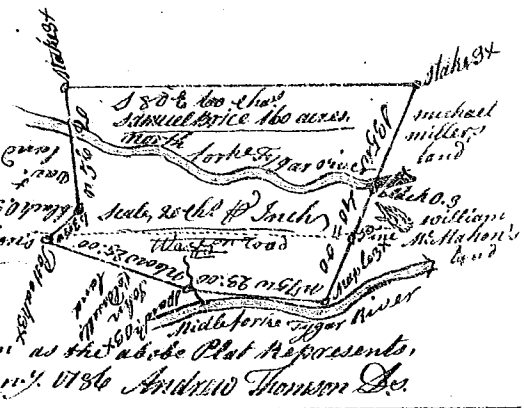

State of South Carolina Pursuant to a warrant  
 from John Thomas Esq. Comm<sup>r</sup> of Locations Dated the  
 23<sup>rd</sup> day of Jan'y 1786, I have admeasured & laid out  
 unto Robert Bean a Tract of one hundred & twenty  
 acres of land, Situation 96 district on the N<sup>e</sup>. side Saluda  
 River, hath such shaps marks cuttings & boundings the  
 above plat Represents. Survey'd the 17<sup>th</sup> Jan'y. 1786 Geo. Salmon Esq.  
 Recorded this 15<sup>th</sup> March 1786

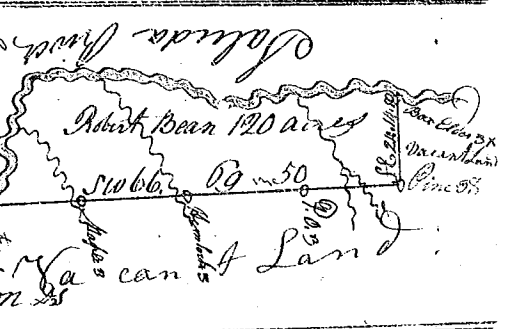

State of S<sup>c</sup> Carolina Pursuant to a warrant from  
 John Thomas Esq. Comm<sup>r</sup> Locations, I have admeasured  
 & laid out unto Landon Farrow a Tract of one hundred  
 & thirty acres of land, on Enoree River, in Laurens  
 County. Having such shaps marks cuttings & bound  
 ings as the above plat & Represents  
 Survey'd the 18<sup>th</sup> Feb'y. 1786  
 Recorded this 16<sup>th</sup> March 1786 Robert Hanna Esq.

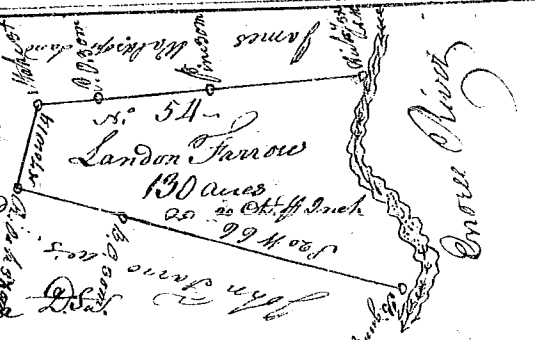

State of S<sup>c</sup> Carolina Pursuant to a  
 warrant from John Thomas Esq. Comm<sup>r</sup> of Locations  
 I have admeasured & laid out unto Landon  
 Farrow a Tract of 110 acres of land on Enoree  
 River in Laurens County Having such shaps  
 marks & the above plat & Boundings as the  
 above plat Represents. Survey'd the 17<sup>th</sup> Feb'y. 1786  
 Recorded this 15<sup>th</sup> March 1786 Robert Hanna Esq.

