

State of South Carolina,

370

Pursuant to a warrant from John Thomas Esq. Commissioner of locations, dated the 25th day of Dec. 1785, I have admeasured and laid out unto Michael Muellevorath tract of four hundred acres of land, on the small branches of the North fork of Saluda River, and the small branches of fall creek bounded on all sides by vacant land, and hath such shape, form & marks as the annexed Plat Represents, Survey: 25th day Dec. 1786
Recorded 10 March 1786. And^o Thomas Esq.

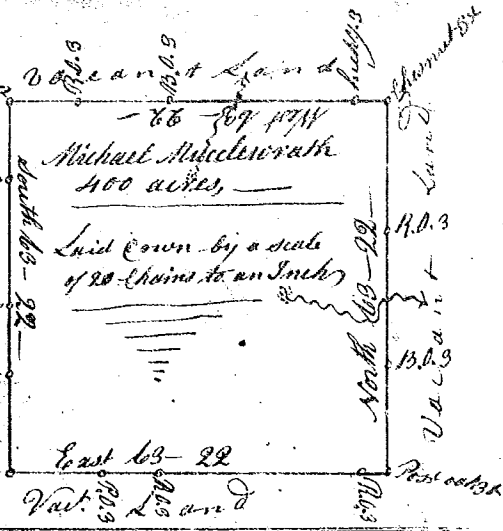

State of South Carolina,

Pursuant to a warrant from John Thomas Esq. Commissioner of locations, Dated the 16th day of Feby. 1786, I have admeasured and laid out unto Henry branch tract of five hundred and Ten acres of land, situate in ninety six District above the old boundary on both sides of Folkenborough's beaver Dam of Middle fork of Tugar River, and hath such shape, marks, buttings and boundings as the above Plat Represents, Survey: the 16th Feby. 1786, Joseph Whitner Esq.
Recorded 11th March 1786.

State of South Carolina, Pursuant to a warrant from John Thomas Esq. Commissioner of locations dated the 16th feby. 1786 I have admeasured and laid out unto Thomas Wadsworth and William Serpin tract of six hundred and seventy acres of land, situate in ninety six district on both sides of Childers's beaver dam creek of Tugar river, and hath such shape, marks, buttings & boundings as the above Plat Represents, Survey: 16th feby. 1786. Recorded 11th March 1786, George Salmon Esq. Delivered to Tho^s Wadsworth



State of South Carolina Pursuant to a warrant from John Thomas Esq. Commissioner of locations Dated the 14th Jan^y 1786, I have admeasured and laid out unto John Ruper tract of one hundred and thirty two acres of land, situate in ninety six District above the old boundary, on branches of the North fork of South Tugar River, and hath such shape, marks, buttings & boundings, as the above Plat Represents, Survey: the 22nd feby. 1786. Recorded the 11th March 1786, Joseph Whitner Esq.

