

State of N. Carolina
 Pursuant to a Warrant from
 John Thomas Esq. Commr. of Land
 I have Admeasured & laid out
 unto Spencer Robo a Tract of
 Four Hundred & Forty Six
 Acres of Land on the Forks of
 the Branches of Cedar Creek in
 Spartansburg County having
 such Shape Marks & Boundings
 as the Above Plan
 Represents Surveyed this 7th
 Day of February 1786
 Robert Hanna Esq.
 Recorded this 7th February 1786

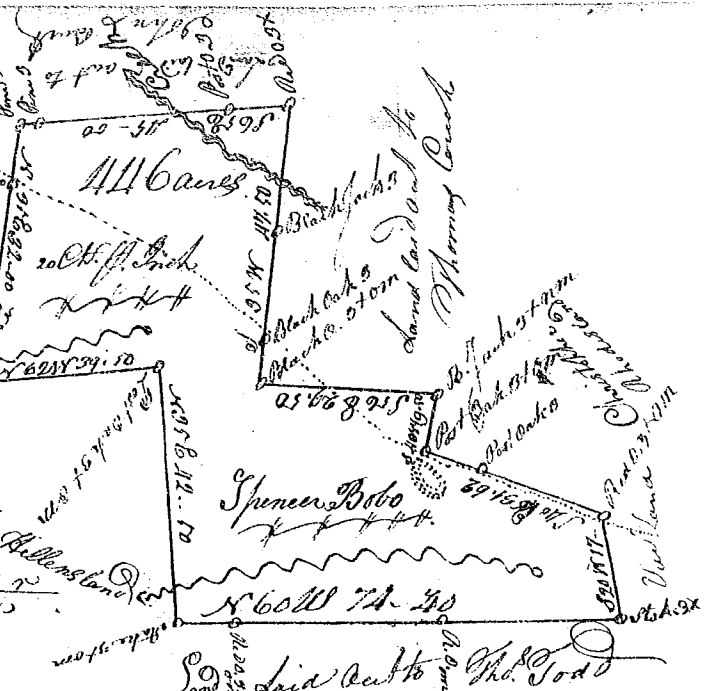

State of N. Carolina. Pursuant to a Warrant
 from John Thomas Esq. Commr. of Land Dated
 the 21st Oct. 1785. I have Admeasured & laid
 out unto Henry Store a Tract of Land con-
 taining 200 Acres situate in the District on
 the Branches of Buck horn creek & branches of
 Wolf Creek of Enore River bounded on all
 sides on Vacant Land & hath such Shape and
 marks as the Above Plan Represents
 Surveyed this 8th Feb. 1786
 Recorded this 10th Feb. 1786



Lawrens County. Pursuant to a Warrant from
 John Thomas Esq. Comr. dated the 19th Oct. 1785. I have
 Admeasured & laid out unto Richard Brown a
 Tract of Two Hundred Acres of Land Above the old
 Boundary on Mountain Creek of Saluda River
 bounded on all sides on land not known to be vacant
 Land & hath such Shape and marks as the Above
 Plan Represents Surveyed this 25th Oct. 1785
 Recorded this 16th Feb. 1786
 John Rodgers Esq.
 Ed. P. W. Charles Sullivan

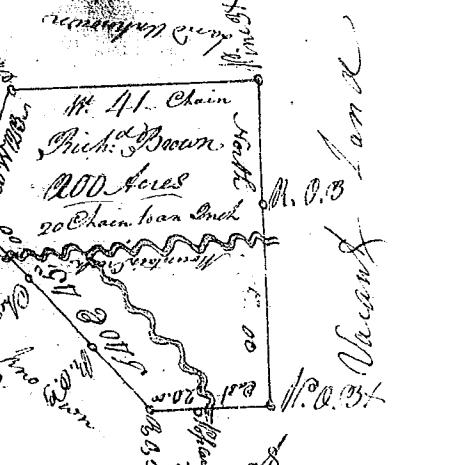

Lawrens County. Pursuant to a warrant from John Thomas
 Esq. Commr. of Land Dated the 10th Oct. 1785. I have admeasured
 & laid out unto Nathan Camp a Tract of 100 Acres
 of Land below the old Boundary on the East side of Needy
 River, bounded on all sides on land held by Elisha Hall & on John
 Mellons & W. on said River & hath such Shape & marks as
 the Above Plan Represents Surveyed this 10th Oct. 1785
 Recorded this 16th Feb. 1786
 John Rodgers Esq.
 Ed. P. W. Charles Sullivan

