

State of S^c Carolina Pursuant to a Warrant from (335)
 John Thomas Esq^r Dated the 10th Dec^r 1785. I have
 admeasured and laid out unto James Davenport a tract
 of one hundred and Twelve Acres of land situated in the
 96 District on Waters of Broad River of that such shape
 marks Buttings & Boundings as the above plat
 Represents Surveyed this 15th Dec^r 1785

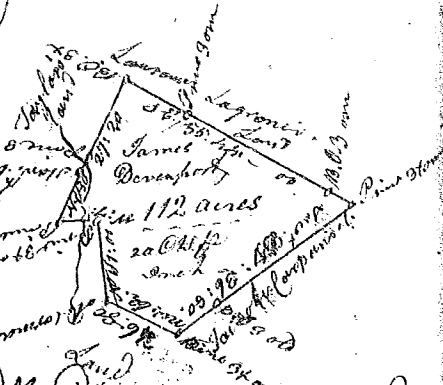

Recorded this 3rd Feb^r 1786 Dit^o the owner
 S^c Carolina Pursuant to a Warrant from John
 Thomas Esq^r Dated the 10th Dec^r 1785. I have admeasured & laid
 out unto James Davenport a tract of 90 acres of land
 situated in 96 District on Waters of Little River of that
 such shape marks Buttings & Boundings as the above plat
 Represents Surveyed this 14th Dec^r 1785 J. Wright Esq^r

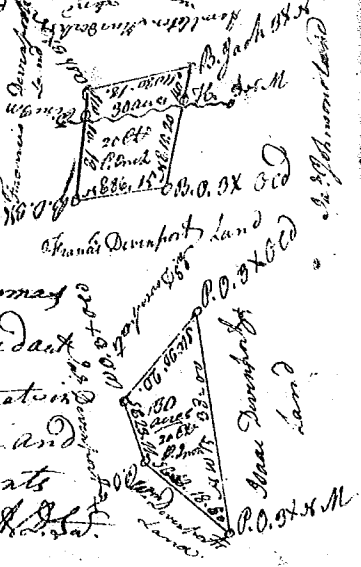

Recorded this 3rd Feb^r 1786 Dit^o the owner
 State of S^c Carolina Pursuant to a Warrant from John Thomas
 Esq^r Dated the 10th Dec^r 1785. I have admeasured & laid out
 unto James Davenport a tract of 90 acres of land situated in
 96 District on Waters of Little River of that such shape and
 marks Buttings & Boundings as the above plat Represents
 Surveyed this 15th Dec^r 1785 by Joseph Wright Esq^r
 Recorded this 3rd day of Feb^r 1786 Dit^o the owner

State of S^c Carolina 96 District N. of Saluda River East of the
 Old Boundary Pursuant to a Warrant from John
 Thomas Esq^r Dated the 26th Jan^y 1786 I have
 admeasured & laid out unto Benjamin Rainey a tract
 of 67 acres of land situated being on a small
 branch of Enore River W. by Edward Cassland S. by
 Benj. Raineys land East by Hollibonys Cowes land & that
 such shape from y^e marks as the above plat Represents Surveyed the 16th Feb^r 1786

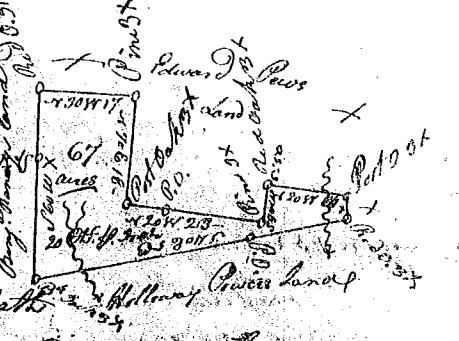

Recorded this 7th February 1786 Dit^o John Howard James Wofford Esq^r

State of S^c Carolina 96 District East of the ancient Boundary line &c
 Pursuant to a Warrant from John Thomas Esq^r born of Locations Survey
 date the 2nd Jan^y 1786, I have admeasured and laid out unto Millington
 Smith a tract of land containing fifty acres lying on a small
 branch of Cain Creek Waters of Tyger River bounded NW by Sam^l
 Cithards land &c & by land laid out to Francis Thomas the other two sides
 vacant & that such shape & marks as the above plat Represents
 Surveyed this 28th January 1786 by Andrew Thomson Esq^r
 Recorded this 7th February 1786 Delivered Joel Hembree

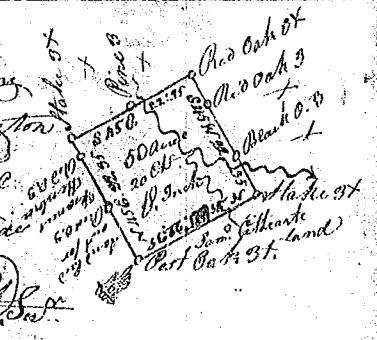

State of S^c Carolina Pursuant to a Warrant from John Thomas
 Esq^r Dated the 15th Nov^r 1785. I have admeasured & laid
 out unto William Savage a tract of land containing
 171 Acres. Situate in 96 District on Enore River
 of that such shape & marks Buttings & bounding
 as the above plat Represents. Surveyed this 9th Feb^r 1786
 Recorded this 10th Feb^r 1786
 Dit^o the owner

