

State of S^c Carolina

Pursuant to a warrant from John Thomas Esq^r Commissioner of locations Dated the 25th Jan^y 1786 I have admeasured and laid out unto George Bruton a tract of one hundred and Ninety two acres of land on Harris's branch, waters of Tigger river, bounded S^{ly} by S^c Norman, E^{ly} by Isaac Lockard, N^w by Rich^d Harris's all other sides by Vacant land, and hath such shape and Marks as the above Plat Represents, Surveyed 26 Jan^y 1786, Abel Pearson D^e Surveyor
Recorded 27th Jan^y 1786 Det. Sam. Bruton

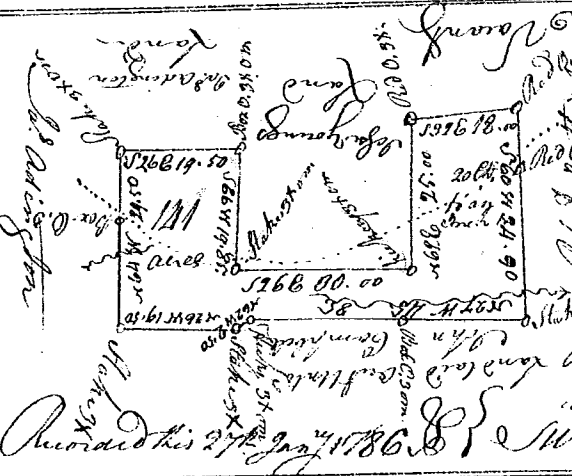
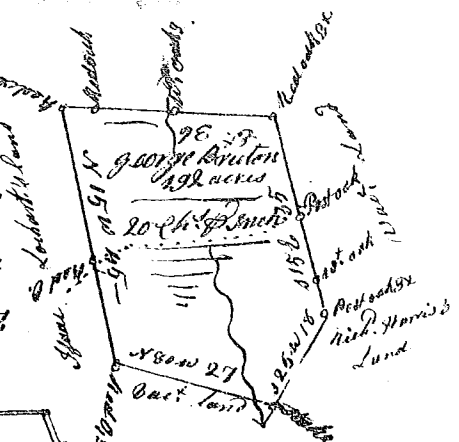

State of S^c Carolina

Pursuant to a warrant from John Tho^s Esq^r Commissioner of locations Dated the 9th Nov^r 1785 I have admeasured and laid out unto John Young a tract of 101 acres of land on the arms of the Tigger River in 9th District below the ancient limits & hath such shape marks buttings and Boundings as the above plat Represents Surveyed 10th Nov^r 1785 Abel Pearson D^e Surveyor
Recorded this 27th Jan^y 1786

State of South Carolina

Pursuant to a warrant from John Thomas Esq^r Commissioner of locations N^o of Saluda river dated 3rd Jan^y 1786, I have admeasured and laid out unto John Burges a tract of 100 acres of land, in Union County, 6th District below the old boundary, on a small Draught of Tigger river call^d Timber Creek, and hath such shape and Marks as the above plat Represents, Surveyed 1st Jan^y 1786, Abel Pearson D^e Surveyor
Recorded 28th Jan^y 1786

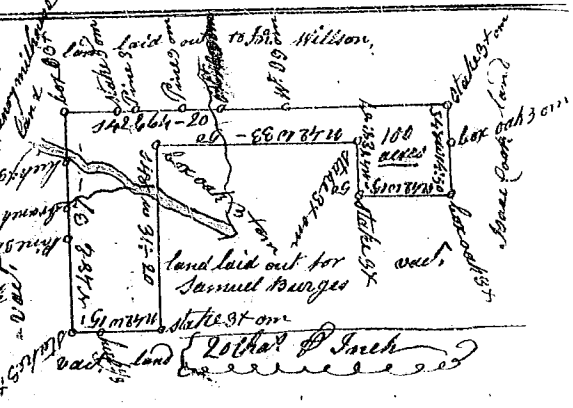

State of South Carolina

Pursuant to a warrant from Thomas Esq^r Commissioner of locations in 6th District N^o Saluda river Dated 26 Jan^y 1786, I have admeasured and laid out unto Abner Cain a tract of 150 acres of land in Union County 6th District below the ancient limits on a small branch of Paget's Creek a tract of Tigger river, and hath such shape, Marks, buttings and boundings as the above Plat Represents, Surveyed 25th Jan^y 1786 Abel Pearson D^e Surveyor
Recorded 28th Jan^y 1786



State of S^c Carolina

Pursuant to a warrant from John Thomas Esq^r Commissioner of locations in 6th District N^o Saluda river Dated 26 Jan^y 1786, I have admeasured and laid out unto John Nix a tract of 397 acres of land in Union County 6th District below the ancient limits on three small branches running into Enoree River, and hath such shape, Marks, buttings and boundings as the above Plat Represents, Surveyed 25th Jan^y 1786 Abel Pearson D^e Surveyor
Recorded 28th Jan^y 1786

