

State of S<sup>c</sup> Carolina, Pursuant to a warrant from John Thomas Comm<sup>r</sup> of Locations for 96 District N<sup>o</sup> of Saluda Dated 5<sup>th</sup> Jan<sup>y</sup> 1786, I have admeasured and laid out unto Samuel Fleming tract of forty seven acres of land situate in 96 District on the waters of Enoree river, bounded on all sides as are above mentioned, and hath such shapes and Marks as the above Plat Represents, Surveyed the 5<sup>th</sup> Jan<sup>y</sup> 1786, by William Hunter Esq. Recorded 16<sup>th</sup> Jan<sup>y</sup> 1786. Del<sup>d</sup> W<sup>m</sup> Fleming

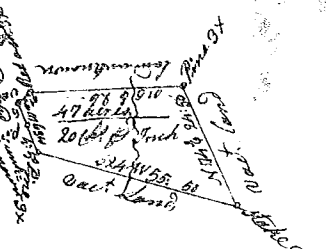

State of S<sup>c</sup> Carolina Pursuant to a warrant from John Thomas Esq<sup>r</sup> Commissioner of Locations, I have admeasured and laid out unto Thomas Gordon tract of 400 acres of land, situate in ninety six Dis<sup>t</sup> - trict on the south side of Broad - river, and hath such shapes & Marks & form, buttings & boundaries as the above Plat Represents, Surveyed the 10<sup>th</sup> Jan<sup>y</sup> 1786, Charles Sims Esq. Recorded 16<sup>th</sup> Jan<sup>y</sup> 1786.

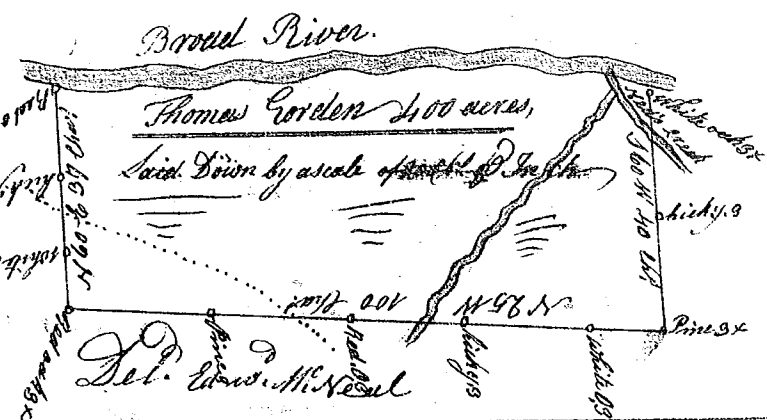

State of S<sup>c</sup> Carolina 96 District N<sup>o</sup> of Saluda W<sup>o</sup> of the old boundary, Pursuant to a warrant from John Thomas Esq<sup>r</sup> Commissioner of Locations dated 14<sup>th</sup> Jan<sup>y</sup> 1786 I have admeasured and laid out unto John Huggins tract of four hundred and fifty seven acres of land, on branches of the golden Grove, waters of Saluda river, bounded S<sup>o</sup> by Henry Pendleton's land, N<sup>o</sup> by W<sup>m</sup> Armstrong's land, all other sides by vacant land, and hath such shape, form and Marks as the above Plat Represents, Surveyed the 16<sup>th</sup> Jan<sup>y</sup> 1786, James Wofford Esq. Recorded 16<sup>th</sup> Jan<sup>y</sup> 1786. Del<sup>d</sup> himself

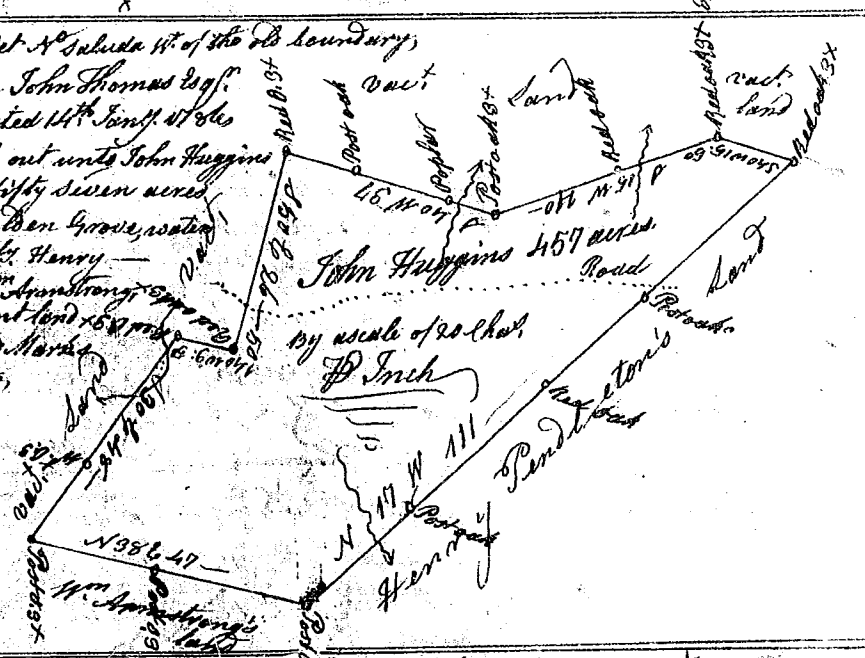

State of S<sup>c</sup> Carolina Pursuant to a warrant from John Thomas Esq<sup>r</sup> Comm<sup>r</sup> of Locations in 96 District N<sup>o</sup> of Saluda I have admeasured & laid out unto James Cator a tract of 187 acres of land, on a branch of Cummins Creek below the Indian Boundary, bounded E<sup>o</sup> on W<sup>m</sup> Deacons land, W<sup>o</sup> on W<sup>m</sup> Deacons land, N<sup>o</sup> on James McEachens land & all other sides on vacant land & hath such shapes & marks as the above plat Represents, Surveyed the 24<sup>th</sup> day of Dec<sup>r</sup> 1785 by Robert Hanna Esq. Recorded the 16<sup>th</sup> Jan<sup>y</sup> 1786.

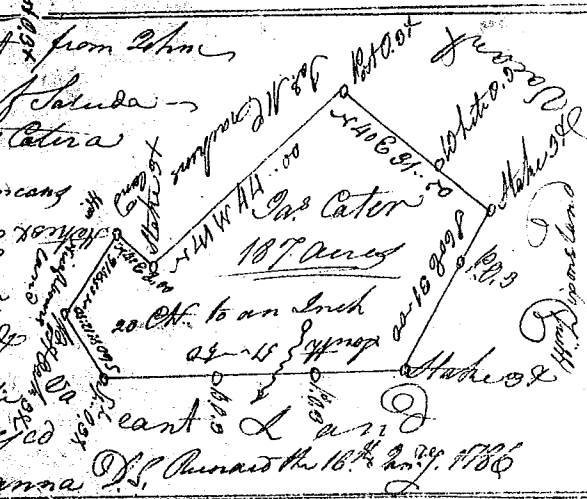

State of S<sup>c</sup> Carolina Pursuant to a warrant from John Thomas Esq<sup>r</sup> Comm<sup>r</sup> of Locations N<sup>o</sup> of Saluda Dated the 18<sup>th</sup> Dec<sup>r</sup> 1785. I have admeasured & laid out unto Isaac Cooke a tract of 50 acres of land, Situate in 96 Union County & 96 District below the Ancient Limits on the East side of Coker Creek & on a smaller Creek called Swift Run the waters of Tyger river & hath such shape, form, buttings & boundaries as the above plat Represents, Surveyed the 18<sup>th</sup> Dec<sup>r</sup> 1785.



Recorded this 16<sup>th</sup> January 1786 Del<sup>d</sup> Isaac Cooke