

State of S^c Carolina

Pursuant to a warrant from John Thomas Esq^r Commissioner of locations, Dated the 28th Nov^r 1785, I have admeasured, and laid out unto Ethy Meeks a tract of four hundred and seventy acres of land above the old boundary on a branch call Mountain Creek waters of Saluda River, bounding E. on lands of Ethy Meeks, S. not known, all other sides by vacant lands, and hath such shape form and Marks as the above Plat Represents,
 Survey, 25 Nov^r 1785,
 Recorded 5th Jan^y 1786 John Rodgers

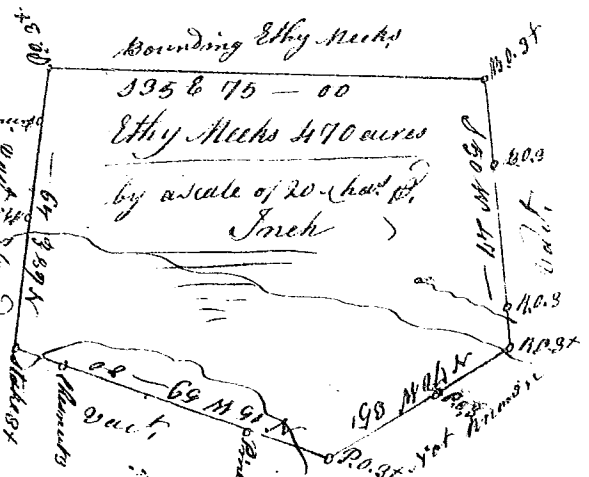

State of S^c Carolina Pursuant to a warrant from John Thomas Commis^r of locations in 9th District N^e Saluda, I have admeasured and laid out unto John Martinell a tract of land of two hundred and seven acres, on Enoree river, below the Indian boundary, bounding N.W. & S. Part on land laid out to John Briggs & Part on land laid out to John Vickerman, all other sides on vacant land, and hath such shape and Marks as the above Plat Represents, Survey, 30 Dec^r 1785
 Recorded 6th Jan^y 1786, J. D. Allen

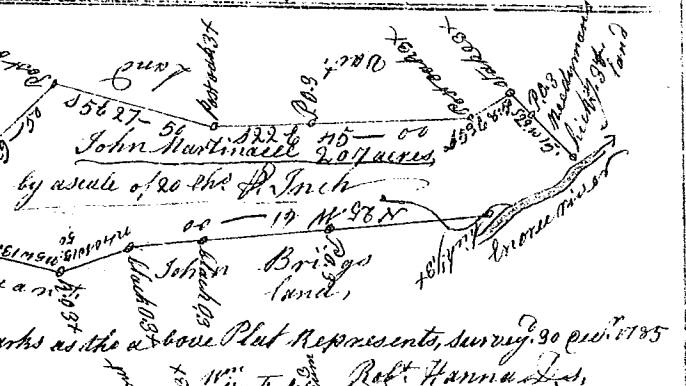

State of South Carolina Pursuant to a warrant from John Thomas Commissioner of locations in 9th District N^e Saluda river, I have admeasured and laid out unto John Martinell a tract of one hundred & twenty four acres of land on Enoree river below the Indian boundary, bounding on Rich^d Chesney, Henry Adington, John Adington, Walter Roberts, John Martinell, J^r & Waggott, and other surveys, and hath such shape & Marks as the above Plat Represents,
 Survey, 26th Dec^r 1785 Rob^t Hanna
 Recorded 6th Jan^y 1786, J. D. Allen



State of S^c Carolina Pursuant to a warrant from John Thomas Esq^r Commissioner of locations N^e Saluda river I have admeasured and laid out unto John Martinell a tract of eighty six acres of land on a branch of Enoree river below the Indian boundary, bounding W. on Tho^s Docters land, S. & E. on Rich^d Chesney Harris land, and all other sides on vacant land, and hath such shape and Marks as the above Plat Represents, Survey, 30th Dec^r 1785 Rob^t Hanna
 Recorded 6th Jan^y 1786, J. D. Allen



State of S^c Carolina Pursuant to a warrant from John Thomas Com^r of locations in 9th District N^e Saluda, I have admeasured and laid out unto Charles Kelly a tract of one hundred acres of land, on the South side of Enoree river in Lawrence County, bounding S.W. on Robert Templeton's land N.W. by John Campbell's land all other sides by vacant land and hath such shape and Marks as the above Plat Represents
 Survey



Survey, 26th Dec^r 1785, Rob^t Hanna
 Recorded 6th Jan^y 1786 J. D. Allen