

State of S^c Carolina, Pursuant to a warrant from John Thomas Esq^r Commissioner of locations dated the 11th Nov^r 1785, I have admeasured & laid out unto Reubin Mathis a tract of land containing two hundred & thirty seven acres, situate in Ninety Six District East of the Indian boundary line, on the West side of Pacatae river, bounded N.W. by Col. W^m Wofford's land, N.E. by John Conner's land, all other sides by vacant land, and hath such shape & marks as the above Plat represents, Survey, 17th Nov^r 1785, Recorded 3rd Jan^y 1786, Jesse Connell Esq.

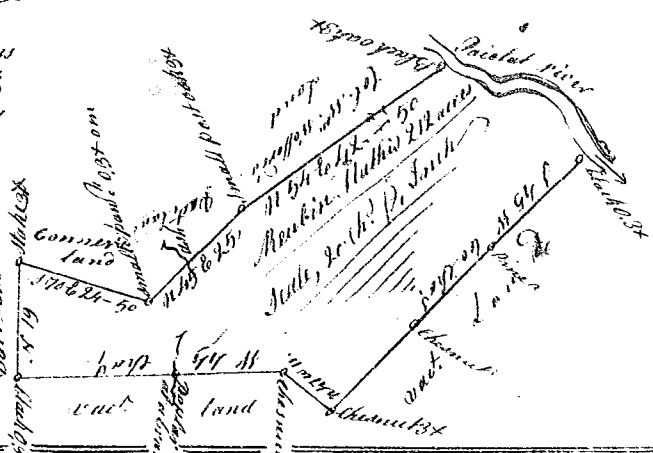

State of S^c Carolina, Pursuant to a warrant from John Thomas Esq^r Commissioner of locations granted 20th Oct^r 1785, I have admeasured and laid out unto Bazel Lee a tract of land containing two hundred & seventy three acres situate in 96 District, on a branch called Chincopin, a branch of Lawson's fork east of the Indian boundary line, bounded E. by wells Griffith's land & Larkin grants land, S.E. by Thomas Nowson's land, all other sides by vacant land and hath such marks and shapes as the above Plat represents, Survey, 6th Dec^r 1785, Jesse Connell Esq., Recorded 3rd Jan^y 1786,



State of S^c Carolina, Pursuant to a warrant from John Thomas Esq^r Commissioner of locations dated the 29th Dec^r 1785, I have admeasured and laid out unto David M^r Neely a tract of two hundred acres of land, situate in 96 District, above the old boundary, on both sides of a branch of Fortlenby's beverdam of Middle Tyger, and a small branch of Eliska Thomas's beverdam of said river, all sides on vacant land and hath such shape and marks as the above Plat represents, Survey, 30th Dec^r 1785, J^ohⁿ Whittier Esq., Recorded 3rd Jan^y 1786,

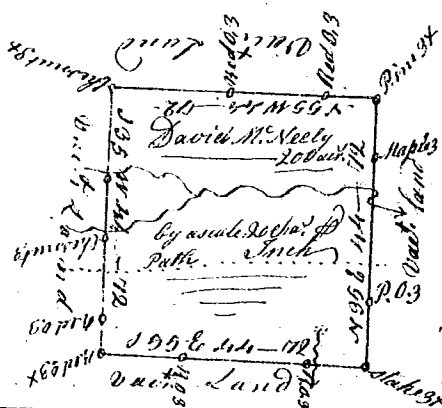

S^c Carolina, Pursuant to a warrant from John Thomas Esq^r Commissioner of locations dated the 28th Nov^r 1785, I have admeasured & laid out unto Daniel Latham a tract of 330 acres of land, situate in 96 District, on the branches of Moore's river, & hath such shape & marks, Buttresses & Boundings as the above Plat represents, Survey, this 3rd Dec^r 1785, Ben^j Glenn Esq., Recorded 4th January 1786, S^c Carolina.

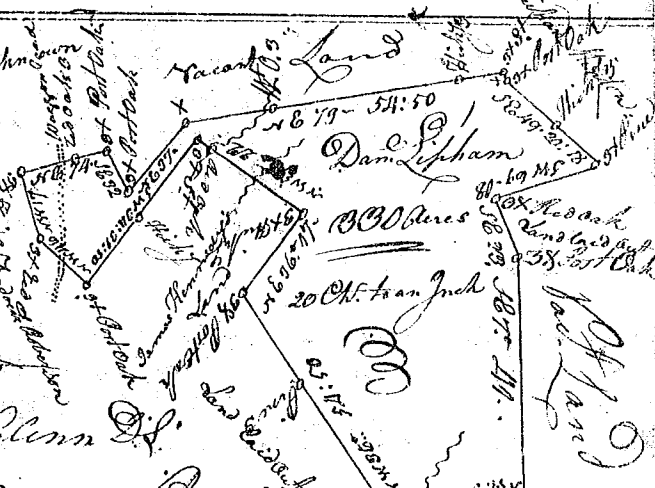

State of S^c Carolina Pursuant to a warrant from John Thomas Esq^r Commissioner of locations dated the 28th Nov^r 1785, I have admeasured & laid out unto Daniel Latham a tract of 100 acres of land, situate in 96 District in Union County below the ancient American Tyger River on the S^W side & hath such shape marks Buttresses & Boundings as the above Plat represents, Survey, this 30th Dec^r 1785, Recorded 4th January 1786, S^c Carolina.

