

State of South Carolina,
 Pursuant to warrant from John
 Thomas Esq. Commissioner of locations
 Dated the 8th day of November 1785, I have
 admeasured and laid out unto Maximilian
 Conner tract of one Thousand acres
 of land, situate in Sixty six district
 on both sides of Mountain-creek of
 Saluda river, and hath such shape,
 Marks, buttings and boundings as
 the above Plat Represents,
 Survey, 25 Nov^r 1785,
 by John C. Kilpatrick Esq.
 Recorded 27 Dec^r 1785.

Det. John Conner Jun^r

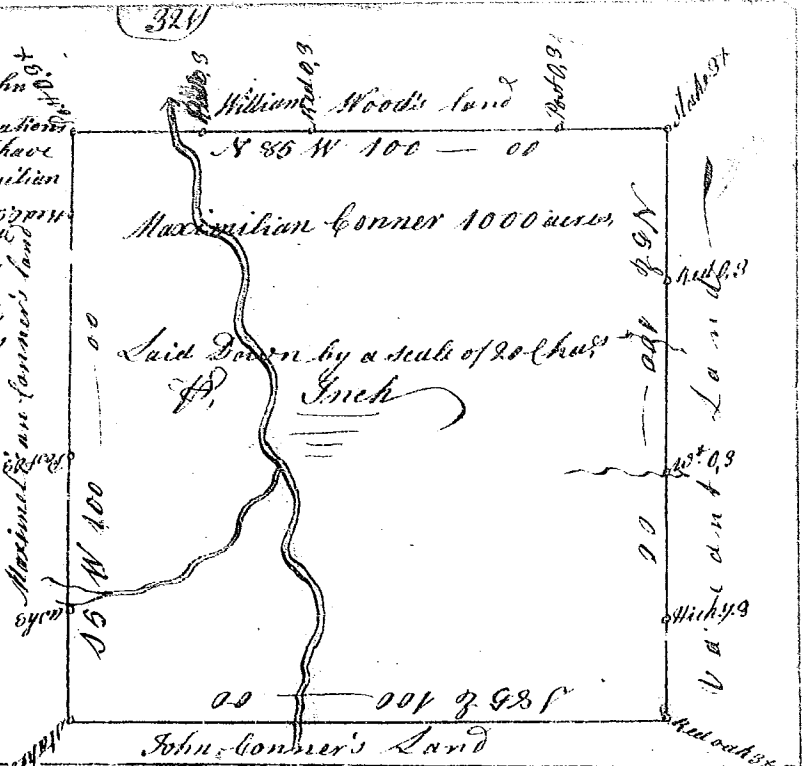

State of South Carolina,
 Pursuant to a warrant from
 John Thomas Esq. Commissioner of
 locations Dated 8th Nov^r 1785, I have
 admeasured and laid out unto Max-
 imilian Conner tract of one Thou-
 sand acres of land, situate in 66 district
 on the branches of Meedy River & horse
 creek of said river, and hath such
 shape, Marks, buttings & boundings
 as the above Plat Represents,
 Survey, 24 Nov^r 1785,
 by John C. Kilpatrick Esq.
 Recorded 27 Dec^r 1785.

Det. John Conner Jun^r

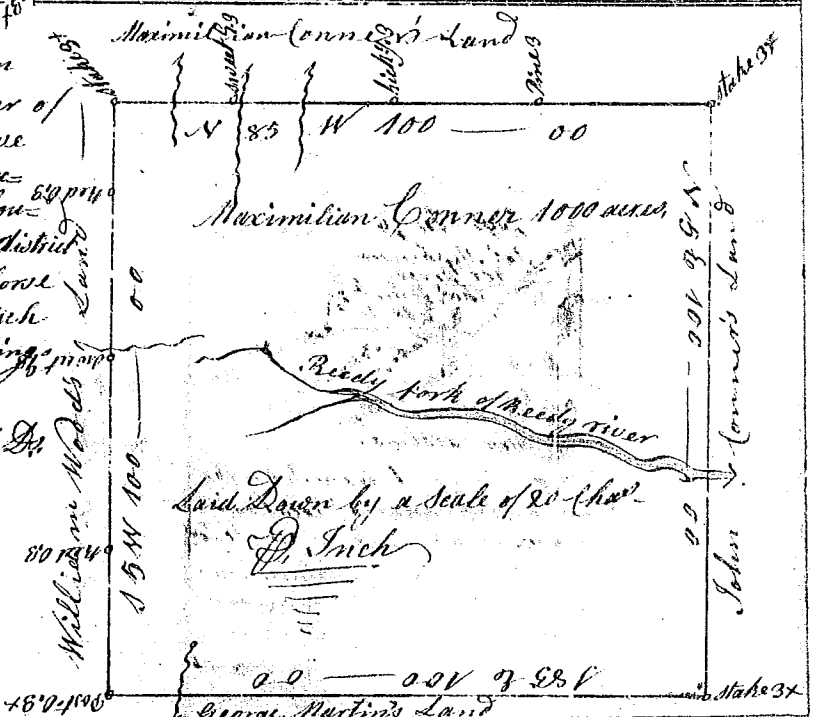

State of South Carolina Pursuant
 to a warrant from John Thomas Esq.
 Commissioner of locations dated 8th
 Nov^r 1785, I have admeasured and laid
 out unto Maximilian Conner tract
 of one Thousand acres of land
 situate in 66 District, on the branches
 of horse creek & mountain creek of
 Saluda river, and hath such shape,
 Marks, buttings and boundings as
 the above Plat Represents,
 Survey, 24th Nov^r 1785,
 by John C. Kilpatrick Esq.
 Recorded 28th Nov^r 1785.

Det. John Conner Jun^r

