

State of South Carolina

Pursuant to a warrant from John Thomas Esq. Commissioner of Locations Dated the 2^d Nov^r 1785, I have admeasured and laid out unto Matthew Patton a tract of land containing one hundred and sixty five acres, situate on the south fork of Tyger river, bounded N on the south fork of Tyger river, S. E. by John Patton's land, all other sides by vac. Land, and hath such Shape, and Marks, as the above Plat Represents—
 Survey, 3^d Nov^r 1785, by Andrew Thomson D^r.
 Recorded 11th Dec^r 1785, — Del. my^r Patton

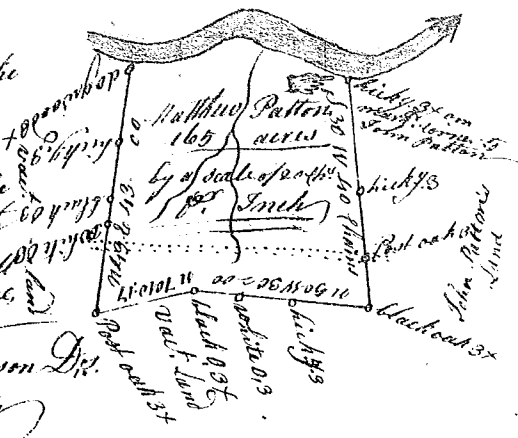

State of S^c Carolina,

Pursuant to a warrant from John Thomas Esq. Commissioner of Locations Dated the 28th day of Nov^r 1785, I have admeasured and laid out unto William Wood a tract of one Thousand acres of land situate in 96 District, on both sides of Horse-creek of Saluda River, and hath such Shape, Marks, buildings and boundings as the above Plat Represents—
 Survey, 24th Nov^r 1785, by John & Kilpatrick D^r.
 Recorded 29th Dec^r 1785, —

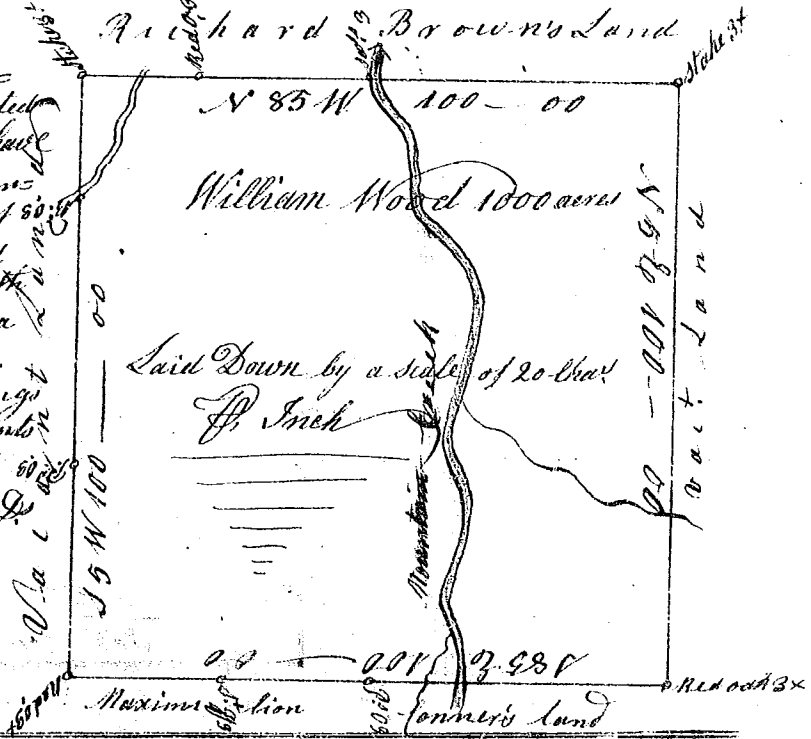

State of South-Carolina,
 Pursuant to a warrant from John Thomas Esq. Commissioner of Locations Dated 28th Nov^r 1785, I have admeasured and laid out unto William Wood a tract of eight hundred and forty two acres of land situate in 96 District, on the S fork of Horse-creek of Needy River, & branches of Mountain Creek of Saluda river, and hath such Shape, Marks, buildings and boundings as the above Plat Represents,
 Survey, 23^d Nov^r 1785, by John & Kilpatrick D^r.
 Recorded 27th Dec^r 1785, —

