

State of South Carolina

Pursuant to a warrant from the Thomas Commission of Locations dated the 22<sup>nd</sup> Nov 1785 I have examined & laid out unto John Goodwyn a tract of 900 acres of Land situate in 9<sup>th</sup> District above the old Boundary on the East Branch of Udy River & with such Stake Marks Buttings & Boundings as the above Plot Represents  
Surveyed the 19<sup>th</sup> Day of Nov 1785  
J. Whitner Deputee  
Recorded the 5<sup>th</sup> Day of Dec 1785

Mr Goodwyn  
900 Acre  
Laid down by a scale of town by Ch. H. Smith

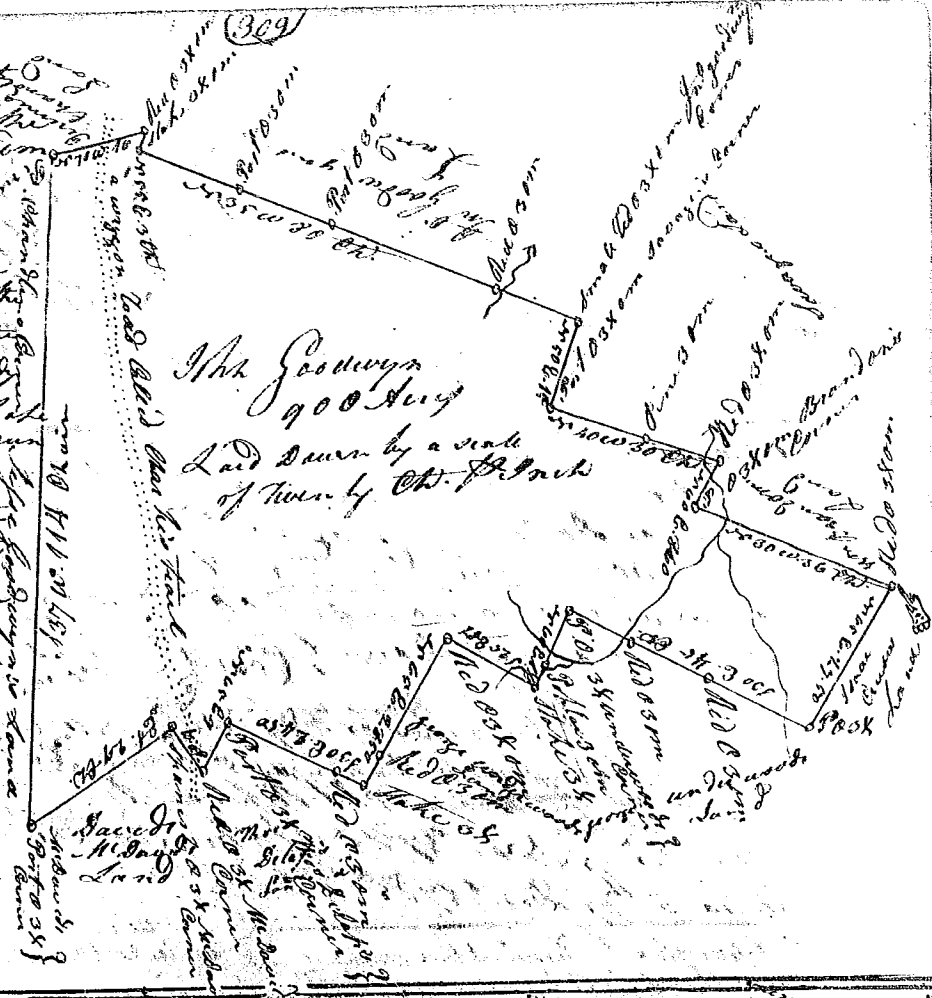

Mr Goodwyn's Land

111<sup>th</sup> Chain  
Sept Goodwyn 816 Acre  
Laid down by a scale of town by Ch. H. Smith



State of South Carolina

Pursuant to a warrant from the Thomas Commission of Locations dated the 14<sup>th</sup> of Nov 1785 I have examined & laid out unto Sept Goodwyn a tract of 816 Acre of Land situate in 9<sup>th</sup> District above the old Boundary on both sides of Laurel Creek of Udy River & with such Stake Marks Buttings & Boundings as the above Plot Represents  
Surveyed the 19<sup>th</sup> Day of Nov 1785  
J. Whitner Deputee  
Recorded the 5<sup>th</sup> Day of Dec 1785

Sept Goodwyn 816 Acre  
Laid down by a scale of town by Ch. H. Smith

