

Pursuant to a warrant from John Thomas Esq. Comptroller of Carolina for ninety six perches on the north side of Saluda I have measured and laid out ten to James Poole a tract of land containing two hundred acres situate on the north side of Fall Lake River bounded to the south on lands belonging to Matthew M. Bee and on all other sides vacant lands and with such stakes and marks as the above plat represents Surveyed this 19<sup>th</sup> of July 1785 Recorded the 21<sup>st</sup> of Sept<sup>r</sup> 1785

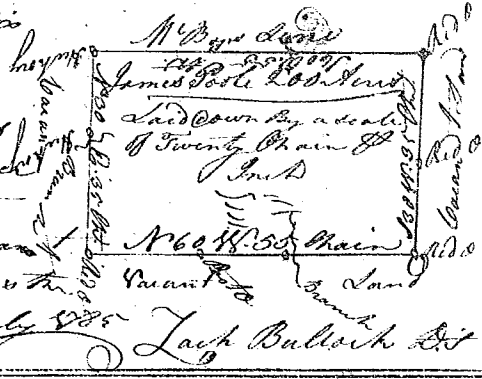

Pursuant to a warrant from John Thomas Esq. Comptroller of Carolina for ninety six perches on the north side of Saluda I have measured and laid out ten to James Poole a tract of land containing two hundred & twenty five Acres situate in ninety six perches on the north side of Saluda on Bullcreek Fork of Richkity bounded south and east on lands of Mrs Anne Moore south west on lands belonging to John Weston and on all other sides on vacant land and with such stakes and marks as the above plat represents Surveyed this 17<sup>th</sup> of July 1785 Recorded the 22<sup>nd</sup> of Sept<sup>r</sup> 1785

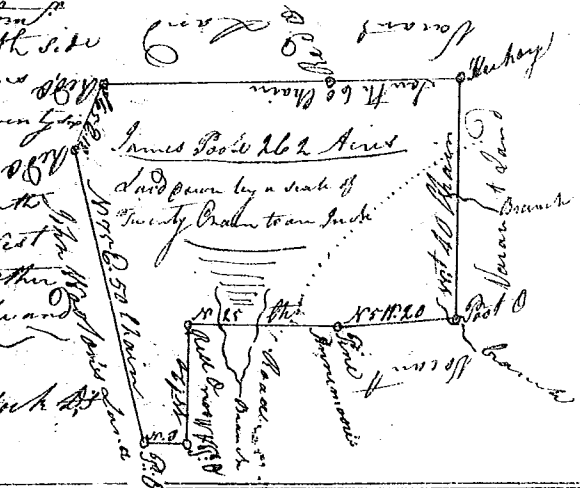

State of South Carolina Pursuant to a warrant from John Thomas Esq. Comptroller of Carolina for ninety six perches on the north side of Saluda I have measured and laid out ten to Nicholas Blair a tract of three hundred & thirty five Acres of land situate in ninety six perches on the waters of Fall Creek bounded by the north side of James Poole's land N.W. on lands laid out to Zachariah Shadin on S.W. on David Farmer's land S. on Wm. Lee's land and vacant land and S.E. on C. M. Bee's lands laid out to Charles Jones and with such stakes and marks as the above plat represents Surveyed this 8<sup>th</sup> of June 1785 Recorded the 22<sup>nd</sup> of Sept<sup>r</sup> 1785

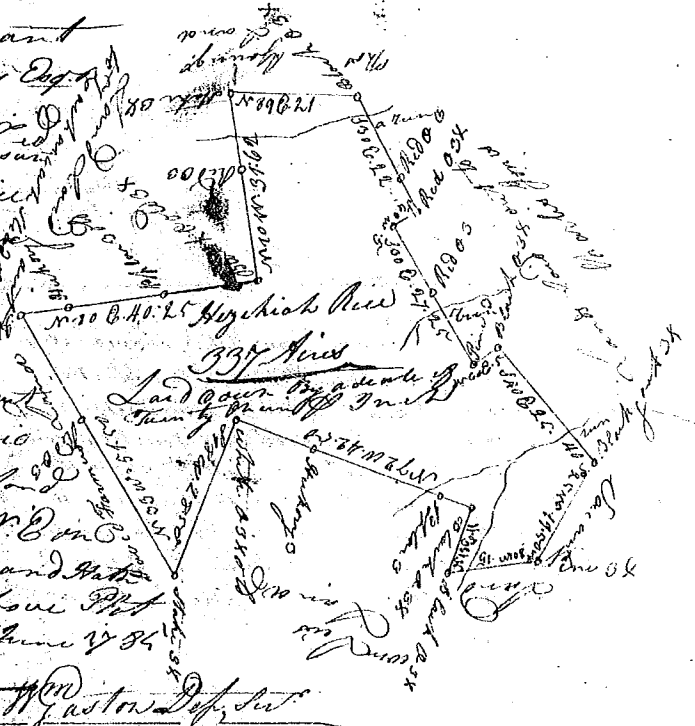

Pursuant to a warrant from John Thomas Esq. Comptroller of Carolina for ninety six perches on the north side of Saluda I have measured and laid out ten to Elisha Heydon a tract of land containing one hundred & thirty six acres of land situate on the north side of Fall Lake River or Fall Creek bounded on the south west a north west & north east on lands belonging to Zachariah Shadin on the north east on lands belonging to Richard Jay and on all other sides vacant lands and with such stakes and marks as the above plat represents Surveyed this 24<sup>th</sup> of Aug<sup>r</sup> 1785 Recorded the 23<sup>rd</sup> of Sept<sup>r</sup> 1785

