

State of S. Carolina Pursuant to a warrant from John Thomas Esq. Com. Locations in Ninety six District. I have admeasured & laid out unto William Campbell a tract of 140 acres of land, situate in 96 District on N. S. branch of Browns Creek - and hath such shape for and marks as the annexed plat represents Surveyed this 25<sup>th</sup> Aug<sup>r</sup> 1785

Recorded this 19<sup>th</sup> Sept. 1785 by Charles Sims Esq. Sec. Ad. Savage

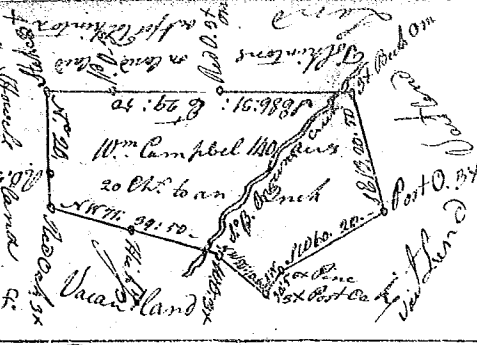

State of S. Carolina Pursuant to a Warrant from John Thomas Esq. Com. of Locations. I have admeasured & laid out unto John the Hollingworths a tract of One Hundred & Seventy Five Acres of land, situate in 96 District on Browns Creek a branch of Broad River hath such shape & marks buttings & Boundings as the above plat represents Surveyed this 15<sup>th</sup> June 1785

Recorded this 19<sup>th</sup> Sept. 1785 by Glenn D. Delivered Robert Savage



State of South Carolina Pursuant to a warrant from John Thomas Esq. Commissioner of Locations dated 31<sup>st</sup> day of May 1785, I have admeasured and laid out unto Saml Dunlap a tract containing two hundred and fifty acres, of land situate in Ninety six below the ancient Boundary line, on the Middle branch of Neighbour's Creek Waters of Sulfela River, bounded on all sides by Vacant Land, and hath such shape and Marks as the above Plat represents, Surveyed 30 June 1785

Recorded the 19<sup>th</sup> Sept. 1785 by Jonathan Downs D.

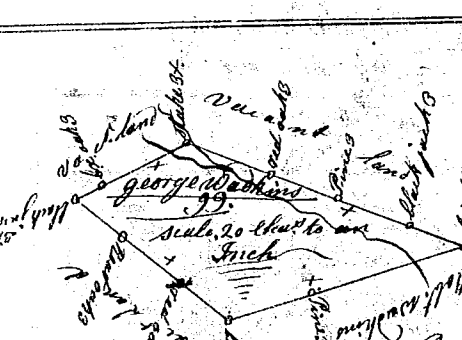
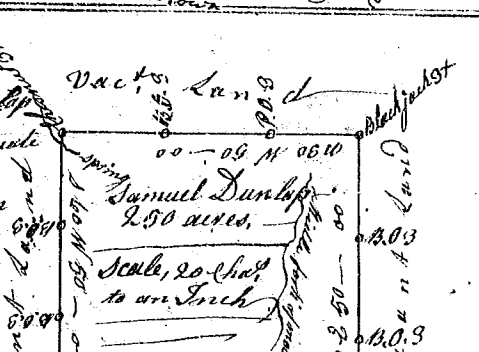

State of S. Carolina Pursuant to a warrant from John Thomas Esq. Commissioner of Locations I have admeasured and laid out unto George Wadhams a tract of 99 acres of land situate in Union County and Ninety six District below the ancient limits on a small branch of Enoree River, Bounded W. on Robert Wadhams and all other sides on Vacant Land, and hath such shape and Marks as the above Plat represents Surveyed 1<sup>st</sup> Aug<sup>r</sup> 1785

Recorded 19<sup>th</sup> Sept. 1785 by Abel Pearson Esq.

State of South Carolina Pursuant to a warrant from John Thomas Esq. Commissioner of Locations I have admeasured and laid out unto George Wadhams a tract of 58 acres of land situate in Union County Ninety six District below the ancient limits on N. S. side of Enoree River bound by hath such shape, Marks, buttings and boundings as the above Plat represents Surveyed the 1<sup>st</sup> day of Aug<sup>r</sup> 1785

Recorded 19<sup>th</sup> Sept. 1785 by Abel Pearson Esq.

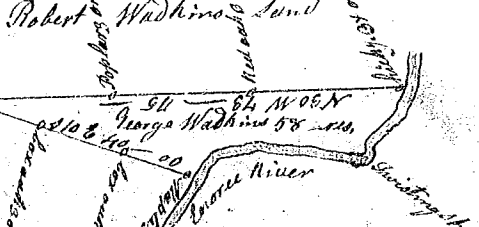

South Carolina Pursuant to a warrant from John Thomas Esq. Commissioner of Location dated 12<sup>th</sup> Aug<sup>r</sup> 1785, I have admeasured and laid out unto William Lynch a tract of one hundred acres of land, situate in 96 District 140 side Saluda below the old boundary on both sides of South Pacolote River, and hath such shape, Marks, buttings and boundings as the above Plat represents, Surveyed the 12<sup>th</sup> Aug<sup>r</sup> 1785

Recorded 19<sup>th</sup> Sept. 1785 by J. Whitner Esq.

