

State of South Carolina. Pursuant to a warrant  
 from the Hon. Board of Public Lands & Surveys  
 under the Hon. Secy of the Board, I have surveyed  
 of Locations Bearing Date August the Second 1785  
 of Sam. Williams & Land owned by Richard Powell  
 & tract of land therein by one hand, at & thereby  
 the other, situated lying & being in Union County  
 On the East Side of the Forest & in the  
 small Branches of the Forest in the  
 such shape & marks & Representations  
 and Paths as the Hon. Plat. Represents  
 Surveyed this 27th Aug. 1785  
 Surveyed by John Thomas  
 Recorded this 27th Aug. 1785  
 J. D. Thomson

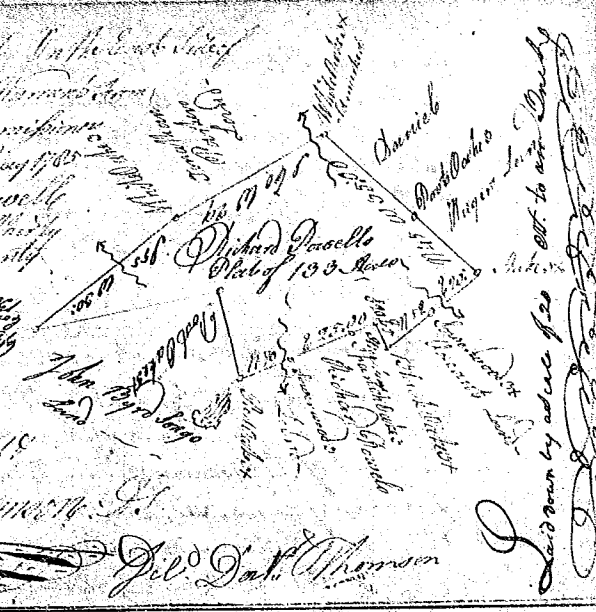

State of South Carolina. Pursuant to a warrant  
 from John Thomas Esq. LL in 96 District & I have  
 have admeasured & laid out unto Gray Coffey  
 a tract of 460 Acre of Land situated in 96 District  
 On the waters of Fairford on Mulkeys branch  
 bounding on land laid out to Mr. Mayber  
 on Col. Thomas Blandons land all other  
 sides on Vacant Land & that such shape &  
 marks as the annexed Representations  
 Surveyed the 18th July 1785  
 W. Gaston Esq.  
 Recorded this 29th Aug. 1785

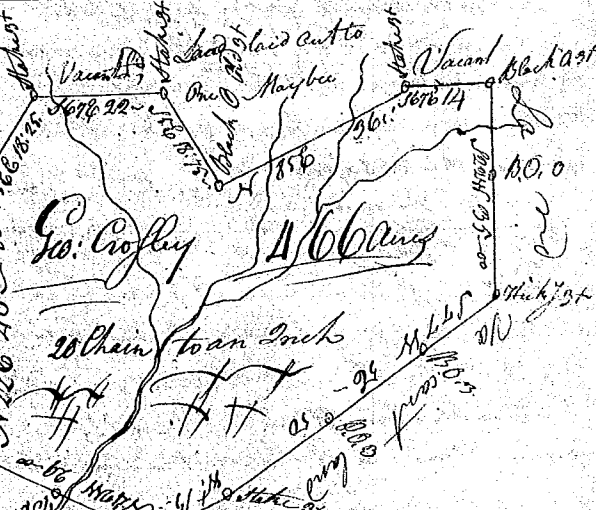

State of South Carolina. Pursuant to a warrant  
 from John Thomas Esq. Comr. of Locations in 96 District  
 N. of Saluda River, I have surveyed & laid out  
 unto John Macher a tract of Land containing  
 Six Hundred Acre, situated above the ancient  
 Boundary line. Including the head Branches  
 of Cripples Creek of Sandy River, bounded by  
 Wm. White. One Corner James Fishers  
 One Alexander & Sam. Peden & has  
 such shape & marks as the annexed  
 Representations  
 Surveyed the 19th August 1785  
 J. Seaborn Esq.  
 Recorded this 19th Aug. 1785

