

State of South Carolina

(202)

Pursuant to a Warrant from John Thomas Esq; Com^r of Locations Dated the 6th May 1785, I have admeasured & laid out unto the said Progen a Tract of four hundred & ninety seven acres of Land Situate in 96 District N. of Saluda West of the 2^d Boundary on both sides of Wildcat creek of South Tye & Beaverdam creek of Middle Tye Rivers I hath such shape marks & corners as the annexed plat represents - Surveyed the 20th May 1785

Wm Turner Esq

Recorded the 11th Aug. 1785

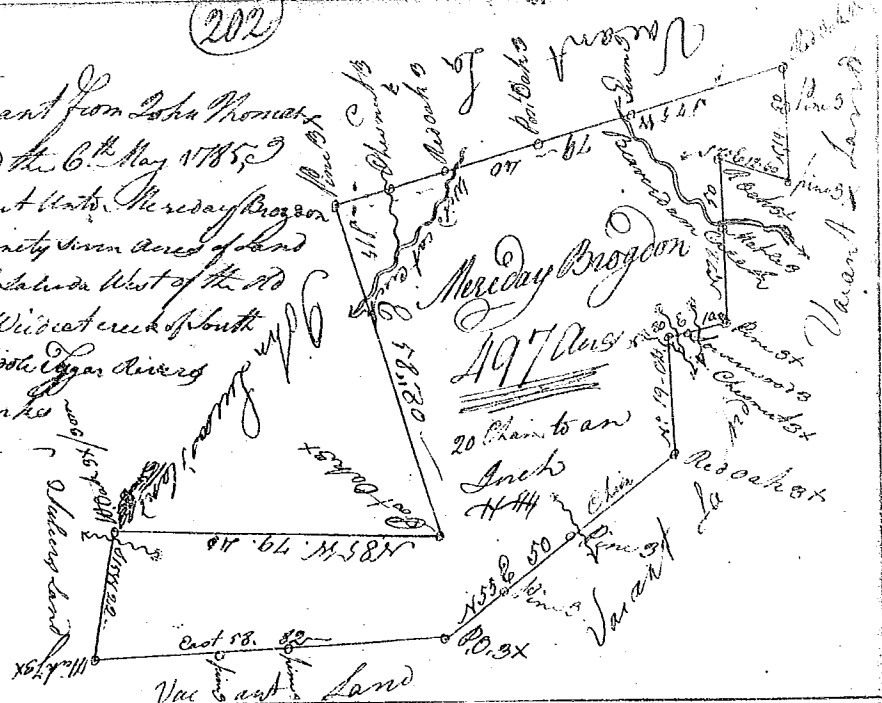

State of South Carolina Pursuant to a Warrant from John Thomas Esq; Commissioner of Locations Dated the 19th July 1785. I have admeasured & laid out unto William Curd a Tract of one thousand acres of Land Situate in 96 District on both sides of the N. fork of the Beaverdam Creek of S. Carolin River I hath such shape marks Buttings & Boundings as the above plat represents. Surveyed the 24th July 1785

Recorded the 11th August 1785

John Young Jun^r Esq

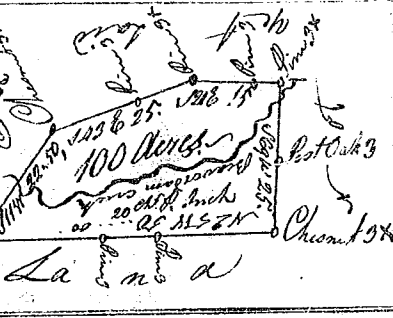

State of South Carolina Pursuant to a Warrant from John Thomas Esq; Com^r Dated the 19th July 1785. I have admeasured & laid out unto Amos Speece a Tract of 125 Acres of Land Situate in 96 District on both sides of Cherokee Creek of Broad River I hath such shape marks Buttings & Boundings as the above plat represents - Surveyed the 24th July 1785

Recorded the 11th August 1785

John Young Jun^r Esq

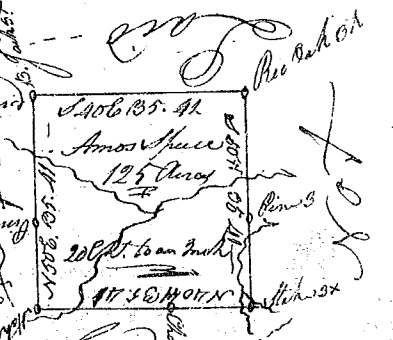

State of South Carolina Pursuant to a Warrant from John Thomas Esq; Com^r Dated the 19th July 1785. I have admeasured & laid out unto Amos Speece a Tract of Seventy two acres of Land, Situate in 96 District on both Sides of Cass Creek of Carolin River I hath such shape marks Buttings & Boundings as the above plat represents - Surveyed the 24th July 1785

Recorded the 11th Aug. 1785

John Young Jun^r Esq

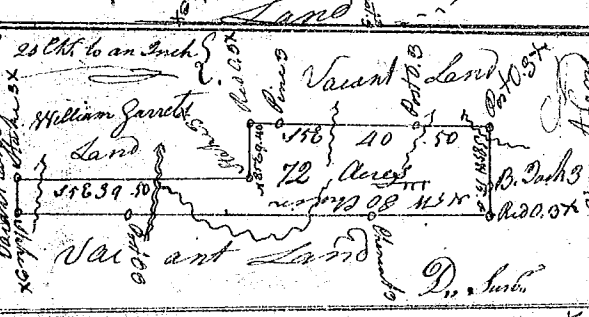

State of South Carolina Pursuant to a Warrant from John Thomas Esq; Com^r dated the 10th July 1785. I have admeasured & laid out unto Baxter Estes a Tract of 211 Acres of Land Situate in 96 District N. of Saluda River West of the 2^d Boundary on Patersons Creek of the S. fork of Saluda River & branches of Middle fork of S. River I hath such shape marks Buttings & Boundings as the annexed plat represents - Surveyed the 11th July 1785

Recorded the 11th Aug. 1785

Wm Turner Esq

