

State of South Carolina Pursuant to a Warrant from John Thomas Esq. Com. of Locations Dated the 6th of July 1785. I have Admeasured & laid out unto William Wood a tract of Four Hundred & Thirty seven Acres Situate in 96 District on both sides of Church Creek of Broad River & hath such shape marks & buttings & Boundings as the Annexed plat represents. Surveyed the 19th July 1785. Recorded the 11th August 1785. J. Whitney Del.

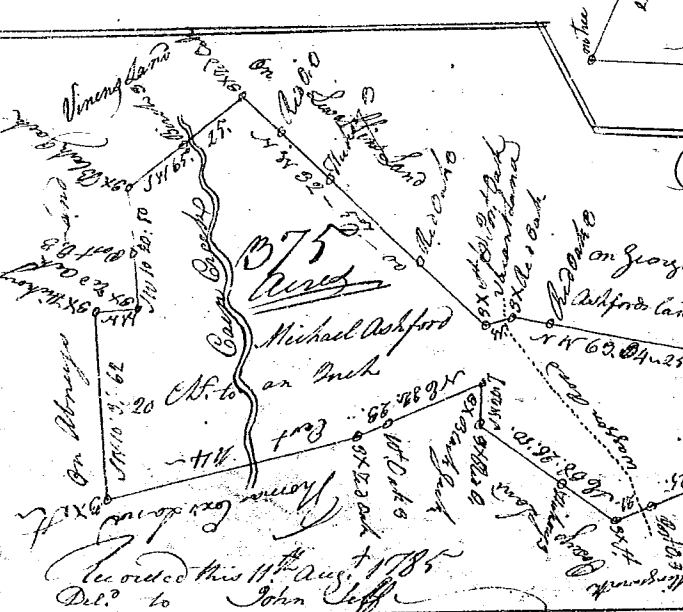

I State South Carolina Pursuant to a Warrant from John Thomas Esq. Com. of Locations I have Admeasured & laid out unto Michael Ashford a tract of 375 Acres of land Situate in 96 Dist. on Cain Creek a branch of Tyger River & hath such shape marks & buttings & Boundings as the Annexed plat represents. Surveyed this 25th June 1785. Bernard Glenn Del.

State of South Carolina Pursuant to a Warrant from John Thomas Esq. Com. of Locations Dated the 9th June 1785 I have Admeasured & laid out unto John Malin a tract of 311 acres of land Situate in 96 District N. of Saluda. Above the old boundary on branches of the Carolina River all sides & hath such shape & marks as the above plat represents. Surveyed this 1st July 1785. Recorded the 11th August 1785. J. Whitney Del.

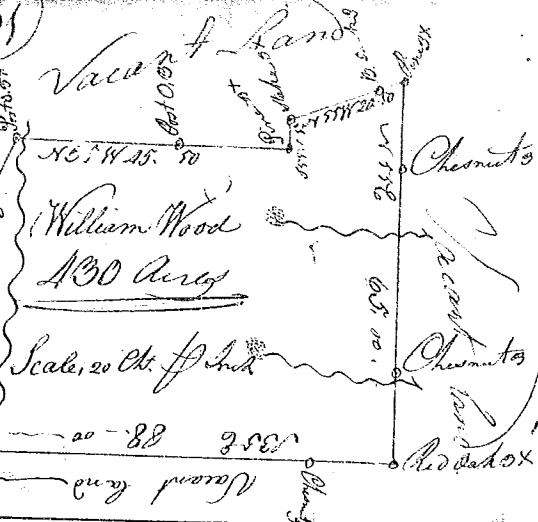

State of South Carolina Pursuant to a Warrant from John Thomas Esq. Com. of Locations Dated the 11th June 1785 I have Admeasured & laid out unto Archibald Dill a tract of One Hundred & forty acres of land Situate in 96 Dist. on both sides of a branch of Fathensbergs Beavers dam of Tyger River & hath such shape marks & buttings & Boundings as the Annexed plat represents. Surveyed the 6th June 1785. Recorded the 11th August 1785. John Young Jun. Del.

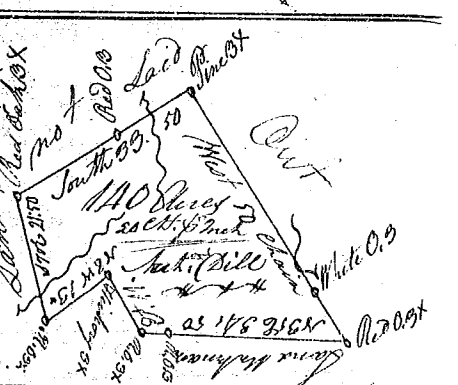

State of South Carolina Pursuant to a Warrant from John Thomas Esq. Com. of Locations Dated the 20th June 1785. I have Admeasured & laid out unto Thomas Gammon a tract of 300 Acres of land Situate in 96 District N. of Saluda. West of the old Boundary on both sides of Beavardan Creek of Middle Tyger River all sides on vacant land & hath such shape & marks as the Annexed plat represents. Surveyed the 2nd July 1785. Recorded the 11th August 1785. J. Whitney Del.

