

State of South Carolina, Pursuant to a warrant from
 John Thomas Esq. Esq. of Locusts in 96 Dist. of Saluda River. Dated the
 1st May 1785. I have admeasured & laid out unto Benj. Buchanan
 a tract of 44 Acres of Land situated in 96 District of Saluda
 below the Old Boundary, on Waters of Williams Creek Water of Broad
 River bounded SW by Christ. Hoop Benj. Buchanan & Merywines
 Lands NW by Daniel Burrows Land SE by Commicks Land & that such
 lines & marks as the annexed plat represents, surveyed the 1st May 1785
 Recorded this 8th August 1785
 Peter Waters Esq.

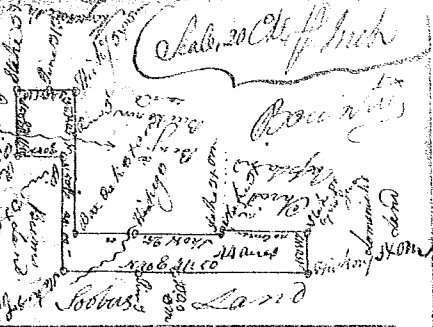

South Carolina Pursuant to a warrant from John Thomas Esq. Esq.
 the 1st May 1785. I have admeasured & laid out unto Michael Wheeler a
 Tract of land containing One Hundred & Ninety five Acres, situated in
 District of Ninety six, on Waters of Campung Creek a branch of Saluda River
 I have such farm & marks, Buttings & Boundings with annexed
 Plat Represents. Surveyed this 1st June 1785
 Recorded this 11th August 1785
 Peter Waters Esq.

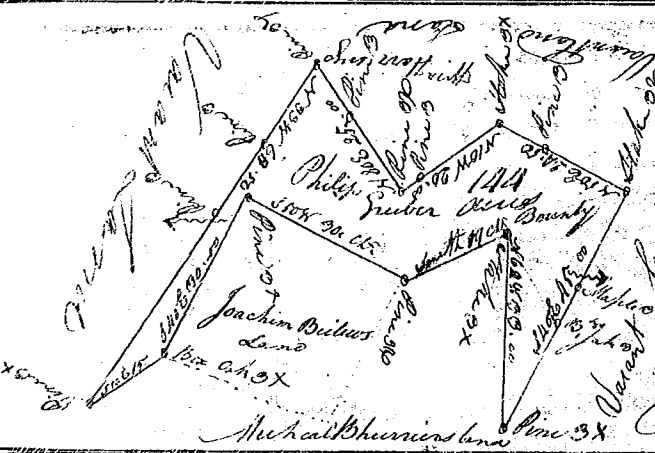

South Carolina Pursuant to a Warrant from
 John Thomas Esq. Esq. Dated the 1st May 1785. I have
 admeasured & laid out unto Philip Seiber
 a Tract of land containing One Hundred & forty
 four Acres, situated in the District of Ninety six
 on Waters of Stephens fork a branch of Saluda,
 I have such farm Marks Buttings & Boundings
 as the annexed Plat Represents.
 Surveyed this 7th June 1785
 Recorded this 11th August 1785
 Peter Waters Esq.

South Carolina 96 District. Pursuant to a Warrant from
 John Thomas Esq. Esq. for the District 96 of Saluda River
 I have admeasured & laid out unto John Savage
 a Tract of Land containing 640 Acres situated
 above the ancient Boundary on both sides of Plaines
 River & also on both sides of Beaver Dam Creek
 a branch of S. River. Bounded E on Dan. Kellogs
 Land W on Wm Turnbors Land NW on a Survey unknown
 and has such the line & marks as the annexed
 Plat Represents, Surveyed 10th Aug^r 1785 by
 Recorded 11 August 1785
 James Seaborn Esq.

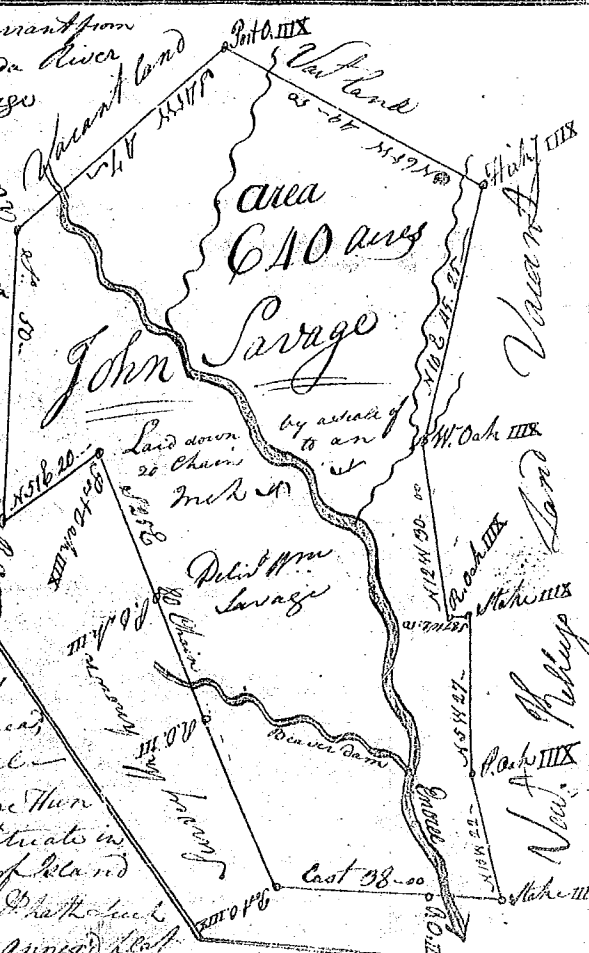

State of South Carolina
 Pursuant to a Warrant
 from John Thomas Esq.
 Esq. Dated the 31st of
 July 1785. I have admeasured
 & laid out unto Daniel
 Sellwell a Tract of One Hun
 dred and six Acres, situated in
 96 District on both sides of Plaines
 Creek of Plaines River. I have such
 the line & marks as the annexed Plat
 Represents, Surveyed the 15th day of July 1785
 Recorded this 11th August 1785
 George Salmon Esq.

