

State of South Carolina 96 District on the West side of the Ancient Boundaryline. Pursuant to a Warrant from John Thomas Esq. Commissioner of Locations Dated the 26th April 1785. I have ad-
 measured & laid out unto Friedrich Crauford a tract of Lands containing
 240 Acres, lying on both sides of the Reddy fork of Needy River bounded by
 John Piles Land, N & E by Joseph Richardson Land all other sides
 Vacant, & hath such shape & marks as the annexed plat represents,
 Survey'd this 30th April 1785 Andrew Thomson Esq.
 Recorded the 4th day of August 1785.

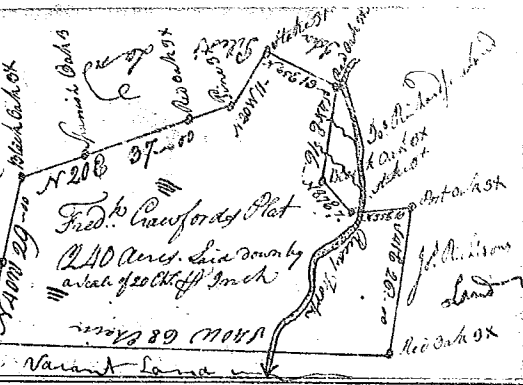

State of S. Carolina. Pursuant to a Warrant
 from John Thomas Esq. Com. of Locations in 96
 District N. side Saluda River, I have ad-
 measured & laid out unto Doct. Geo. Rofy a tract
 of four hundred & ten acres of land, on
 a branch of Enoree River lat. Creek head
 lat. 6. A head creek in Lawrence County
 bounded N. by Thomas Jordan Land & Joseph
 Carsons Land E. by on land laid out to James
 M'Henry Mon James M'Henry's Land all other
 sides Vacant Land, & hath such shape and
 marks as the above Plat Represents Survey'd
 20 June 1785
 Recorded the 4th August 1785 Robert Hanna
 Deput. to Doct. Rofy

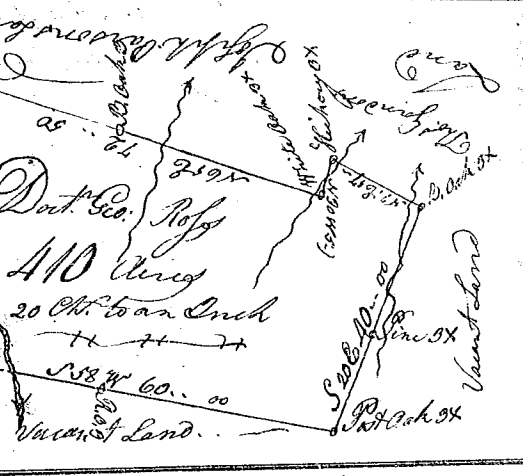

State of South Carolina 96 District West
 of the Ancient Boundary. Pursuant to a Warrant
 from John Thomas Esq. Com. of Locations
 Dated the 27th May 1785. I have admeasured
 & laid out unto Daniel Rogers a tract of land con-
 taining 373 Acres, on the N. side of Needy &
 River & the Reddy fork of Needy River
 bounded to the south by David M'Pard Land
 all other sides on Vacant Land & hath such shape
 & marks as the above plat represents
 Survey'd this 30th May 1785
 Recorded the 4th August 1785 Andrew Thomson Esq.



State of South Carolina 96 District East of the Old Boundary
 Between Broad & Parrot Rivers. Pursuant to a Warrant
 from John Thomas Esq. Commissioner of Locations dated
 the 30th April 1785. I have admeasured & laid out unto
 Philemon Martin a tract of land containing 562
 Acres, on the branches of Abottons & Cuthberts
 Creeks bounded W. by Benjamin Harlow Land
 all other sides Vacant & hath such shape & marks
 as the annexed plat represents
 Survey'd this 1st May 1785
 Recorded 4th August 1785

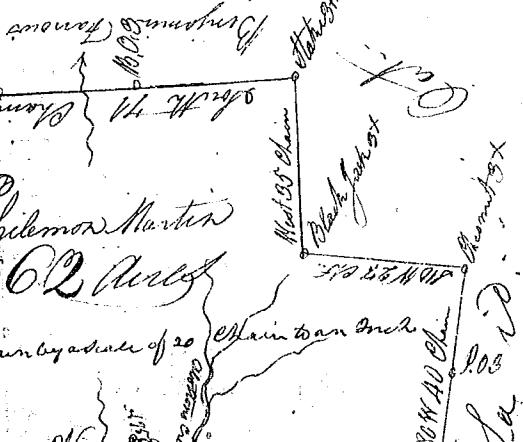

State of S. Carolina 96 District Below the line
 Pursuant to a warrant from John Thomas Esq.
 Esq. dated the 29th May 1785. I have admeasured &
 laid out unto May say a tract of one hundred
 and Twenty five acres of land, lying on the N. side of
 junction of on the small Branches thereof bounded
 N. by Arthur Coochings Land E. by land laid out for
 David Briley West by Richard Sages Land the other side
 Vacant & hath such shape & marks as the annexed plat
 Represents Survey'd this 30th May 1785
 Recorded 4th August 1785 Andrew Thomson Esq.

