

State of South Carolina of District East of the old Boundary line

Pursuant to a warrant from John Thomas Esq. Comr. of Locations Dated the 17th May 1785, I have admeasured & laid out unto John Little a tract of one hundred acres of land situate lying & being on both sides of Lindsey Creek of the old River, bounded on all sides on vacant land & hath such shape & marks as the annexed plat represents Surveyed this 27th day of May 1785 by Andrew Thomson Esq. Recorded the 2nd day of August 1785

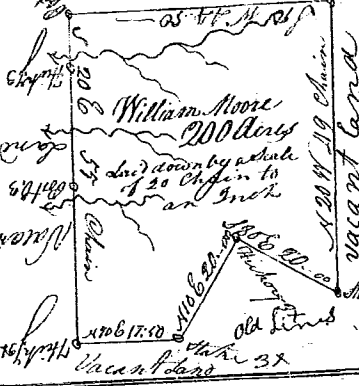

State of South Carolina of District East of the old Boundary line



Pursuant to a warrant from John Thomas Esq. Comr. of Locations Dated the 17th June 1785

I have admeasured and laid out unto William Moore a tract of land containing two hundred acres, lying and being on Lindsey Waters of Enore River, bounded northward by William Reeves land & to the south east by old lines, all other sides by vacant land & hath such shape & marks as the annexed plat represents Surveyed this 30th day of June 1785, by Andrew Thomson Esq. Recorded the 2nd day of August 1785

State of South Carolina of District East of the ancient Boundary

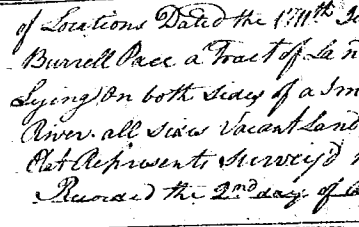

Pursuant to a warrant from John Thomas Esq. Comr. of Locations Dated the 17th June 1785

I have admeasured & laid out unto Brundell Pace a tract of land containing one hundred & fifty acres lying on both sides of a small branch of Two mile Creek B. Waters of Enore River, all sides vacant land & hath such shape & marks as the annexed plat represents Surveyed this 30th day of June 1785 by Andrew Thomson Esq. Recorded the 2nd day of August 1785

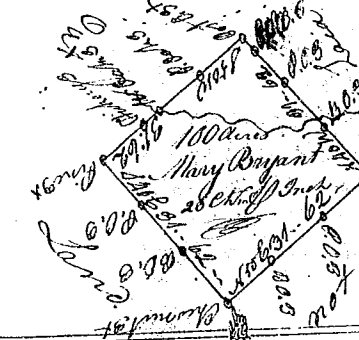

State of South Carolina of District East of the old Indian Boundary

Pursuant to a warrant from John Thomas Esq. Comr. of Locations Dated the 14th June 1785 I have admeasured and laid out unto Mary Bryant a tract of land containing one hundred acres situate lying & being on a small branch of Dutchmans Creek a branch of Upper River, all sides vacant & hath such shape & marks as the annexed plat represents Surveyed this 17th June 1785 by Andrew Thomson Esq. Recorded this 3rd August 1785

State of South Carolina, District on the East side of the old Boundary line

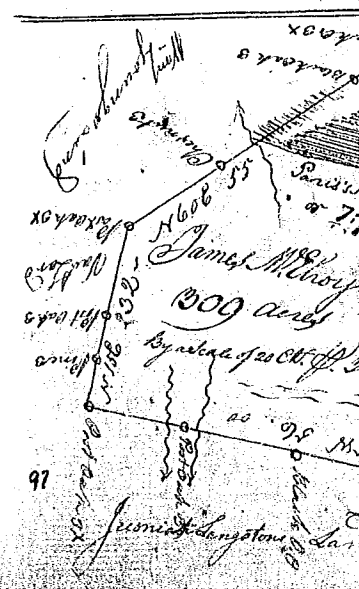

Pursuant to a warrant from John Thomas Esq. Comr. of Locations Dated the 17th May 1785, I have admeasured & laid out unto Daniel Rogers a tract of land containing one hundred acres situate between Indian & Reddy Rivers on base branch Waters of Enore River bounded to the South by Isaac Reeds land all other sides vacant & hath such shape & marks as the annexed plat represents Surveyed this 30th May 1785 by Andrew Thomson Esq. Recorded the 2nd August 1785



State of South Carolina of District West of the ancient Boundary line

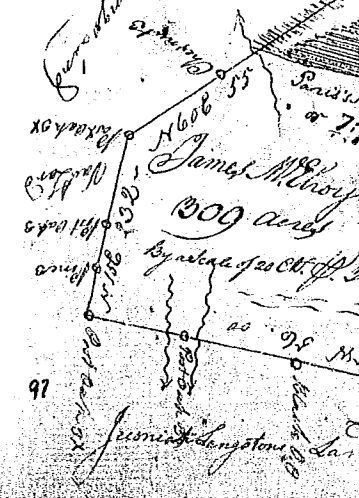

Pursuant to a warrant from John Thomas Esq. Comr. of Locations Dated the 30th day of May 1785

I have admeasured & laid out unto James Melroy a tract of land containing three hundred & nine acres, lying on a small branch of Enore River, called Sarumers branch & on the N. side of Reddy River, including the West End of Paris's Mountain, Bounded Southward by William Langstone's land N.W. by William Young's land & all other sides vacant, & hath such shape & marks as the annexed plat represents Surveyed this 9th June 1785 by Andrew Thomson Esq. Recorded the 3rd day of August 1785 Delivered to J. Melroy

