

State of South Carolina

Pursuant to a Warrant from John Thomas Esq. Com. of Locations Dated the 21<sup>st</sup> day of May 1785, I have admeasured & laid out unto David Cooper a Tract of Six Hundred and Forty Acres of Land, Situate on the North side of Saluda River & Below the Old Bound-ary in 96 (District. On the North side of Check. Bounding) to the N.W. Corner Woods Land South West on S. Woodsony & Feters Lands all other sides on Vacant Land & hath such Shape and marks as the annexed plat Represents Surveyed this 24<sup>th</sup> day of May 1785

Recorded 30<sup>th</sup> July 1785 W. Martin D.S.

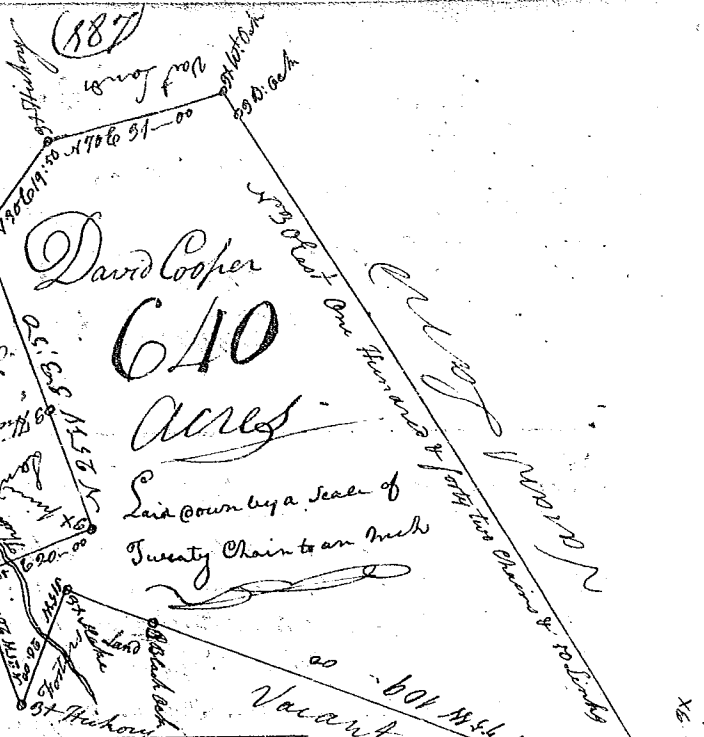

State of S. Carolina Ninety Six District East of the Old Boundary

Pursuant to a warrant from John Thomas Esq. Com. of Locations (Dated the 24<sup>th</sup> May 1785. I have admeasured & laid out unto Francis Fowler a Tract of Land containing two Hundred & fifteen acres on both sides of the N<sup>o</sup>. fork of Fergusons Creek Bounded N<sup>o</sup>. W<sup>o</sup>. by James Woffords Land N<sup>o</sup>. by Bing. Griffiths Land East by James Fosters Land & hath such Shape & marks as the annexed plat Represents Surveyed this 4<sup>th</sup> June 1785.

Recorded 1<sup>st</sup> August 1785 Andrew Thomson D.S.



State of S. Carolina Pursuant to a Warrant from John Thomas Esq. Com. of Locations

Dated the 29<sup>th</sup> day of April 1785. I have admeasured and laid out unto Oriskany Cox a Tract of Land containing One Hundred and twenty eight Acre. Situate in 96 District West of the Old Boundary on Reedy River and hath such Shape marks Buttings & Bounding as the annexed plat Represents Surveyed this 2<sup>nd</sup> of May 1785

Recorded the 1<sup>st</sup> August 1785 Wm Benson D.S.

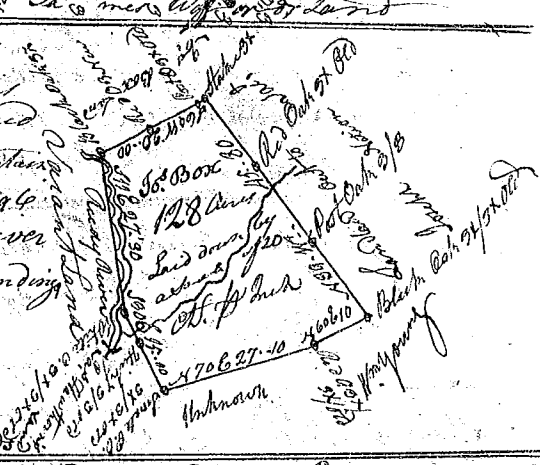

State of South Carolina

Pursuant to a Warrant from John Thomas Esq. Commissioner of Locations Dated the 20<sup>th</sup> day of May 1785. I have admeasured & laid out unto Peter Brooks a Tract of Land containing two Hundred and eighty nine Acre. Situate in Ninety Six District West of the Old boundary on the Branches of Snow River & hath such Shape Marks Buttings & Bounding as the above plat Represents. Surveyed this 12<sup>th</sup> July 1785

Recorded the 10<sup>th</sup> day of August 1785 Wm Benson D.S.

