

State of South Carolina,
 Pursuant to a warrant from John Thomas Commissioner of Locations dated 18 May 1785,
 I have admeasured and laid out unto Silsas M. Bee a tract of Six hundred and forty of land
 situate in 96 District N^o of Saluda river, below the old Indian boundary bounding N^o toward by
 on land laid out to N^o 4, N^o 11 & SW on Wardery Mc Bee's and Wards Land, all other sides on vacant
 land, and hath such shape and marks as the above plat represents, surveyed 19 May 1785.
 Recorded 27th July 1785,
 D. Hopkins D^s

State of South Carolina Pursuant to a warrant
 from John Thomas Esq^r Com^r of Locations dated
 the 24th day of May 1785 - I have admeasured
 and laid out unto Joshua Prestidge a tract
 of Six hundred & forty acres of Land. Situate in
 96 District N^o of Saluda below the old boundary
 on Quins Cree k bounding N. E. on land laid
 out to N^o 3 Vand. N^o 11 to the SW on land laid out
 to N^o 11 Francis Rofs. & all other sides on vacant
 Land & hath such shape & marks as the annexed
 Plat represents, surveyed the 24th May 1785
 Recorded the 30th July 1785.
 D. Hopkins D^s

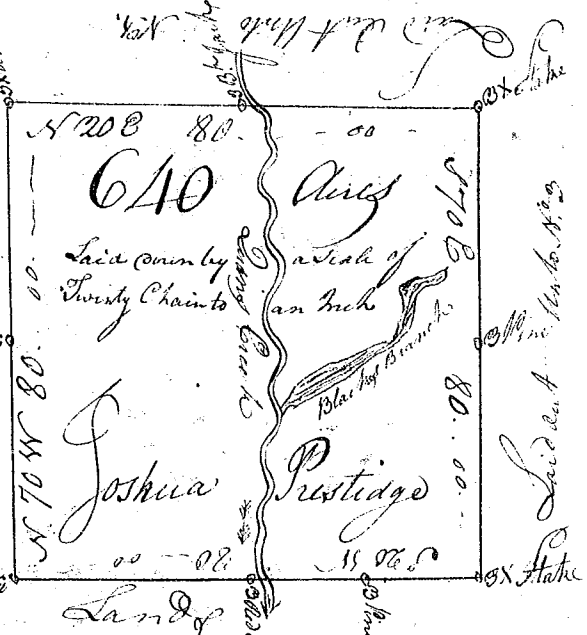

State of South Carolina. Pursuant
 to a Warrant from John Thomas Esq^r Com^r
 of Locations dated the 18th May 1785 - I have
 Admeasured & laid out unto William Hill
 a tract of Six hundred & forty Acres of Land
 Situate in 96 District N^o side Saluda
 Below the old Boundary line on Cherokee
 Creek. Bounding N^o W on land laid out
 unto N^o 9 Landry Mc Bee all other sides on
 Vacant Land and hath such shape
 & marks as the annexed Plat repre-
 sents. Survey'd this 19th May 1785
 Recorded the 30th July 1785
 D. Hopkins D^s

