

State of South Carolina Pursuant to a warrant from John Thomas, Commissioner of locations, dated the 9th day of July 1785, I have admeasured and laid out unto James Willson a tract of land containing two hundred acres of ^{land} situate in 96 district Lawrence County on a branch of little river Call. Myriss's creek Bounded as above mentioned, below the ancient boundary line and hath such shape & Marks as the above Plat Represents,

Survey, 11th day July 1785, by South. J. Lewis Esq.
Recorded 16 July 1785, Del. J. Willson,

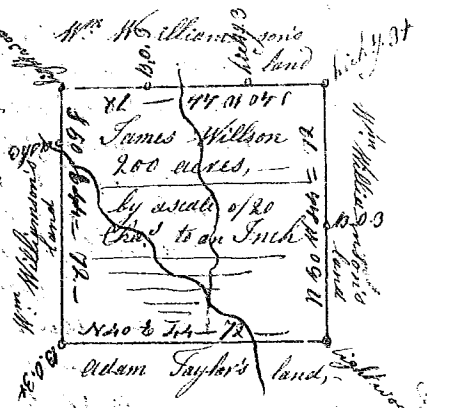

State of South Carolina 96 district N^o Saluda, East of the Indian boundary line, Pursuant to a warrant from John Thomas, Esq. Commissioner of locations dated 24th June 1785, I have admeasured and laid out unto William Allen a tract of land containing six hundred and forty acres situate lying and being on the banks of Ferguson's Creek, waters of Tugal River, Bounded upwards by old lines & southwardly by Henry Middle ton's land, on all other sides by vacant land, and hath such former and shape & Marks as the above Plat Represents, Survey, 1 July 1785, by J. Wofford Esq.
Recorded 16 July 1785, Del. W. Allen

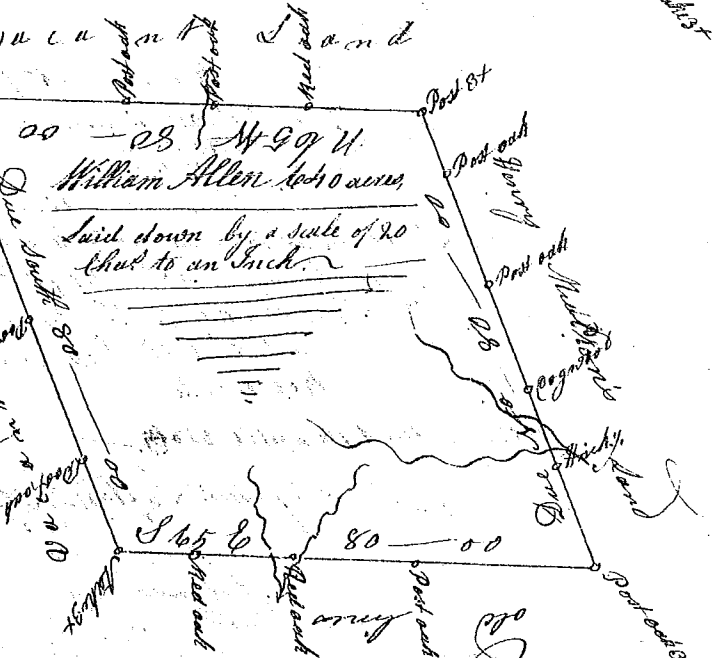

State of S^c Carolina, 96 district, East of the O^d. boundary line, Pursuant to a warrant from John Thomas, Esq. Commissioner of locations dated the 1 day of May 1785, I have admeasured and laid out unto James Wofford a tract of land containing two hundred acres, situate lying and being on both sides of Ferguson's Creek a branch of Tugal River, and hath such shape and marks, and boundaries as the above plat Represents
Survey, 30 May 1785,
Recorded 16 July 1785, Del. W. Allen

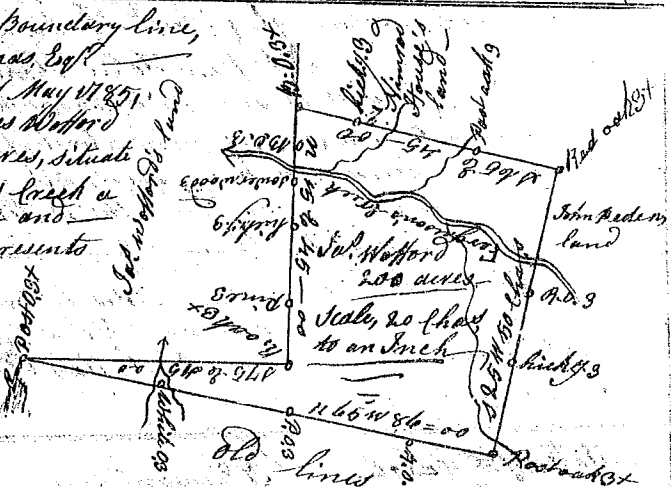

State of S^c Carolina, Pursuant to a warrant from John Thomas, Commissioner of locations dated 29th day of June 1785, I have admeasured and laid out unto William Ford a tract of land containing two hundred and twenty seven acres, situate in ninety six district East of the ancient boundary on Jones's branch of the North fork of Tugal River and hath such shape and Marks as things and boundaries, as the above Plat Represents
Survey, 29 of June 1785,
Recorded 18 July 1785,

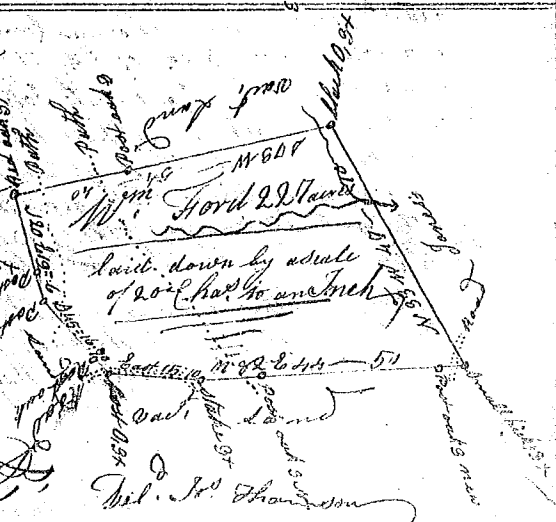

W. Benson Esq.
Del. J. Wofford