

State of S^c Carolina,
 Pursuant to a warrant from John Thomas,
 Commissioner of locations for the 1st N^o of Saluda River,
 I have surveyed, and laid out unto Vachel Dilinham a tract
 of land containing 640 acres, situate above
 the ancient boundary line, bounded N^o wardly on
 John Combs's land, E^o wardly on Michael Dilin-
 ham's land, all other sides on Vacant land
 and has such shape and Marks as the
 above plat represents,

Certified the 13th June 1785,
 Jas Seaborn D^s,
 Recorded 17th June 1785,

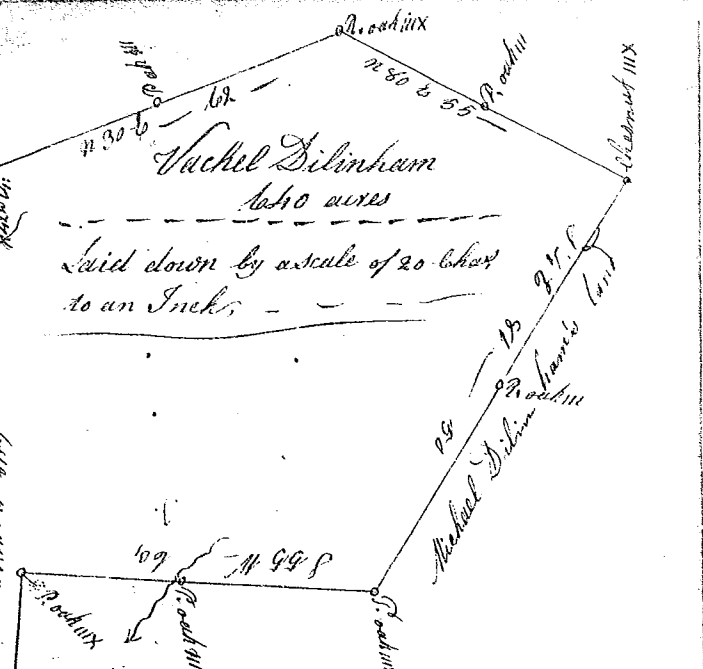

State of S^c Carolina,
 Pursuant to a warrant from John Thomas,
 Commissioner of locations for the 1st N^o of Saluda River
 I have surveyed, and laid out unto William Turnbough a tract
 of land containing 222 acres, situate above the ancient boundary
 line, on the waters of Enoree River, bounded E^o wardly by William
 Savage's land, on all other sides by Vacant Land, and has such shape & Marks as the above plat
 represents,
 Recorded 17th June 1785, by James Seaborn D^s,

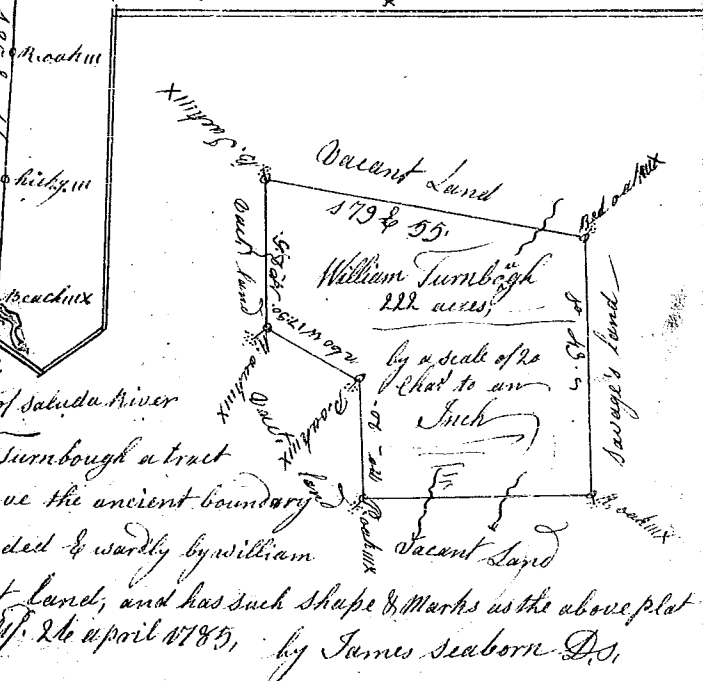

State of S^c Carolina 96 915th Pursuant to a warrant
 from John Thomas Commissioner of locations for the N^o 1
 of Saluda River, I have surveyed, and laid out unto James
 Subb a tract of land containing 190 acres, situate above
 the ancient boundary line, on both sides of Enoree River
 bounded W^o wardly by Robt Princes land, on all other
 sides by Vacant land, and has such shape and Marks
 as the above Plat represents, 10 June 1785,
 Recorded 18th June 1785, James Seaborn D^s,



State of S^c Carolina Pursuant to a warrant from John Thomas
 Laurence County Commissioner of locations dated 26th May 1785,
 I have admeasured and laid out unto George Huller a
 tract of land containing Two hundred acres, situate
 in Laurence County, on a branch of Neighbors's
 Creek, call'd Mellicams's branch, bounding on John
 Husby, S^o on Jacob Vault, NW on Luther not
 known, & on Vacant land, and hath such shape
 and Marks as the above Plat represents,
 Below the line,
 Recorded 26 June 1785,
 77

