

South Carolina, Pursuant to a warrant from John Thomas Commissioner of locations for 96 district N. of Saluda, I have admeasured and laid out unto Richard Lankster a tract of land containing six hundred and forty acres, situate in the district of ninety six, on the waters of Little Creek, branches of Meedy river, and hath such marks and form, buttings and boundings as the above plat represents, Survey, 14 April 1785,
 Lewis D.
 Recorded 30 May 1785.

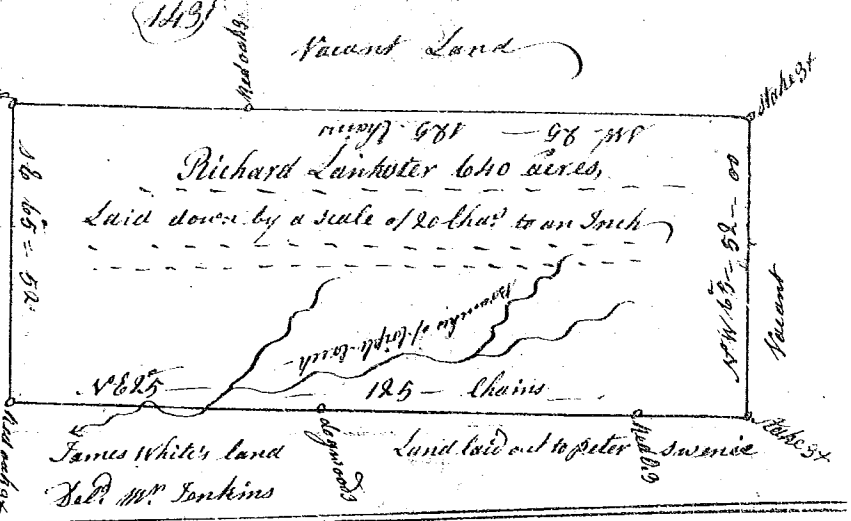

South Carolina Pursuant to a warrant from John Thomas Commissioner of locations for 96 district N. Saluda river, I have admeasured and laid out unto John Dyche a tract of land containing five hundred and fifty two acres, situate in the district of ninety six, on the rocky forke of the golden groue creek, branch of Saluda River, and hath such form and marks, buttings and boundings as the above plat represents, Survey, 15th April 1785,
 Lewis D.
 Recorded 30 May 1785.

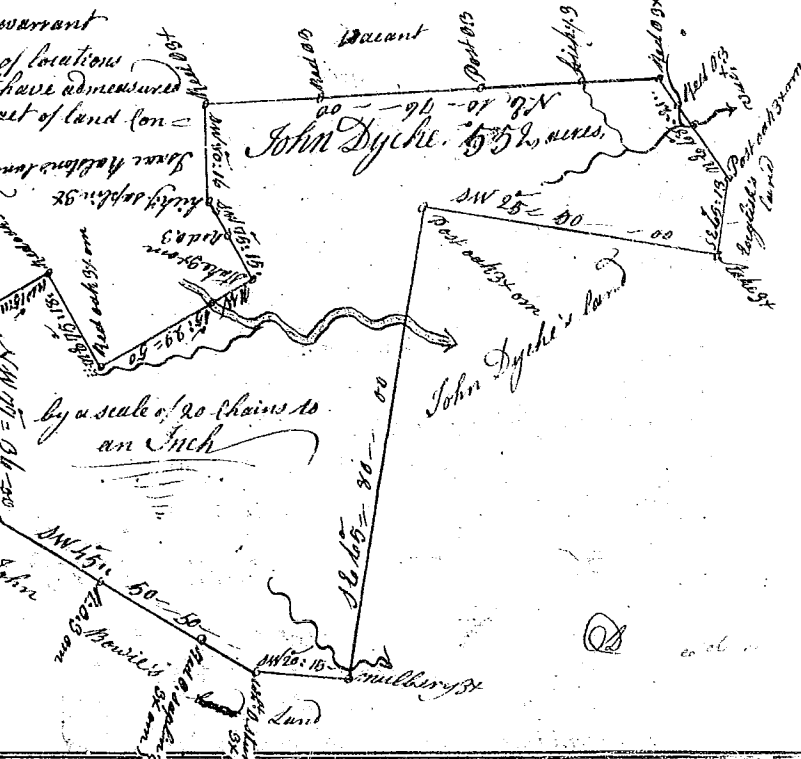

South Carolina, Pursuant to a warrant from John Thomas Commissioner of locations dated the 29th March, I have admeasured and laid out unto William Hogan a tract of land containing Two hundred and thirty seven acres, situate in the district of ninety six, on the waters of Meedy river, and hath such form and marks, buttings and boundings as the above plat represents, Survey, 2 April 1785,
 Lewis D.
 Recorded 31 May 1785.

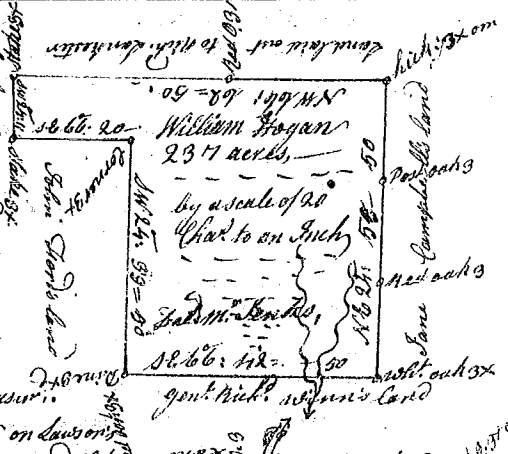

State of S Carolina Pursuant to a warrant from John Thomas Co. S for 96 district N. Saluda, I have admeasured and laid out unto W. Hogan a tract of 166 acres, in S. district on Lawson's fork of parolote river, and hath such form and marks, as the enclosed plat represents, Survey, 8 April 1785. by Thomas Lewis D.
 Recorded 31 May 1785.



South Carolina Pursuant to a warrant from John Thomas Co. S for 96 district N. Saluda, I have admeasured and laid out unto W. Hogan a tract of one hundred and sixty four acres, in said district on the waters of broad river on Bogans creek, and hath such form and marks, buttings and boundings as the above plat represents, Survey, the 4th April 1785. Lewis D.
 Recorded the 31 May 1785.

