

State of S^c Carolina 96 district West old boundary,
 Pursuant to warrant from John Thomas,
 Commissioner of locations dated the 11. March 1785,
 I have admeasured and laid out unto Richard
 Stanford a tract of four hundred and forty
 acres of land, on a branch of Gilders Creek
 waters of Snowe River, bounded on all sides
 by Vacant Land, and hath shape and marks
 as the above Plat Represents,

Survey: 14th April 1785,

Andrew Thomson D^s

Recorded 25th May 1785,

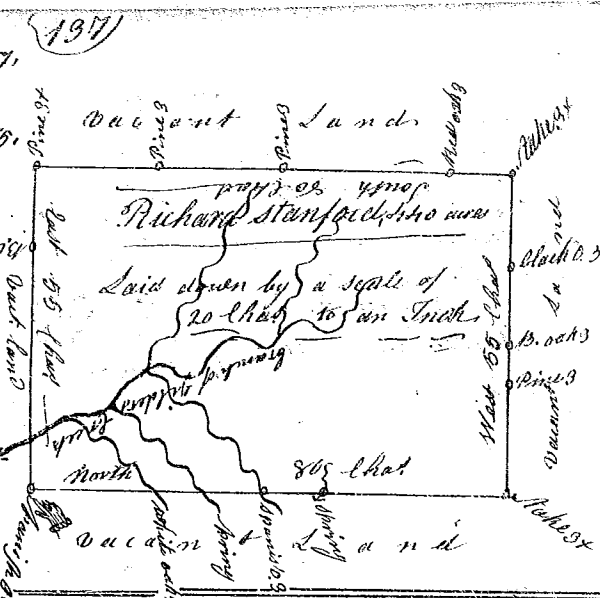

State of S^c Carolina 96 district West of the old boundary line,
 Pursuant to warrant from John Thomas Commissioner
 of locations dated the 25th February 1785 I have
 admeasured and laid out unto John Peck
 a tract of three hundred and Twenty acres
 of land, on the North side of Gilders
 Creek, on a small branch of said Creek,
 bounded N.W. by Sarah Roberts land and
 Joseph Sanders Land, S.E. by Churchwell
 Jackson's land, all other sides Vacant
 Land, and hath such shape and
 Marks as the above Plat Represents

Survey: 12th April 1785,

Andrew Thomson D^s

Recorded the 25th May 1785,

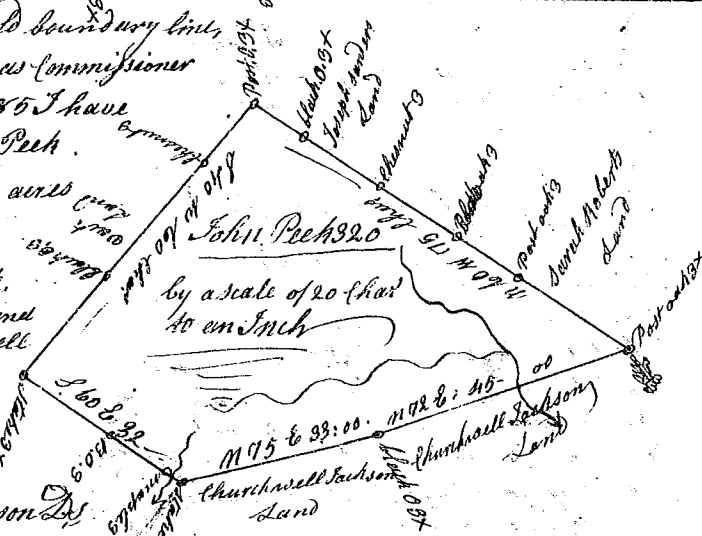

State of South Carolina 96 district West old boundary,
 Pursuant to warrant from John Thomas Com-
 missioner of locations dated the 19th March 1785,
 I have admeasured and laid out unto Moses Langley
 a tract of Two hundred acres of land, on the South
 side of Snowe River, on both sides of Rocky Creek
 bounded SW by said Moses Langley's land, all other
 sides Vacant Land, and hath such shape and Marks as
 the above Plat Represents, Survey: 11th April 1785-

Recorded the 25th May 1785,

Andrew Thomson D^s

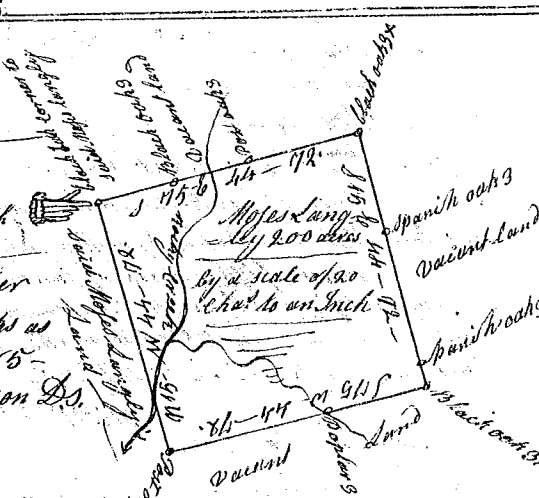

State of South Carolina 96 district East of the old boundary line,
 Pursuant to warrant from John Thomas Commissioner of locations
 dated 14th April 1785, I have admeasured and laid out unto
 David Pruett, a tract of one Hundred and Twenty acres, on both
 sides of Cutchmans Creek, in sight of Pruett's town, bounded
 N.W. by the said David Pruett's Land, all other sides by
 Vacant land, and hath such shape and Marks, as
 the above plat Represents, Survey: 2nd May 1785

Recorded the 25th May 1785,

Andrew Thomson D^s

